

HTE# 07-50018316

Harnett County Department of Public

Ith

24286

Improvement Permit

A building permit cannot be issued with only an Improvement Permit

ISSUED TO: LDS Homes PROPERTY LOCATION: NC27
 SUBDIVISION Laurel Valley LOT # 12
 NEW REPAIR EXPANSION
 Type of Structure: SFO - 45x59 - 3Dr
 Proposed Wastewater System Type: Pump to 25% Reduction system
 Projected Daily Flow: 360 GPD
 Number of bedrooms: 3 Number of Occupants: 6 max
 Basement Yes No
 Pump Required: Yes No May be required based on final location and elevations of facilities
 Type of Water Supply: Community Public Well Distance from well 50 feet
 Permit conditions: Meet on site maintain all set back, STUB out Plumbing where shown
 Permit valid for: Five years No expiration

Authorized State Agent: J. L. AM Date: 08-29-07 SEE ATTACHED SITE SKETCH
 The issuance of this permit by the Health Department in no way guarantees the issuance of other permits. The permit holder is responsible for checking with appropriate governing bodies in meeting their requirements. This site is subject to revocation if the site plan, plat, or the intended use changes. The Improvement Permit shall not be affected by a change in ownership of the site. This permit is subject to compliance with the provisions of the Laws and Rules for Sewage Treatment and Disposal and to conditions of this permit.

Construction Authorization

(Required for Building Permit)

The construction and installation requirements of Rules .1950, .1952, .1954, .1955, .1956, .1957, .1958, and .1959 are incorporated by references into this permit and shall be met. Systems shall be installed in accordance with the attached system layout.

ISSUED TO: LDS Homes PROPERTY LOCATION: NC27
 SUBDIVISION Laurel Valley LOT # 12
 Facility Type: SFO - 45x59 - 3BR New Expansion Repair
 Basement? Yes No Basement Fixtures? Yes No
 Type of Wastewater System** Pump to 25% Red. Sys. (Initial) Wastewater Flow: 360 GPD
 (See note below, if applicable
@ 180' 1 25% Red. system (Repair)

Installation Requirements/Conditions

Septic Tank Size 1000 gallons Exact length of each trench 1x180 feet Trench Spacing: 9 Feet on Center
 Pump Tank Size 1000 gallons Trenches shall be installed on contour at a Soil Cover: 6 inches
 Maximum Trench Depth of: 18.24 inches (Maximum soil cover shall not exceed 36" above the trench bottom)
 (Trench bottoms shall be level to +/- 1/4" in all directions)
 Pump Requirements: _____ ft. TDH vs. _____ GPM _____ inches below pipe
 Aggregate Depth: _____ inches above pipe
 Conditions: _____ inches total

**If applicable: *I understand the system type specified is different from the type specified on the application. I accept the specifications of this permit.*

Owner/Legal Representative Signature: _____ Date: _____

This Construction Authorization is subject to revocation if the site plan, plat, or the intended use changes. The Construction Authorization shall not be transferred when there is a change in ownership of the site. This Construction Authorization is subject to compliance with the provisions of the Laws and Rules for Sewage Treatment and Disposal and to the conditions of this permit.

Authorized State Agent: J. L. AM Date: 08-29-07 SEE ATTACHED SITE SKETCH
 Construction Authorization Expiration Date: 08-29-2012

HTE# 07-50018314

Permit # 24284

Harnett County Department of Public Health Site Sketch

ISSUED TO: LDS Homes PROPERTY LOCATOR: NC 27
SUBDIVISION: LAUREL VALLEY LOT # 12

Authorized State Agent: J. L. [Signature] Date: 08-29-07

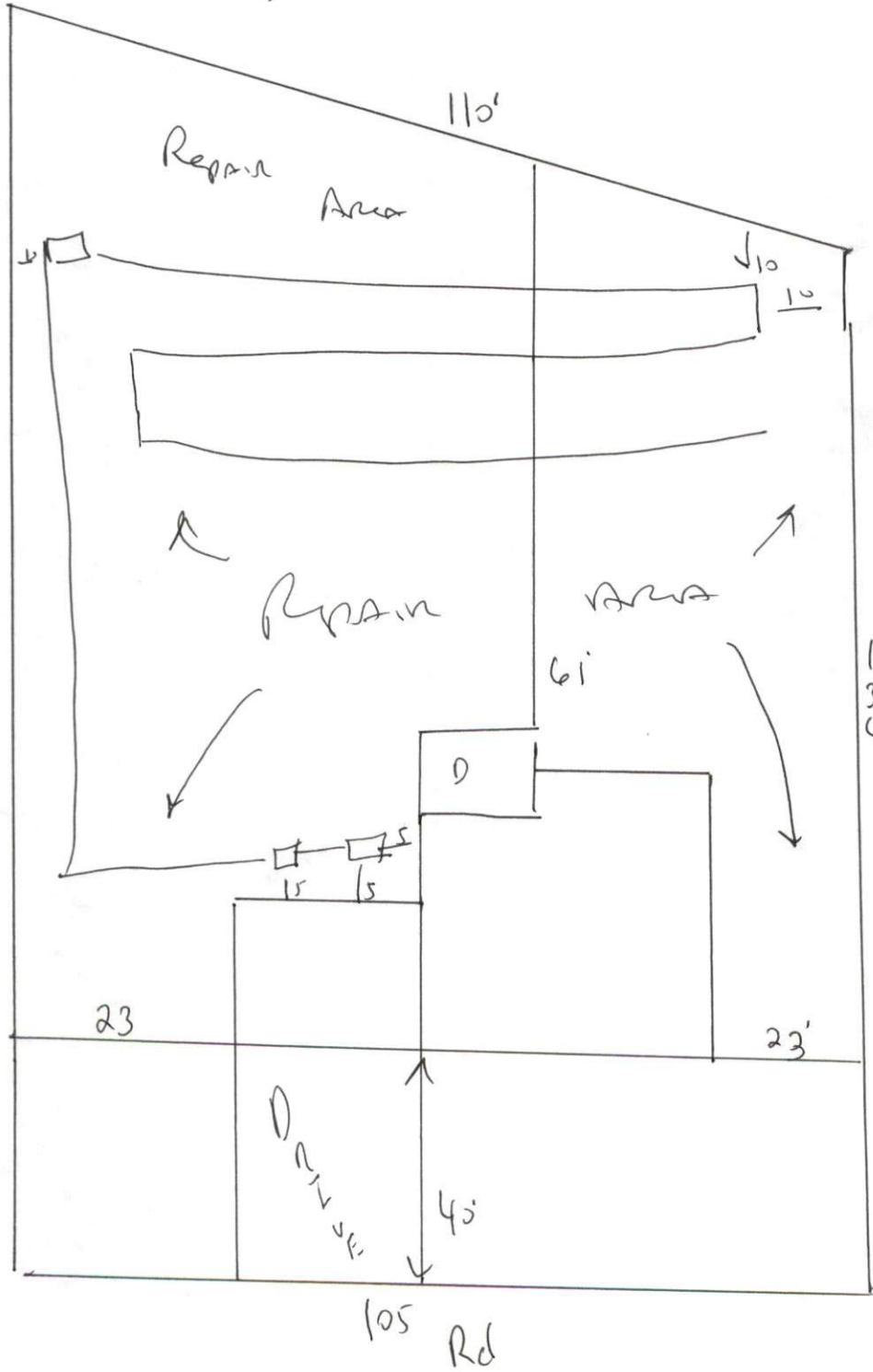

Meet onsite
 MAINTAIN ALL
 SETBACKS
 Install 1x180
 25% Reduction system
 At 18 to 24" deep