

HTE# 07-5-18249R

Harnett County Department of Public Health

24128

Improvement Permit

A building permit cannot be issued with only an Improvement Permit

ISSUED TO: Harold Cole Barber
PROPERTY LOCATION: SR 1566 Popeshak Rd
SUBDIVISION: Popes Lake LOT # 3
NEW [X] REPAIR [] EXPANSION []
Type of Structure: SFD 69'x50'
Proposed Wastewater System Type: Acceptai System w/pump
Projected Daily Flow: 360 GPD
Number of bedrooms: 3 Number of Occupants: 6 max
Basement [X] Yes [] No
Pump Required: [X] Yes [] No [] May be required based on final location and elevations of facilities
Type of Water Supply: [] Community [X] Public [] Well Distance from well _____ feet
Permit valid for: [X] Five years [] No expiration

Authorized State Agent: Bryan McSwain, R.S. Date: 10/1/2007 SEE ATTACHED SITE SKETCH
The issuance of this permit by the Health Department in no way guarantees the issuance of other permits. The permit holder is responsible for checking with appropriate governing bodies in meeting their requirements. This site is subject to revocation if the site plan, plat, or the intended use changes. The Improvement Permit shall not be affected by a change in ownership of the site. This permit is subject to compliance with the provisions of the Laws and Rules for Sewage Treatment and Disposal and to conditions of this permit.

Construction Authorization

(Required for Building Permit)

The construction and installation requirements of Rules .1950, .1952, .1954, .1955, .1956, .1957, .1958, and .1959 are incorporated by references into this permit and shall be met. Systems shall be installed in accordance with the attached system layout.

ISSUED TO: Harold Cole Barber
PROPERTY LOCATION: SR 1566
SUBDIVISION: Popes Lake LOT # 3
Facility Type: SFD 69'x50' [X] New [] Expansion [] Repair
Basement? [X] Yes [] No Basement Fixtures? [X] Yes [] No
Type of Wastewater System** Pump to Accepted System (Initial) Wastewater Flow: 360 GPD
(See note below, if applicable []) Accepted System (Repair)

Installation Requirements/Conditions

Septic Tank Size 1000 gallons Exact length of each trench 3x100 feet Trench Spacing: 9 Feet on Center
Pump Tank Size 1000 gallons Trenches shall be installed on contour at a Soil Cover: 6 inches
Maximum Trench Depth of: 12 inches (Maximum soil cover shall not exceed 36" above the trench bottom)
in all directions)
Pump Requirements: _____ ft. TDH vs. _____ GPM _____ inches below pipe
Aggregate Depth: _____ inches above pipe
Conditions: Run drainliner on contour & NO DEEPER than 12 inches
System will need 6 inches of cover. Well in front must be filled in

**If applicable: I understand the system type specified is different from the type specified on the application. I accept the specifications of this permit.
Owner/Legal Representative Signature: _____ Date: _____

This Construction Authorization is subject to revocation if the site plan, plat, or the intended use changes. The Construction Authorization shall not be transferred when there is a change in ownership of the site. This Construction Authorization is subject to compliance with the provisions of the Laws and Rules for Sewage Treatment and Disposal and to the conditions of this permit.

Authorized State Agent: Bryan McSwain, R.S. Date: 10/1/2007 SEE ATTACHED SITE SKETCH
Construction Authorization Expiration Date: 10/1/2012

HTE# 07-5-18249L

Permit # 24128

Harnett County Department of Public Health Site Sketch

ISSUED TO: Harold Cole Barnes PROPERTY LOCATOR: 521566 Popishake Rd.
SUBDIVISION: Popishake LOT # 3

Authorized State Agent: Roy McSwain R.S. Date: 10/1/2007

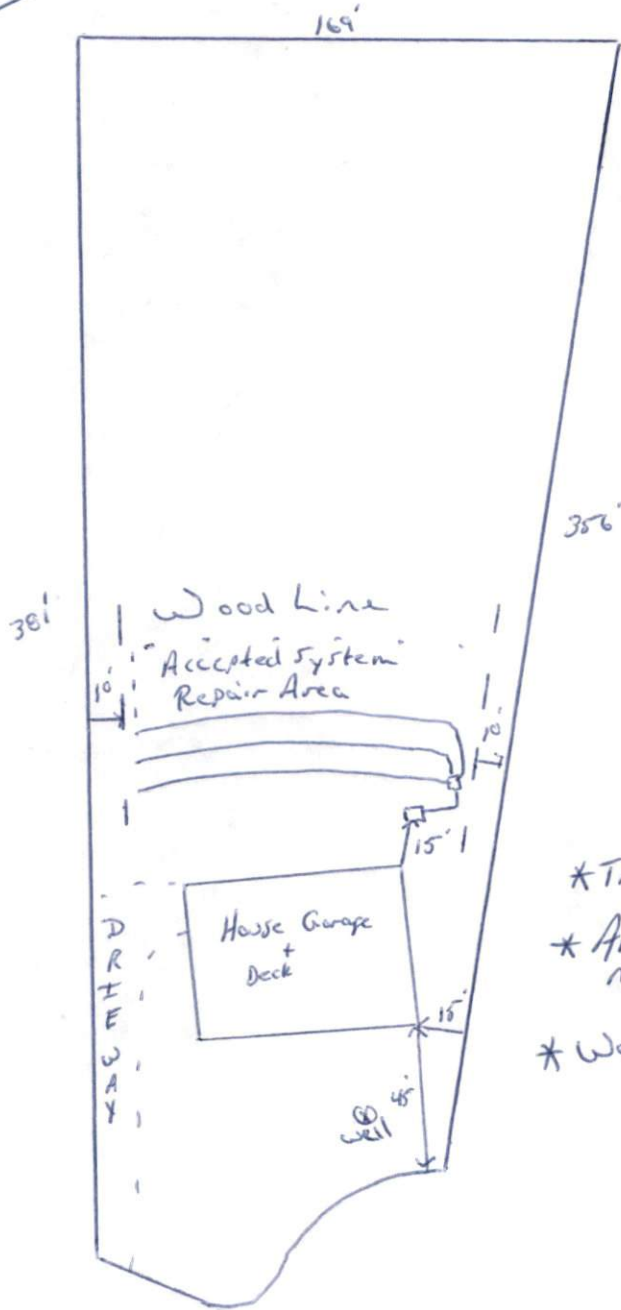

- * TANK must be 15 ft. away from house
- * Area for septic system must not be disturbed
- * Well must be filled in