

HTE# 07-500 18131

Harnett County Department of Public Health

24262

Improvement Permit

A building permit cannot be issued with only an Improvement Permit

ISSUED TO: ISRAEL LUCAS
PROPERTY LOCATION: 1141
SUBDIVISION: Sunset Ridge
LOT #: 151
Type of Structure: SFD-52x72 3BR
Proposed Wastewater System Type: 25% Reduction sys.
Projected Daily Flow: 360 GPD
Number of bedrooms: 3
Number of Occupants: 6 max
Basement: No
Pump Required: No
Type of Water Supply: Public
Distance from well: 50 feet
Permit valid for: Five years
Permit conditions: Stubout Plumbing shallow, at ground level or higher where shown

Authorized State Agent: J. Lan
Date: 08-10-09
SEE ATTACHED SITE SKETCH
The issuance of this permit by the Health Department in no way guarantees the issuance of other permits. The permit holder is responsible for checking with appropriate governing bodies in meeting their requirements. This site is subject to revocation if the site plan, plat, or the intended use changes. The Improvement Permit shall not be affected by a change in ownership of the site. This permit is subject to compliance with the provisions of the Laws and Rules for Sewage Treatment and Disposal and to conditions of this permit.

Construction Authorization

(Required for Building Permit)

The construction and installation requirements of Rules .1950, .1952, .1954, .1955, .1956, .1957, .1958, and .1959 are incorporated by references into this permit and shall be met. Systems shall be installed in accordance with the attached system layout.

ISSUED TO: ISRAEL LUCAS
PROPERTY LOCATION: 1141
SUBDIVISION: Sunset Ridge
LOT #: 151
Facility Type: SFD-52x72 3BR New
Basement? No
Type of Wastewater System: 25% Reduction sys. (Initial)
Wastewater Flow: 360 GPD
(See note below, if applicable) 290 LFA LPP (Repair)

Installation Requirements/Conditions

Septic Tank Size: 1000 gallons
Exact length of each trench: 1x180 feet
Trench Spacing: 9 feet on center
Pump Tank Size: _____ gallons
Trenches shall be installed on contour at a
Maximum Trench Depth of: 18.24 inches
(Pump Requirements: _____ ft. TDH vs. _____ GPM)
Aggregate Depth: _____ inches below pipe
Conditions: _____ inches above pipe
_____ inches total

**If applicable: I understand the system type specified is different from the type specified on the application. I accept the specifications of this permit.

Owner/Legal Representative Signature: _____ Date: _____

This Construction Authorization is subject to revocation if the site plan, plat, or the intended use changes. The Construction Authorization shall not be transferred when there is a change in ownership of the site. This Construction Authorization is subject to compliance with the provisions of the Laws and Rules for Sewage Treatment and Disposal and to the conditions of this permit.

Authorized State Agent: J. Lan
Date: 08/10/09
SEE ATTACHED SITE SKETCH
Construction Authorization Expiration Date: 08-10-2012

HTE# 07-50018131

Permit # 24262

Harnett County Department of Public Health Site Sketch

ISSUED TO: ISRAEL LUCA PROPERTY LOCATOR: 1141
SUBDIVISION: Sunset Ridge LOT # 151
Authorized State Agent: J. W. [Signature] Date: 08-10-07

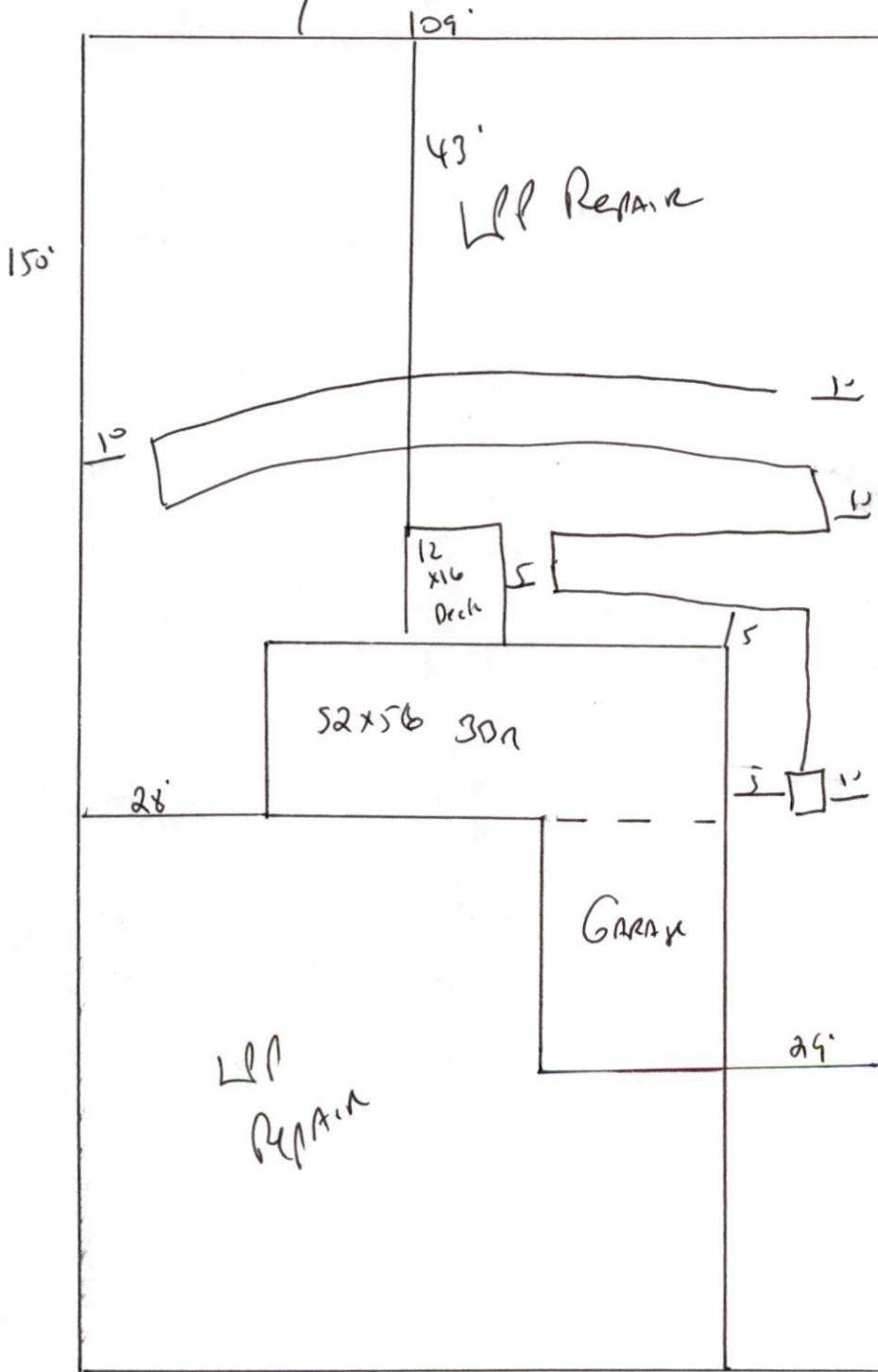

150'

STUBOUT Plumbing
Shallow AT ground
level or higher
where shown

maintain all
SETBACKS

2 1/2" TALL

1 x 180' of 25%
Reduction system

109' Road