

Improvement Permit

A building permit cannot be issued with only an Improvement Permit

ISSUED TO: Bog Dev. PROPERTY LOCATION: 1115
SUBDIVISION: CRESTVIEW LOT # 210

NEW REPAIR EXPANSION Site Improvements required prior to Construction Authorization Issuance:

Type of Structure: SFD-56x36 3BR

Proposed Wastewater System Type: Pumps 25% Reduction syst

Projected Daily Flow: 360 GPD

Number of bedrooms: 3 Number of Occupants: 6 max

Basement Yes No

Pump Required: Yes No May be required based on final location and elevations of facilities

Type of Water Supply: Community Public Well Distance from well 50 feet Permit valid for: Five years

Permit conditions: STUB at plumbing shallow where shown, at ground level or higher & pump may not be required. Meet onsite maintain All set back No expiration

Authorized State Agent: [Signature] Date: 8-21-07 SEE ATTACHED SITE SKETCH

The issuance of this permit by the Health Department in no way guarantees the issuance of other permits. The permit holder is responsible for checking with appropriate governing bodies in meeting their requirements. This site is subject to revocation if the site plan, plat, or the intended use changes. The Improvement Permit shall not be affected by a change in ownership of the site. This permit is subject to compliance with the provisions of the Laws and Rules for Sewage Treatment and Disposal and to conditions of this permit.

Construction Authorization

(Required for Building Permit)

The construction and installation requirements of Rules .1950, .1952, .1954, .1955, .1956, .1957, .1958, and .1959 are incorporated by references into this permit and shall be met. Systems shall be installed in accordance with the attached system layout.

ISSUED TO: Bog Dev. PROPERTY LOCATION: 1115
SUBDIVISION: CRESTVIEW LOT # 210

Facility Type: SFD-56x36-3BR New Expansion Repair

Basement? Yes No Basement Fixtures? Yes No

Type of Wastewater System** Pumps 25% Red. Syst. (Initial) Wastewater Flow: 360 GPD

(See note below, if applicable) 480 LF of LRP (Repair)

Installation Requirements/Conditions

Septic Tank Size 1000 gallons Exact length of each trench 1x300 feet Trench Spacing: 9 Feet on Center

Pump Tank Size 1000 gallons Trenches shall be installed on contour at a Soil Cover: 6 inches

Maximum Trench Depth of: 18 inches (Maximum soil cover shall not exceed 36" above the trench bottom)

(Trench bottoms shall be level to +/-1/4" in all directions)

Pump Requirements: _____ ft. TDH vs. _____ GPM _____ inches below pipe

Aggregate Depth: _____ inches above pipe

Conditions: _____ inches total

**If applicable: *I understand the system type specified is different from the type specified on the application. I accept the specifications of this permit.*

Owner/Legal Representative Signature: _____ Date: _____

This Construction Authorization is subject to revocation if the site plan, plat, or the intended use changes. The Construction Authorization shall not be transferred when there is a change in ownership of the site. This Construction Authorization is subject to compliance with the provisions of the Laws and Rules for Sewage Treatment and Disposal and to the conditions of this permit.

Authorized State Agent: [Signature] Date: 08-21-07 SEE ATTACHED SITE SKETCH

Construction Authorization Expiration Date: 08-21-2012

HTE# 07-500180902

Permit # 24272

Harnett County Department of Public Health Site Sketch

ISSUED TO: B96 Dev.

PROPERTY LOCATOR: 1115
SUBDIVISION: CRESTRICK

LOT # 210

Authorized State Agent: Joe Liles

Date: 08.21.07

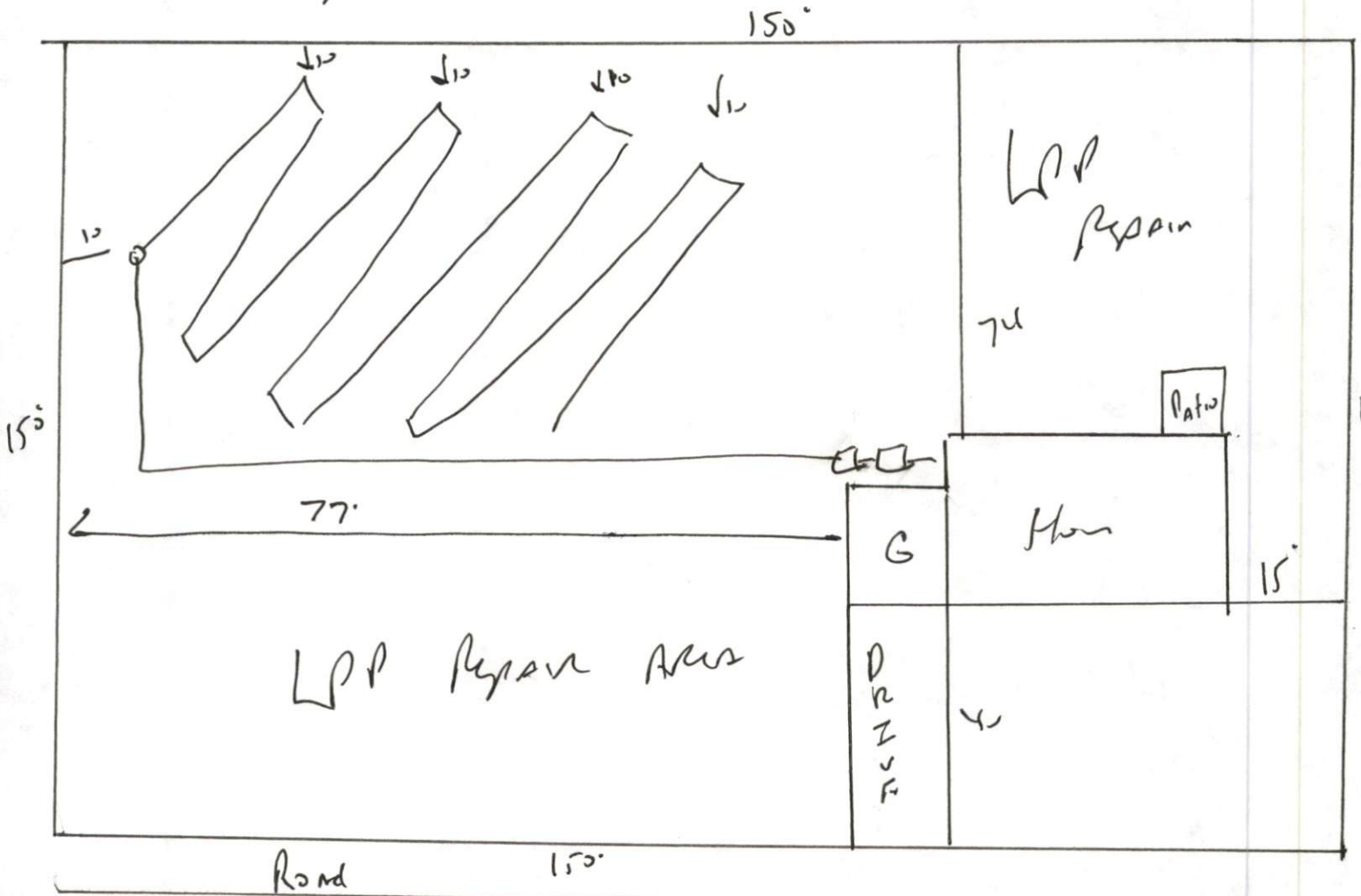

Meet onsite maintain all set backs

Stub out Plumbing shallow, at ground level or higher
And if 18" ditch depth can be maintained then pump
will not be required. Install 1x300 of 25% Reduction
System At 18"

