

HTE# 07-50018051

Harrison County Department of Public Health

24256

Improvement Permit

A building permit cannot be issued with only an Improvement Permit

ISSUED TO: Cumberland Homes PROPERTY LOCATION: 1116 SUBDIVISION: CRITCHEL LOT # 249

NEW [X] REPAIR [ ] EXPANSION [ ] Type of Structure: SFD - 54x45 3BR Proposed Wastewater System Type: Pump to 25% Reduction Site Projected Daily Flow: 360 GPD Number of bedrooms: 3 Number of Occupants: 6 max

Basement [ ] Yes [X] No Pump Required: [X] Yes [ ] No [ ] May be required based on final location and elevations of facilities Type of Water Supply: [ ] Community [X] Public [ ] Well Distance from well: 50 feet Permit valid for: [X] Five years [ ] No expiration

STUB out Plumbing shallow at ground level or higher where shown in plan. It is to be a 4" pipe. Depth can be maintained then pump may not be required. Authorized State Agent: J. LAM Date: 07-27-07 SEE ATTACHED SITE SKETCH

The issuance of this permit by the Health Department in no way guarantees the issuance of other permits. The permit holder is responsible for checking with appropriate governing bodies in meeting their requirements. This site is subject to revocation if the site plan, plat, or the intended use changes. The Improvement Permit shall not be affected by a change in ownership of the site. This permit is subject to compliance with the provisions of the Laws and Rules for Sewage Treatment and Disposal and to conditions of this permit.

Construction Authorization

(Required for Building Permit)

The construction and installation requirements of Rules .1950, .1952, .1954, .1955, .1956, .1957, .1958, and .1959 are incorporated by references into this permit and shall be met. Systems shall be installed in accordance with the attached system layout.

ISSUED TO: Cumberland Homes PROPERTY LOCATION: 1116 SUBDIVISION: CRITCHEL LOT # 249

Facility Type: SFD - 54x45 3BR [X] New [ ] Expansion [ ] Repair Basement? [ ] Yes [X] No Basement Fixtures? [ ] Yes [X] No Type of Wastewater System\*\* Pump to 25% Red. Site (Initial) Wastewater Flow: 360 GPD (See note below, if applicable [X]) 250 LF of LPP (Repair)

Installation Requirements/Conditions

Septic Tank Size 1000 gallons Exact length of each trench 1x180 feet Trench Spacing: 9 Feet on Center Pump Tank Size 1000 gallons Trenches shall be installed on contour at a Soil Cover: 6 inches Maximum Trench Depth of: 19.24 inches (Maximum soil cover shall not exceed 36" above the trench bottom) (Trench bottoms shall be level to +/- 1/4" in all directions) Pump Requirements: \_\_\_\_\_ ft. TDH vs. \_\_\_\_\_ GPM Aggregate Depth: \_\_\_\_\_ inches below pipe \_\_\_\_\_ inches above pipe \_\_\_\_\_ inches total Conditions: \_\_\_\_\_

\*\*If applicable: I understand the system type specified is different from the type specified on the application. I accept the specifications of this permit.

Owner/Legal Representative Signature: \_\_\_\_\_ Date: \_\_\_\_\_

This Construction Authorization is subject to revocation if the site plan, plat, or the intended use changes. The Construction Authorization shall not be transferred when there is a change in ownership of the site. This Construction Authorization is subject to compliance with the provisions of the Laws and Rules for Sewage Treatment and Disposal and to the conditions of this permit.

Authorized State Agent: J. LAM Date: 07-27-07 SEE ATTACHED SITE SKETCH Construction Authorization Expiration Date: 07-27-2012

HTE# 07-50018051

Permit # 24256

# Harnett County Department of Public Health Site Sketch

ISSUED TO: Cumberland Home PROPERTY LOCATOR: 1114  
SUBDIVISION: Crestview LOT # 242

Authorized State Agent: J. Lam Date: 07-27-07

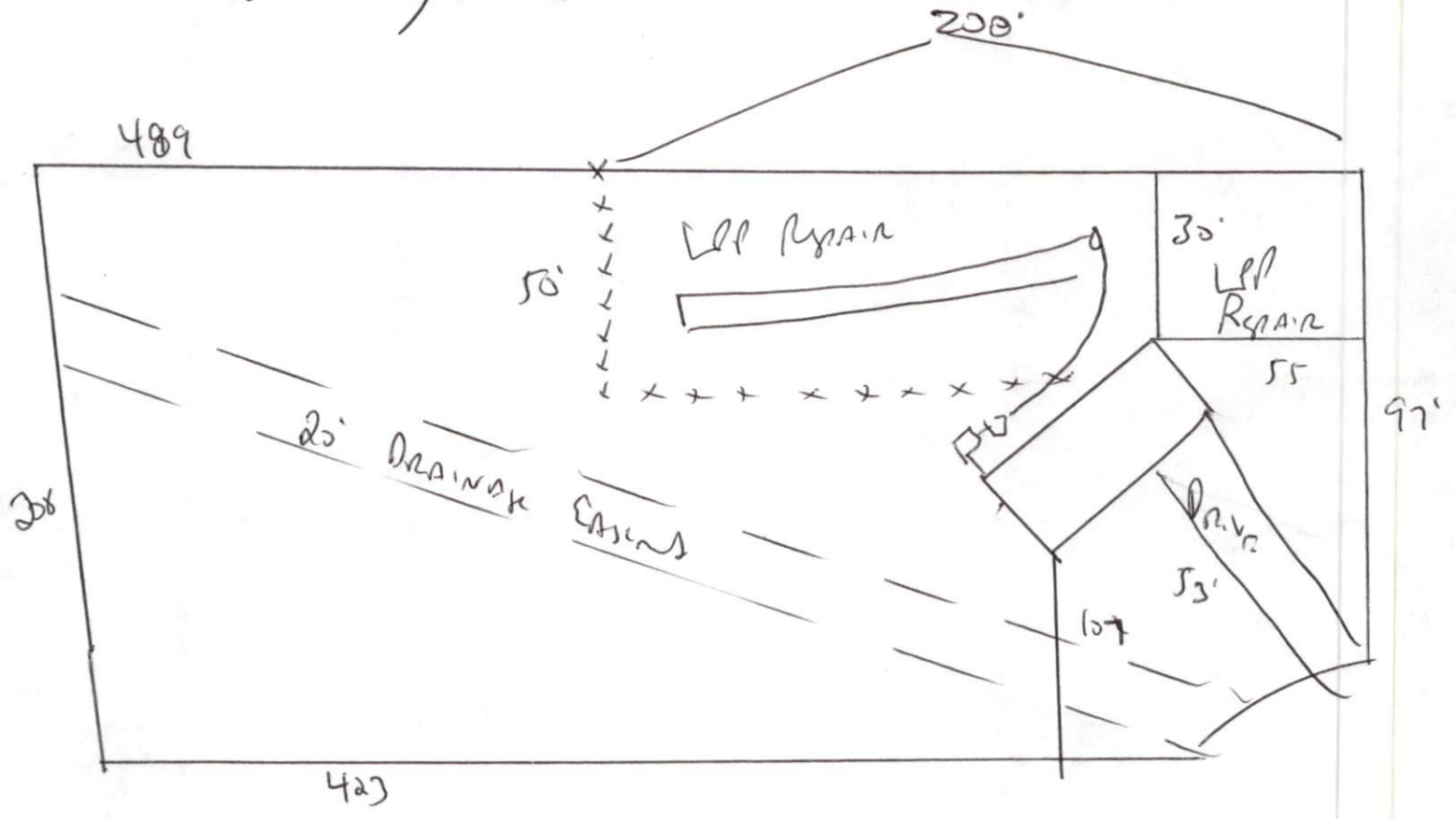

Meet onsite for Final layout  
 Maintain All setbacks  
 In stall 1x180 125% Reduction system