



July 16, 2007

Cumberland Homes
P O Box 727
Dunn, NC 28334

Harnett County Government Complex
307 Cornelius Harnett Boulevard
Lillington, NC 27546

ph: 910-893-7550
fax: 910-893-9429

**RE: Harnett County Land Use Application HTE# 07-5-17983 Lt#254 Crestview Est.
THE# 07-5-17982 Lt#253 Crestview Est.**

To Whom It May Concern:

On June 5, 2005 an attempt was made to evaluate your property for the purpose of issuing an Improvement Permit. The evaluation could not be completed for one or more of the following reasons.

- 1. Property lines/corners not marked or labeled
- 2. House corners not marked or labeled
- 3. Directions not clear to property
- 4. Property needs brush or vegetation removed
- 5. Backhoe pits required
- 6. Other *Please move house location as shown on attached sheet and submit new plot plan with changes to Central Permitting.*

Your application will be put on hold until the selected items above have been addressed. When completed please call 910-893-7527 to confirm that the items mentioned have been corrected, we will then reschedule your property for evaluation.

Sincerely,

Joe West, R.S.
Environmental Health Specialist
Harnett County Department of Public Health
Environmental Health

JW/sgw

Copy: Central Permitting

Road

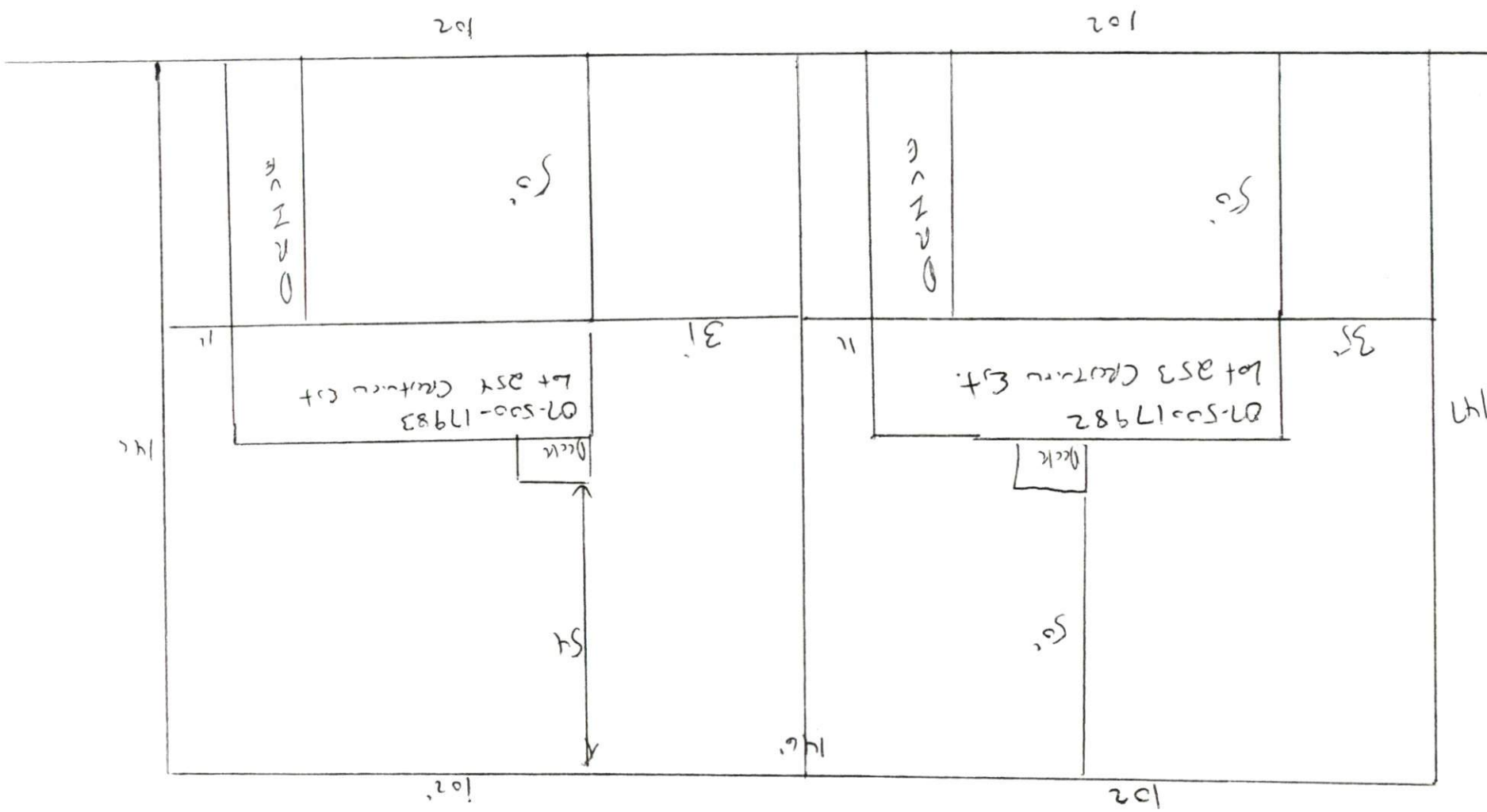

Lot 254 Creation Est.
 07-500-17983
 NTS

Lot 253 Creation Est.
 07-500-17982
 WTS