

Initial Application Date: 6/25/07

Application # 0750017892

COUNTY OF HARNETT LAND USE APPLICATION

Central Permitting 102 E. Front Street, Lillington, NC 27546 Phone: (910) 893-4759 Fax: (910) 893-2793 www.harnett.org

LANDOWNER: Cucin Builders Inc. Mailing Address: 6390 Wimbaly Rd

City: Willow Spring, N.C. State: N.C. Zip: 27590 Phone #: 919-639-6989

APPLICANT: Same Mailing Address: _____

City: _____ State: _____ Zip: _____ Phone #: _____

PROPERTY LOCATION: SR #: 1429 SR Name: Chalybeate Rd.

Address: _____

Parcel: 0806530030 40 PIN: 00053-38-0265.000

Zoning: RA30 Subdivision: Dexter Field Lot #: 40 Lot Size: .45

Flood Plain: None Panel: 615PAN Watershed: IV Deed Book/Page: 2392/808 Plat Book/Page: 2006/1144

DIRECTIONS TO THE PROPERTY FROM LILLINGTON: 401 N. to Chalybeate Rd. Turn left, Right in Dexter Field to the end of street & turn right - then left on Sweet - lot 40 in the right

PROPOSED USE:

- SFD (Size 60 x 52) # Bedrooms 3 # Baths 2 Basement (w/w/o bath) N/A Garage Deck Crawl Space Slab
- Multi-Family Dwelling No. Units _____ No. Bedrooms/Unit _____
- Manufactured Home (Size _____ x _____) # of Bedrooms _____ Garage _____ Deck _____
- Number of persons per household _____
- Business Sq. Ft. Retail Space _____ Type _____
- Industry Sq. Ft. _____ Type _____
- Church Seating Capacity _____ Kitchen _____
- Home Occupation (Size _____ x _____) # Rooms _____ Use _____
- Additional Information: _____
- Accessory Building (Size _____ x _____) Use _____
- Addition to Existing Building (Size _____ x _____) Use _____
- Other _____

Additional Information: _____

Water Supply: County Well (No. dwellings _____) Other _____ Environmental Health Site Visit Date: _____

Sewage Supply: New Septic Tank Existing Septic Tank County Sewer Other _____

Erosion & Sedimentation Control Plan Required? YES NO

Property owner of this tract of land own land that contains a manufactured home w/in five hundred feet (500') of tract listed above? YES NO

Structures on this tract of land: Single family dwellings 4 proposed Manufactured homes _____ Other (specify) _____

Required Residential Property Line Setbacks:	Minimum	Actual
Front	35	40
Rear	25	104
Side	10	30/10
Corner	20	
Nearest Building	10	

If permits are granted I agree to conform to all ordinances and the laws of the State of North Carolina regulating such work and the specifications or plans submitted. I hereby swear that the foregoing statements are accurate and correct to the best of my knowledge.

Edward Cucin
Signature of Owner or Owner's Agent

6-25-07
Date

****This application expires 6 months from the initial date if no permits have been issued****

A RECORDED SURVEY PLAT AND RECORDED DEED ARE REQUIRED WHEN APPLYING FOR A LAND USE APPLICATION

1=30

SITE PLAN APPROVAL

DISTRICT RA30 USE SFD

#BEDROOMS 3

Date 6/25/07

Zoning Administrator

[Handwritten Signature]

06'33"E

300

100.00'

0.472 ac.

104

12'

205.96'

07'17.41"E

40

205.22'

Drive

10.5

30

12'

100.00'

OWNER NAME: Craig Builders Inc.

APPLICATION #: 0750017892

This application to be filled out only when applying for a new septic system.

County Health Department Application for Improvement Permit and/or Authorization to Construct

IF THE INFORMATION IN THIS APPLICATION IS FALSIFIED, CHANGED, OR THE SITE IS ALTERED, THEN THE IMPROVEMENT PERMIT OR AUTHORIZATION TO CONSTRUCT SHALL BECOME INVALID. The permit is valid for either 60 months or without expiration depending upon documentation submitted. (complete site plan = 60 months; complete plat = without expiration)

DEVELOPMENT INFORMATION

- New single family residence
- Expansion of existing system
- Repair to malfunctioning sewage disposal system
- Non-residential type of structure

WATER SUPPLY

- New well
- Existing well
- Community well
- Public water
- Spring

Are there any existing wells, springs, or existing waterlines on this property?

yes no unknown

SEPTIC

If applying for authorization to construct please indicate desired system type(s): can be ranked in order of preference, must choose one.

- Accepted Innovative
- Alternative Other _____
- Conventional Any

The applicant shall notify the local health department upon submittal of this application if any of the following apply to the property in question. If the answer is "yes", applicant must attach supporting documentation.

- YES NO Does the site contain any Jurisdictional Wetlands?
- YES NO Does the site contain any existing Wastewater Systems?
- YES NO Is any wastewater going to be generated on the site other than domestic sewage?
- YES NO Is the site subject to approval by any other Public Agency?
- YES NO Are there any easements or Right of Ways on this property?
- YES NO Does the site contain any existing water, cable, phone or underground electric lines?

If yes please call No Cuts at 800-632-4949 to locate the lines. This is a free service.

I Have Read This Application And Certify That The Information Provided Herein Is True, Complete And Correct. Authorized County And State Officials Are Granted Right Of Entry To Conduct Necessary Inspections To Determine Compliance With Applicable Laws And Rules. I Understand That I Am Solely Responsible For The Proper Identification And Labeling Of All Property Lines And Corners And Making The Site Accessible So That A Complete Site Evaluation Can Be Performed.

Edward V. Curin
PROPERTY OWNERS OR OWNERS LEGAL REPRESENTATIVE SIGNATURE (REQUIRED)

6-25-07
DATE

Harnett County Central Permitting DepartmentPO Box 65, Lillington, NC 27546
910-893-7525 **Environmental Health New Septic Systems Test****Environmental Health Code 800**

- Place "property flags" on each corner iron of lot. All property lines must be clearly flagged approximately every 50 feet between corners.
- Place "house corner flags" at each corner of where the house/manufactured home will sit. Use additional flagging to outline driveways, garages, decks, out buildings, swimming pools, etc.
- Place flags at locations as developed on site plan by Customer Service Technician and you.
- Place Environmental Health "orange" card in location that is easily viewed from road.
- If property is thickly wooded, Environmental Health requires that you clean out the undergrowth to allow the soil evaluation to be performed. Inspectors should be able to walk freely around site. *No grading of property should be done.*
- Call No Cuts to locate utility lines prior to scheduling inspection. 800-632-4949 (This is a free service)
- After preparing proposed site call the voice permitting system at 910-893-7525 and give code **800** for Environmental Health confirmation. **Please note confirmation number given at end of recording for proof of request.**
- Use Click2Gov or IVR to hear results. Once approved, proceed to Central Permitting for permits.

 Environmental Health Existing Tank Inspections**Environmental Health Code 800**

- Place Environmental Health "orange" card in location that is easily viewed from road. Follow above instructions for placing flags on property.
- Prepare for inspection by removing soil over door as diagram indicates. Loosen trap door cover. (Unless inspection is for a septic tank in a mobile home park)
- After preparing trapdoor call the voice permitting system at 910-893-7525 and give code **800** for Environmental Health confirmation. **Please note confirmation number given at end of recording for proof of request.**
- Use Click2Gov or IVR to hear results. Once approved, proceed to Central Permitting for remaining permits.

 Health and Sanitation Inspections

- After submitting plans for food and lodging to Central Permitting, please allow approximately 7-10 working days for plan status. Use Click2Gov or IVR to hear results.
- Once **all** plans are approved, proceed to Central Permitting for remaining permits.

 Fire Marshal Inspections

- After submitting plans for Fire Marshal review to Central Permitting, please allow approximately 7-10 working days for approval. Use Click2Gov or IVR to hear results. Once **all** plans are approved, proceed to Central Permitting for permits. Fire Marshal's letter must be placed on job site until work is completed.

 Public Utilities

- Place stake with "orange" tape/name thirty feet (30) from the center of the road at the location you wish to have water tap installed.
- Allow four to six weeks after application for water/sewer taps. Call Utilities at 893-7575 for technical assistance.

 Building Inspections

- After submitting plans for Building Inspections, please allow approximately 3 working days for review. Use Click2Gov or IVR to hear results. Once **all** plans are approved, proceed to Central Permitting for permits.
- For new housing/set up permits must meet E 911 / Addressing guidelines prior to scheduling final inspection.
- Use Click2Gov or IVR to hear results.

 E911 Addressing**Addressing Confirmation Code 814**

- Address numbers shall be mounted on the house, 3 inches high (5" for commercial).
- Numbers must be a contrasting color from house, must be clearly visible night and day at entrance of driveway if home is 100 ft or more from road, or if mailbox is on opposite side of road.
- Once you purchase permits and footing inspection has been approved call the voice permitting system at 910-893-7525 and give code **814** for address confirmation. This must be called in even if you have contacted E911 for verbal confirmation. Check Click2Gov for results and address.
- **Inspection results can be viewed online at <http://www.harnett.org/services-213.asp> then select Click2Gov**

Applicant/Owner Signature

Edward V. Curran

Date

6-25-07

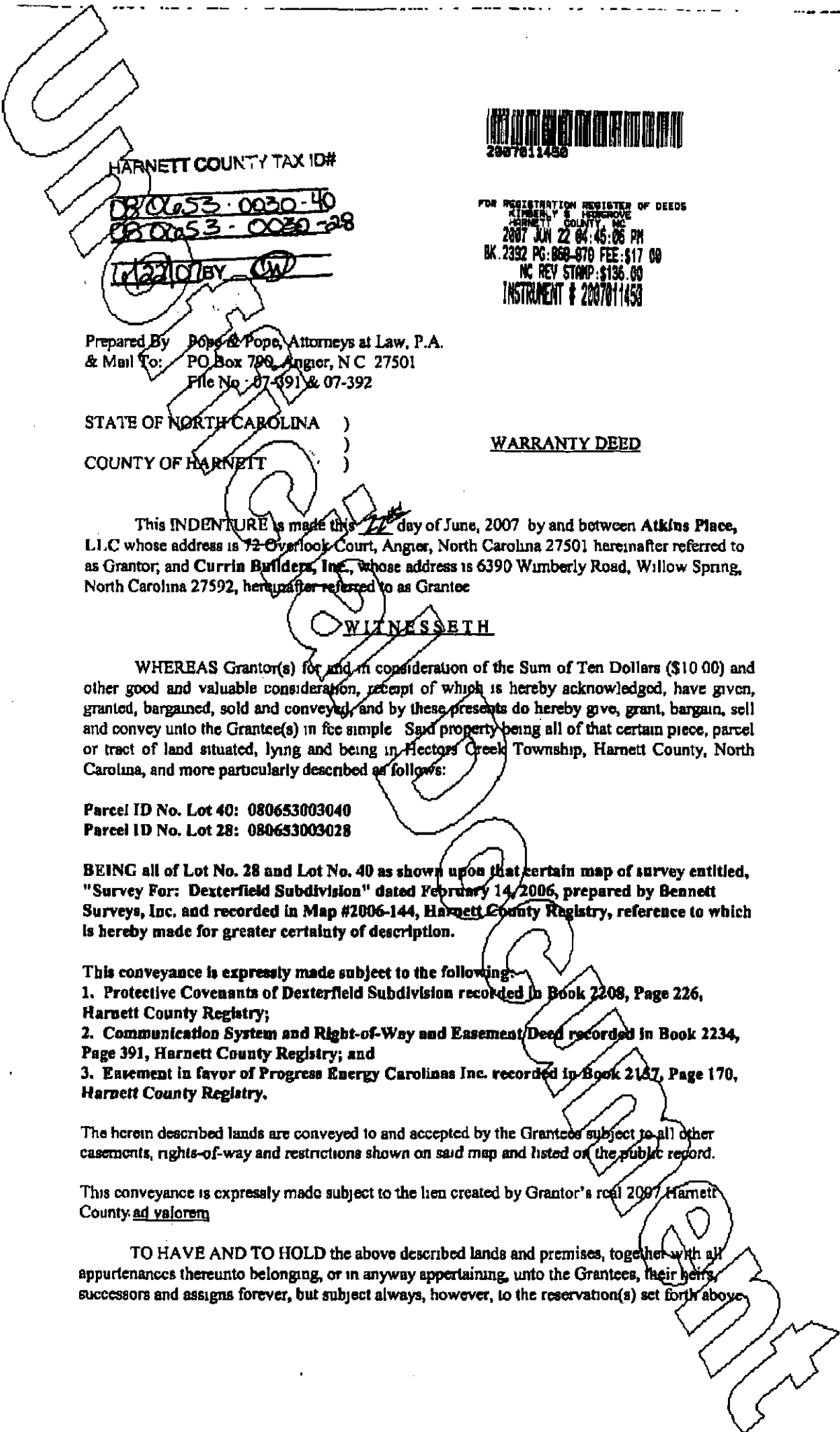

HARNETT COUNTY TAX ID#

080653-0030-40
080653-0030-28

6/22/07 BY CW

FOR REGISTRATION REGISTER OF DEEDS
ATKINS & HENNING
HARNETT COUNTY, NC
2007 JUN 22 04:45:06 PM
BK. 2392 PG. 060-070 FEE: \$17.00
NC REV STAMP: \$136.00
INSTRUMENT # 2007011458

Prepared By Pope & Pope, Attorneys at Law, P.A.
& Mail To: PO Box 790, Angier, NC 27501
File No: 07-391 & 07-392

STATE OF NORTH CAROLINA)
COUNTY OF HARNETT)

WARRANTY DEED

This INDENTURE is made this ~~12~~ day of June, 2007 by and between Atkins Place, LLC whose address is 72 Overlook Court, Angier, North Carolina 27501 hereinafter referred to as Grantor; and Curran Builders, Inc., whose address is 6390 Wumberly Road, Willow Spring, North Carolina 27592, hereinafter referred to as Grantee

WITNESSETH

WHEREAS Grantor(s) for and in consideration of the Sum of Ten Dollars (\$10.00) and other good and valuable consideration, receipt of which is hereby acknowledged, have given, granted, bargained, sold and conveyed, and by these presents do hereby give, grant, bargain, sell and convey unto the Grantee(s) in fee simple. Said property being all of that certain piece, parcel or tract of land situated, lying and being in Hectors Creek Township, Harnett County, North Carolina, and more particularly described as follows:

Parcel ID No. Lot 40: 080653003040
Parcel ID No. Lot 28: 080653003028

BEING all of Lot No. 28 and Lot No. 40 as shown upon that certain map of survey entitled, "Survey For: Dexterfield Subdivision" dated February 14, 2006, prepared by Bennett Surveys, Inc. and recorded in Map #2006-144, Harnett County Registry, reference to which is hereby made for greater certainty of description.

This conveyance is expressly made subject to the following:

1. Protective Covenants of Dexterfield Subdivision recorded in Book 2208, Page 226, Harnett County Registry;
2. Communication System and Right-of-Way and Easement/Deed recorded in Book 2234, Page 391, Harnett County Registry; and
3. Easement in favor of Progress Energy Carolinas Inc. recorded in Book 2157, Page 170, Harnett County Registry.

The herein described lands are conveyed to and accepted by the Grantee(s) subject to all other easements, rights-of-way and restrictions shown on said map and listed on the public record.

This conveyance is expressly made subject to the lien created by Grantor's real 2007 Harnett County ad valorem

TO HAVE AND TO HOLD the above described lands and premises, together with all appurtenances thereunto belonging, or in anyway appertaining, unto the Grantee(s), their heirs, successors and assigns forever, but subject always, however, to the reservation(s) set forth above.