

HTE# 07-500 17629

Harnett County Department of Public Health

23933

Improvement Permit

A building permit cannot be issued with only an Improvement Permit

ISSUED TO: SJK Home; PROPERTY LOCATION: NC27; SUBDIVISION: Laurel Valley; LOT # 44; Type of Structure: SFD-54x63 3 BR; Proposed Wastewater System Type: 25% Reduction system; Projected Daily Flow: 360 GPD; Number of bedrooms: 3; Number of Occupants: 6 max; Basement: No; Pump Required: Yes; Type of Water Supply: Public; Permit conditions: meet onsite before installing - maintain all set back

Authorized State Agent: J. Lami; Date: 6-4-07; SEE ATTACHED SITE SKETCH; The issuance of this permit by the Health Department in no way guarantees the issuance of other permits.

Construction Authorization

(Required for Building Permit)

The construction and installation requirements of Rules .1950, .1952, .1954, .1955, .1956, .1957, .1958, and .1959 are incorporated by references into this permit and shall be met.

ISSUED TO: SJK Home; PROPERTY LOCATION: NC27; SUBDIVISION: Laurel Valley; LOT # 44; Facility Type: SFD-54x63 3 BR; Basement: No; Type of Wastewater System: Pump to 25% Red. ST; Wastewater Flow: 360 GPD; 480 LF of LPP Repair (Repair)

Installation Requirements/Conditions

Septic Tank Size: 1000 gallons; Pump Tank Size: 1000 gallons; Exact length of each trench: 12300 feet; Trench Spacing: 09 Feet on Center; Soil Cover: 6 inches; Maximum Trench Depth of: 18 inches; Pump Requirements: ft. TDH vs. GPM; Aggregate Depth: inches above pipe; inches total

**If applicable: I understand the system type specified is different from the type specified on the application. I accept the specifications of this permit.

Owner/Legal Representative Signature: Date:

This Construction Authorization is subject to revocation if the site plan, plat, or the intended use changes. The Construction Authorization shall not be transferred when there is a change in ownership of the site.

Authorized State Agent: J. Lami; Date: 6-4-07; Construction Authorization Expiration Date: 6-4-2012; SEE ATTACHED SITE SKETCH

HTE# 07-50017629

Permit # 23932

Harnett County Department of Public Health Site Sketch

ISSUED TO: Srk Home

PROPERTY LOCATOR: NC27

SUBDIVISION LAUREL VALLEY

LOT # 44

Authorized State Agent: J. L. ...

Date: 6-4-07

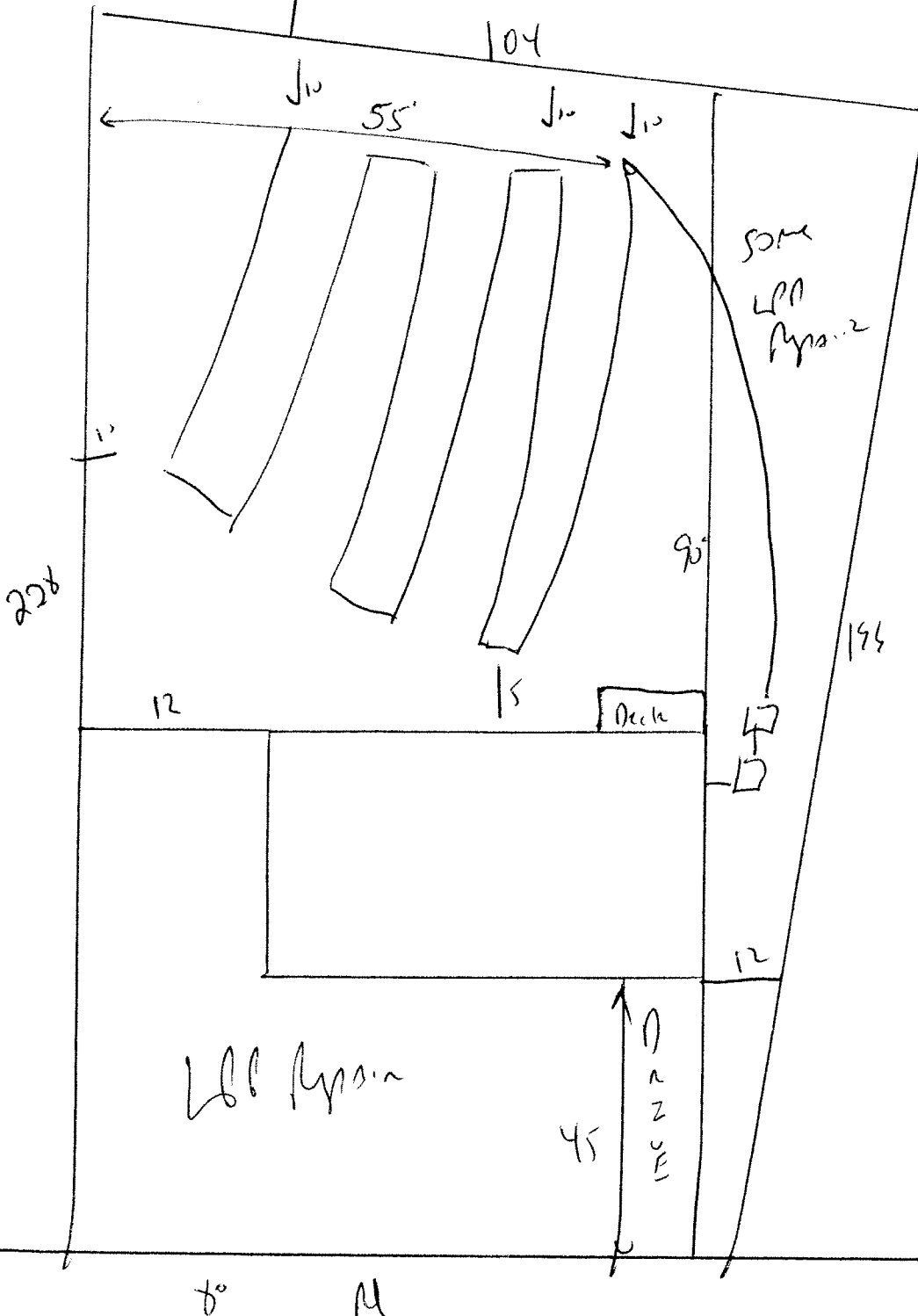

Meet onsite
for Final Layout
Maintain all
Setbacks
Install 1x200
25% Reduction
SYSTEM AT
18" max Pitch
Systems.