

HT# 07-5-17624

# Harrison County Department of Public Health

23960

## Improvement Permit

A building permit cannot be issued with only an Improvement Permit

ISSUED TO: Beltwell Homes Inc PROPERTY LOCATION: SR 1429 CHALYBEATE RD  
 NEW  REPAIR  EXPANSION  SUBDIVISION: DESTERFIELD LOT # 57  
 Type of Structure: SFD Site Improvements required prior to Construction Authorization Issuance:  
 Proposed Wastewater System Type: 25% REDUCTION System  
 Projected Daily Flow: 360 GPD  
 Number of bedrooms: 3 Number of Occupants: 6 max  
 Basement  Yes  No  
 Pump Required:  Yes  No  May be required based on final location and elevations of facilities  
 Type of Water Supply:  Community  Public  Well Distance from well \_\_\_\_\_ feet Permit valid for:  Five years  
 Permit conditions: \_\_\_\_\_  No expiration

Authorized State Agent: James Manhattan Date: 6-8-07 SEE ATTACHED SITE SKETCH  
 The issuance of this permit by the Health Department in no way guarantees the issuance of other permits. The permit holder is responsible for checking with appropriate governing bodies in meeting their requirements. This site is subject to revocation if the site plan, plat, or the intended use changes. The Improvement Permit shall not be affected by a change in ownership of the site. This permit is subject to compliance with the provisions of the Laws and Rules for Sewage Treatment and Disposal and to conditions of this permit.

## Construction Authorization

(Required for Building Permit)

The construction and installation requirements of Rules .1950, .1952, .1954, .1956, .1957, .1958, and .1959 are incorporated by references into this permit and shall be met. Systems shall be installed in accordance with the attached system layout.

ISSUED TO: Beltwell Homes Inc PROPERTY LOCATION: SR 1429 CHALYBEATE RD  
 SUBDIVISION: DESTERFIELD LOT # 57  
 Facility Type: SFD  New  Expansion  Repair  
 Basement?  Yes  No Basement Fixtures?  Yes  No  
 Type of Wastewater System\*\* 25% REDUCTION SYSTEM (Initial) Wastewater Flow: 360 GPD  
 (See note below, if applicable )  
25% REDUCTION SYSTEM (Repair)

### Installation Requirements/Conditions

Septic Tank Size 1000 gallons Exact length of each trench 3 x 80 feet Trench Spacing: 9 Feet on Center  
 Pump Tank Size 1000 gallons Trenches shall be installed on contour at a \_\_\_\_\_ Soil Cover: 6 inches  
 Maximum Trench Depth of: 16" MAX inches (Maximum soil cover shall not exceed 36" above the trench bottom)  
 (Trench bottoms shall be level to +1-1/4" in all directions)  
 Pump Requirements: \_\_\_\_\_ ft. TDH vs. \_\_\_\_\_ GPM Aggregate Depth: 6 inches below pipe  
 \_\_\_\_\_ inches above pipe  
 \_\_\_\_\_ inches total

\*\*If applicable: I understand the system type specified is different from the type specified on the application. I accept the specifications of this permit.

Owner/Legal Representative Signature: \_\_\_\_\_ Date: \_\_\_\_\_

This Construction Authorization is subject to revocation if the site plan, plat, or the intended use changes. The Construction Authorization shall not be transferred when there is a change in ownership of the site. This Construction Authorization is subject to compliance with the provisions of the Laws and Rules for Sewage Treatment and Disposal and to the conditions of this permit.

Authorized State Agent: James Manhattan Date: 6-8-07 SEE ATTACHED SITE SKETCH  
 Construction Authorization Expiration Date: 6-8-12

HTE# 07-5-17624

Permit # 23960

# Harnett County Department of Public Health Site Sketch

PROPERTY LOCATOR: SR1429 CHAIYBEATR RD

ISSUED TO: Beltwell Homes Inc

SUBDIVISION DEXTERFIELD

LOT # 57

Authorized State Agent:

*James E. M... ..*

Date: 6-8-07

\* Told to  
reconnect

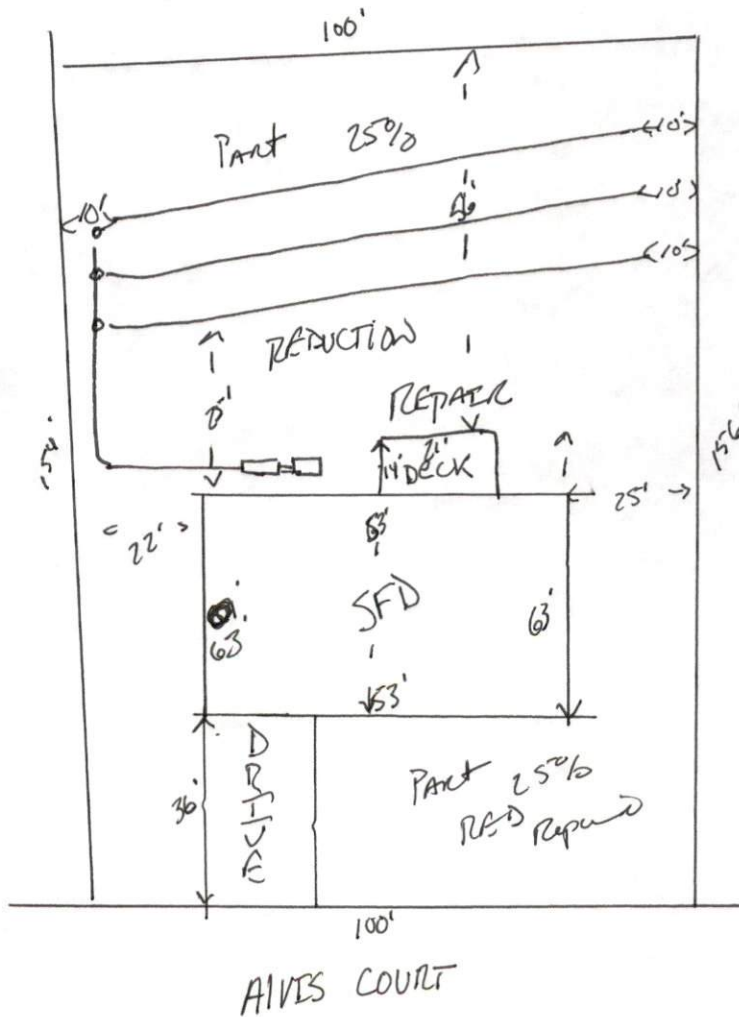
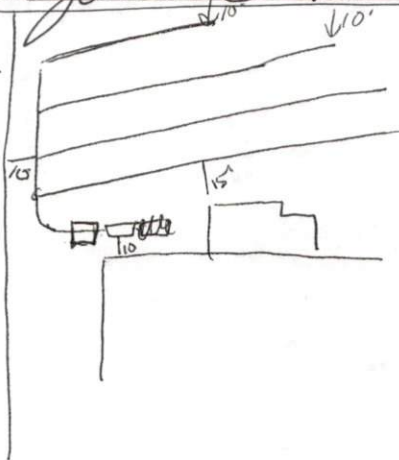

Pump System  
to MANIFOLD

3 - 1/2" x 1/4" VALVES  
IN MANIFOLD