

HTE# 07-5-17567

Harnett County Department of Public Health **23499**

Improvement Permit

A building permit cannot be issued with only an Improvement Permit

ISSUED TO: Evans Fine Homes PROPERTY LOCATION: SR 1403 Cokerbury Rd
 SUBDIVISION: Kintwood Estates LOT # 2
 NEW REPAIR EXPANSION Site Improvements required prior to Construction Authorization Issuance:
 Type of Structure: SFD 31'x41'
 Proposed Wastewater System Type: pump to Accepted System/Mantee Distribution
 Projected Daily Flow: 360 GPD
 Number of bedrooms: 3 Number of Occupants: 6 max
 Basement Yes No
 Pump Required: Yes No May be required based on final location and elevations of facilities
 Type of Water Supply: Community Public Well Distance from well _____ feet Permit valid for: Five years
 Permit conditions: _____ No expiration

Authorized State Agent: [Signature] Date: 6/8/2012 SEE ATTACHED SITE SKETCH
 The issuance of this permit by the Health Department in no way guarantees the issuance of other permits. The permit holder is responsible for checking with appropriate governing bodies in meeting their requirements. This site is subject to revocation if the site plan, plat, or the intended use changes. The Improvement Permit shall not be affected by a change in ownership of the site. This permit is subject to compliance with the provisions of the Laws and Rules for Sewage Treatment and Disposal and to conditions of this permit.

Construction Authorization

(Required for Building Permit)

The construction and installation requirements of Rules .1950, .1952, .1954, .1955, .1956, .1957, .1958, and .1959 are incorporated by references into this permit and shall be met. Systems shall be installed in accordance with the attached system layout.

ISSUED TO: Evans Fine Homes PROPERTY LOCATION: SR 1403
 SUBDIVISION: Kintwood Estates LOT # 2
 Facility Type: SFD 31'x41' New Expansion Repair
 Basement? Yes No Basement Fixtures? Yes No
 Type of Wastewater System** Pump to Accepted System (Initial) Wastewater Flow: 360 GPD
 (See note below, if applicable Pump to Accepted System w/ mantee distribution (Repair))

Installation Requirements/Conditions

Septic Tank Size 1000 gallons Exact length of each trench 2x60 feet Trench Spacing: 9 Feet on Center
 Pump Tank Size 1000 gallons Trenches shall be installed on contour at a Soil Cover: 6-18 inches
 Maximum Trench Depth of: 30-18 inches (Maximum soil cover shall not exceed 36" above the trench bottom)
 (Trench bottoms shall be level to +/- 1/4" in all directions)
 Pump Requirements: 15 ft. TDH vs. 23 GPM _____ inches below pipe
 Conditions: Start ditches at 30 inches deep & run to 18 inches Aggregate Depth: _____ inches above pipe
 _____ inches total

**If applicable: I understand the system type specified is different from the type specified on the application. I accept the specifications of this permit.

Owner/Legal Representative Signature: _____ Date: _____

This Construction Authorization is subject to revocation if the site plan, plat, or the intended use changes. The Construction Authorization shall not be transferred when there is a change in ownership of the site. This Construction Authorization is subject to compliance with the provisions of the Laws and Rules for Sewage Treatment and Disposal and to the conditions of this permit.

Authorized State Agent: [Signature] Date: 6/8/2012 SEE ATTACHED SITE SKETCH
 Construction Authorization Expiration Date: 6/8/2012

HTE# 07-5-17567

Permit # 23499

Harnett County Department of Public Health Site Sketch

ISSUED TO: Evans Fine Homes PROPERTY LOCATOR: SR 1403 Cokerbury Rd
SUBDIVISION: Kintwood Estates LOT # 2
Authorized State Agent: [Signature] Date: 6/8/2007

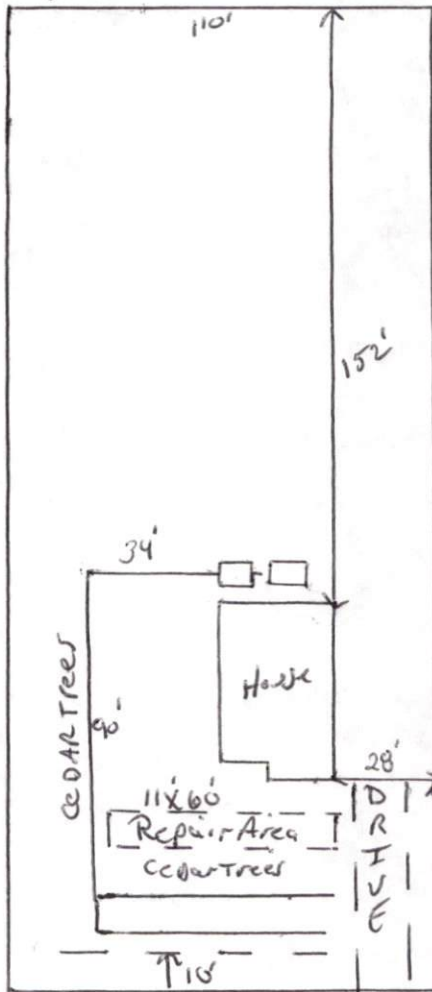

* Repair will be
pump to Accepted System

Cokerbury Rd.