

HTE# 07-50017441

Harris County Department of Public Health

23922

Cumberland Homes

Improvement Permit

A building permit cannot be issued with only an Improvement Permit

ISSUED TO: Briese Builders PROPERTY LOCATION: 1108 SUBDIVISION: Yorkshire Plantation LOT # 168

NEW [X] REPAIR [ ] EXPANSION [ ] Type of Structure: SFD-52x34 3BR Proposed Wastewater System Type: 25% Reduction system Projected Daily Flow: 360 GPD Number of bedrooms: 3 Number of Occupants: 6 max

Site Improvements required prior to Construction Authorization Issuance:

Basement [ ] Yes [X] No Pump Required: [ ] Yes [X] No [ ] May be required based on final location and elevations of facilities Type of Water Supply: [ ] Community [X] Public [ ] Well Distance from well: 50 feet Permit valid for: [X] Five years [ ] No expiration Permit conditions: STUB out Plumbing shallow, AT Ground level or higher Where shown maintain all set-backs meet onsite if question or problem arise

Authorized State Agent: J. W. A. N. Date: 5-11-07 SEE ATTACHED SITE SKETCH

The issuance of this permit by the Health Department in no way guarantees the issuance of other permits. The permit holder is responsible for checking with appropriate governing bodies in meeting their requirements. This site is subject to revocation if the site plan, plat, or the intended use changes. The Improvement Permit shall not be affected by a change in ownership of the site. This permit is subject to compliance with the provisions of the Laws and Rules for Sewage Treatment and Disposal and to conditions of this permit.

Construction Authorization

(Required for Building Permit)

The construction and installation requirements of Rules .1950, .1952, .1954, .1955, .1956, .1957, .1958, and .1959 are incorporated by references into this permit and shall be met. Systems shall be installed in accordance with the attached system layout.

ISSUED TO: Briese Builders PROPERTY LOCATION: 1108 SUBDIVISION: Yorkshire Plantation LOT # 168

Facility Type: SFD-52x34 3BR [X] New [ ] Expansion [ ] Repair Basement? [ ] Yes [X] No Basement Fixtures? [ ] Yes [X] No Type of Wastewater System\*\* 25% Reduction sys. (Initial) Wastewater Flow: 360 GPD (See note below, if applicable [X] 240 LF / LPP (Repair)

Installation Requirements/Conditions

Septic Tank Size 1000 gallons Exact length of each trench 1x150 feet Trench Spacing: 9 Feet on Center Pump Tank Size \_\_\_\_\_ gallons Trenches shall be installed on contour at a Soil Cover: 6 inches Maximum Trench Depth of: 18-24 inches (Maximum soil cover shall not exceed 36" above the trench bottom) (Trench bottoms shall be level to +/- 1/4" in all directions) Pump Requirements: \_\_\_\_\_ ft. TDH vs. \_\_\_\_\_ GPM Aggregate Depth: \_\_\_\_\_ inches below pipe \_\_\_\_\_ inches above pipe \_\_\_\_\_ inches total Conditions: \_\_\_\_\_

\*\*If applicable: I understand the system type specified is different from the type specified on the application. I accept the specifications of this permit.

Owner/Legal Representative Signature: \_\_\_\_\_ Date: \_\_\_\_\_

This Construction Authorization is subject to revocation if the site plan, plat, or the intended use changes. The Construction Authorization shall not be transferred when there is a change in ownership of the site. This Construction Authorization is subject to compliance with the provisions of the Laws and Rules for Sewage Treatment and Disposal and to the conditions of this permit.

Authorized State Agent: J. W. A. N. Date: 5-11-07 SEE ATTACHED SITE SKETCH

Construction Authorization Expiration Date: 5-11-2012

HTE# 07-500 17741

Permit # 23922

# Harnett County Department of Public Health Site Sketch

ISSUED TO: Briese Builders

PROPERTY LOCATOR: 1104

SUBDIVISION Yorkshire Plantation LOT # 168

Authorized State Agent: [Signature]

Date: 5-11-07

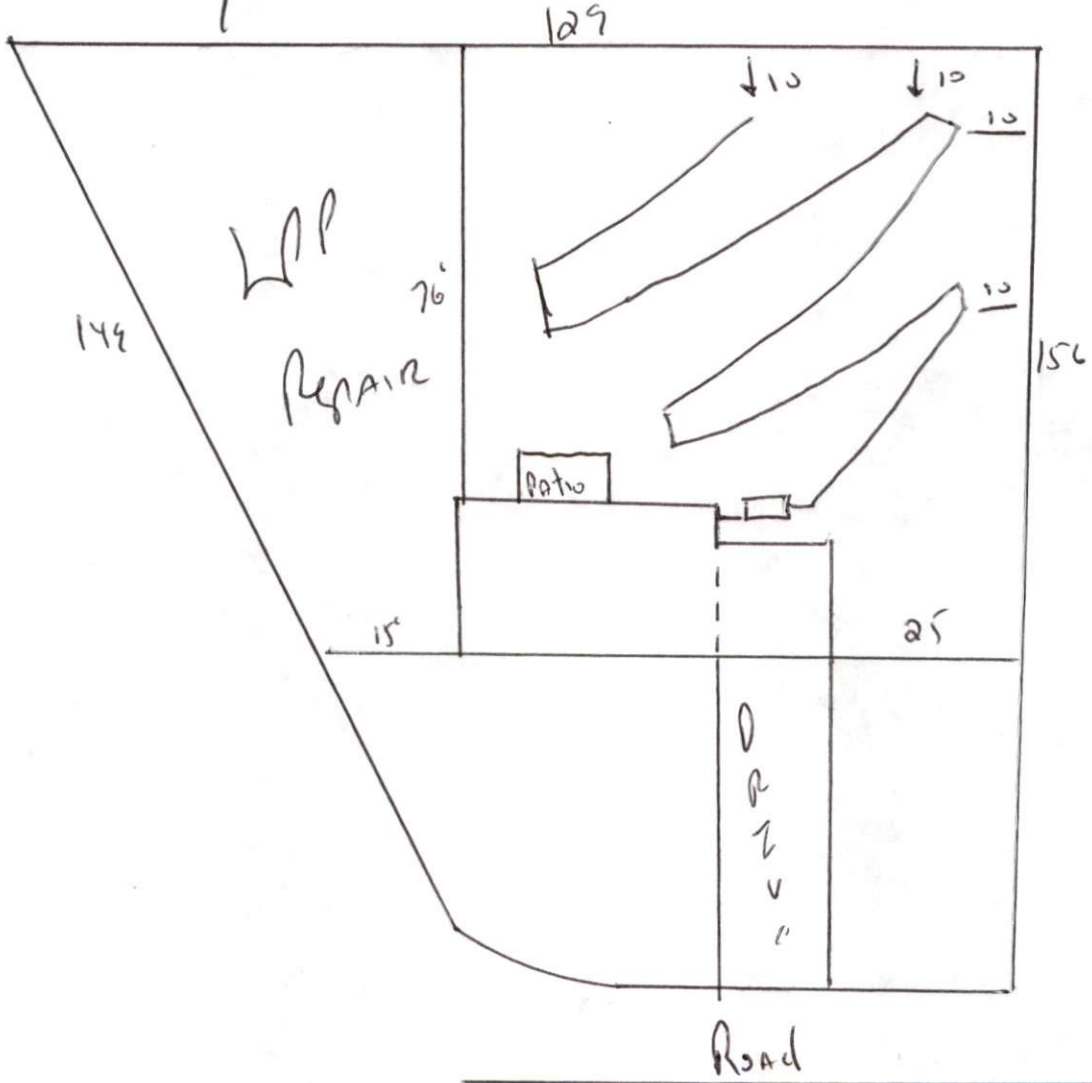

STUB OUT Plumbing shallow, At ground level or higher where shown. Maintain All Setbacks Install 1x150 & 25% Reduction system At 18 to 24"