

HTE# 07-50017349

# Harnett County Department of Public Health

23911

## Improvement Permit

A building permit cannot be issued with only an Improvement Permit

ISSUED TO: Herbert Matthews Jr PROPERTY LOCATION: 1201  
 SUBDIVISION Carolina Seasons LOT # H1  
 NEW  REPAIR  EXPANSION   
 Type of Structure: SFO-57x56-30R Site Improvements required prior to Construction Authorization Issuance:  
 Proposed Wastewater System Type: GRAVEL  
 Projected Daily Flow: 360 GPD  
 Number of bedrooms: 3 Number of Occupants: 6 max  
 Basement  Yes  No  
 Pump Required:  Yes  No  May be required based on final location and elevations of facilities  
 Type of Water Supply:  Community  Public  Well Distance from well 50 feet Permit valid for:  Five years  
 Permit conditions: STUB out Plumbing Shallow At Ground level or higher where shown. maintain all set back.  No expiration

Authorized State Agent: J. L. Lewis Date: 05-01-07 SEE ATTACHED SITE SKETCH  
 The issuance of this permit by the Health Department in no way guarantees the issuance of other permits. The permit holder is responsible for checking with appropriate governing bodies in meeting their requirements. This site is subject to revocation if the site plan, plat, or the intended use changes. The Improvement Permit shall not be affected by a change in ownership of the site. This permit is subject to compliance with the provisions of the Laws and Rules for Sewage Treatment and Disposal and to conditions of this permit.

## Construction Authorization

(Required for Building Permit)

The construction and installation requirements of Rules .1950, .1952, .1954, .1955, .1956, .1957, .1958, and .1959 are incorporated by references into this permit and shall be met. Systems shall be installed in accordance with the attached system layout.

ISSUED TO: Herbert Matthews Jr PROPERTY LOCATION: 1201  
 SUBDIVISION Carolina Seasons LOT # H1  
 Facility Type: SFO-57x56-30R  New  Expansion  Repair  
 Basement?  Yes  No Basement Fixtures?  Yes  No  
 Type of Wastewater System\*\* GRAVEL (Initial) Wastewater Flow: 360 GPD  
 (See note below, if applicable  240 LF of LPP (Repair)

### Installation Requirements/Conditions

Septic Tank Size 1000 gallons Exact length of each trench 1x200 feet Trench Spacing: 9 Feet on Center  
 Pump Tank Size \_\_\_\_\_ gallons Trenches shall be installed on contour at a Soil Cover: 6 inches  
 Maximum Trench Depth of: 18-24 inches (Maximum soil cover shall not exceed 36" above the trench bottom)  
 (Trench bottoms shall be level to +/-1/4" in all directions)  
 Pump Requirements: \_\_\_\_\_ ft. TDH vs. \_\_\_\_\_ GPM Aggregate Depth: 6 inches below pipe  
 Conditions: \_\_\_\_\_ 2 inches above pipe  
12 inches total

\*\*If applicable: I understand the system type specified is different from the type specified on the application. I accept the specifications of this permit.

Owner/Legal Representative Signature: \_\_\_\_\_ Date: \_\_\_\_\_

This Construction Authorization is subject to revocation if the site plan, plat, or the intended use changes. The Construction Authorization shall not be transferred when there is a change in ownership of the site. This Construction Authorization is subject to compliance with the provisions of the Laws and Rules for Sewage Treatment and Disposal and to the conditions of this permit.

Authorized State Agent: J. L. Lewis Date: 05-01-07 SEE ATTACHED SITE SKETCH  
 Construction Authorization Expiration Date: 05-01-2012

HTE# 07-50017349

Permit # 23911

# Harnett County Department of Public Health Site Sketch

ISSUED TO: Herbert Matthews Jr PROPERTY LOCATOR: 1201  
SUBDIVISION Carolina Seasons LOT # H-1

Authorized State Agent: [Signature] Date: 5-1-07

20' 4x4 Post & Cable 163 20'

254  
50' A  
20' A  
10' A

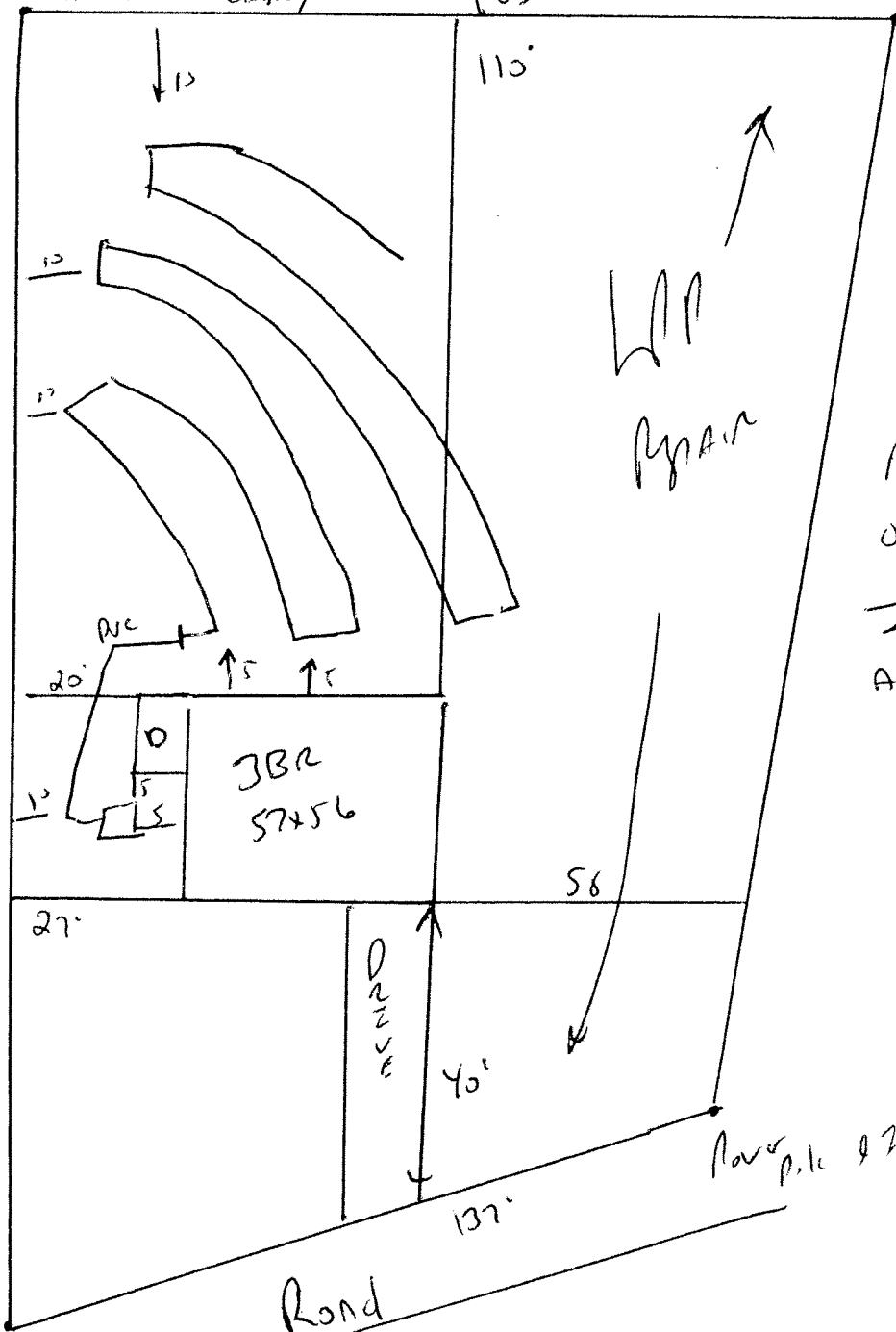

198

STUB out Plumbing  
shallow, where shown  
At ground level or higher  
MAINTAIN All set Backs  
Meet on site if A Question  
or problems arise  
Install 1x200 of gravel  
At 18" + 24"

Power, gas & water

Road

20'