

HTE# 07-50017323

Harold County Department of Public Health

23845

Improvement Permit

A building permit cannot be issued with only an Improvement Permit

ISSUED TO: Scott Corcoran PROPERTY LOCATION: Old 421 SUBDIVISION SHAYLA'S Knoll LOT # 25

NEW [X] REPAIR [] EXPANSION [] Site Improvements required prior to Construction Authorization Issuance:

Type of Structure: SFD 33x52 3BR

Proposed Wastewater System Type: Pump to 25% Red. system

Projected Daily Flow: 360 GPD

Number of bedrooms: 3 Number of Occupants: 6 max

Basement [] Yes [X] No

Pump Required: [X] Yes [] No [] May be required based on final location and elevations of facilities

Type of Water Supply: [] Community [X] Public [] Well Distance from well 50 feet Permit valid for: [X] Five years [] No expiration

Permit conditions: Meet onsite maintain all set backs - STUB out plumbing shallow at ground level or higher where shown a pump may not be required. if 18" Ditch Depth, can be maintained

Authorized State Agent: J. LAR Date: 04-19-07 SEE ATTACHED SITE SKETCH

The issuance of this permit by the Health Department in no way guarantees the issuance of other permits. The permit holder is responsible for checking with appropriate governing bodies in meeting their requirements. This site is subject to revocation if the site plan, plat, or the intended use changes. The Improvement Permit shall not be affected by a change in ownership of the site. This permit is subject to compliance with the provisions of the Laws and Rules for Sewage Treatment and Disposal and to conditions of this permit.

Construction Authorization

(Required for Building Permit)

The construction and installation requirements of Rules .1950, .1952, .1954, .1955, .1956, .1957, .1958, and .1959 are incorporated by references into this permit and shall be met. Systems shall be installed in accordance with the attached system layout.

ISSUED TO: Scott Corcoran PROPERTY LOCATION: Old 421 SUBDIVISION SHAYLA'S Knoll LOT # 25

Facility Type: SFD-33x52 3BR [X] New [] Expansion [] Repair

Basement? [] Yes [X] No Basement Fixtures? [] Yes [X] No

Type of Wastewater System** Pump to 25% Red. sys. (Initial) Wastewater Flow: 360 GPD

(See note below, if applicable [X]) 290 LF 1 LPP (Repair)

Installation Requirements/Conditions

Septic Tank Size 1000 gallons Exact length of each trench 1x180 feet Trench Spacing: 9 Feet on Center

Pump Tank Size 1000 gallons Trenches shall be installed on contour at a Soil Cover: 6 inches

Maximum Trench Depth of: 18 inches (Maximum soil cover shall not exceed 36" above the trench bottom)

(Trench bottoms shall be level to +/-1/4" in all directions)

Pump Requirements: _____ ft. TDH vs. _____ GPM _____ inches below pipe

Aggregate Depth: _____ inches above pipe

Conditions: _____ inches total

**If applicable: I understand the system type specified is different from the type specified on the application. I accept the specifications of this permit.

Owner/Legal Representative Signature: _____ Date: _____

This Construction Authorization is subject to revocation if the site plan, plat, or the intended use changes. The Construction Authorization shall not be transferred when there is a change in ownership of the site. This Construction Authorization is subject to compliance with the provisions of the Laws and Rules for Sewage Treatment and Disposal and to the conditions of this permit.

Authorized State Agent: J. LAR Date: 04-19-07 SEE ATTACHED SITE SKETCH

Construction Authorization Expiration Date: 04-19-2012

HTE# 07500/7323

Permit # 23845

Harnett County Department of Public Health Site Sketch

ISSUED TO: Scott
CORCORAN

PROPERTY LOCATOR: Old 421

SUBDIVISION SHAYLA J KNOX

LOT # 25

Authorized State Agent: J. W. [Signature]

Date: 04-19-07

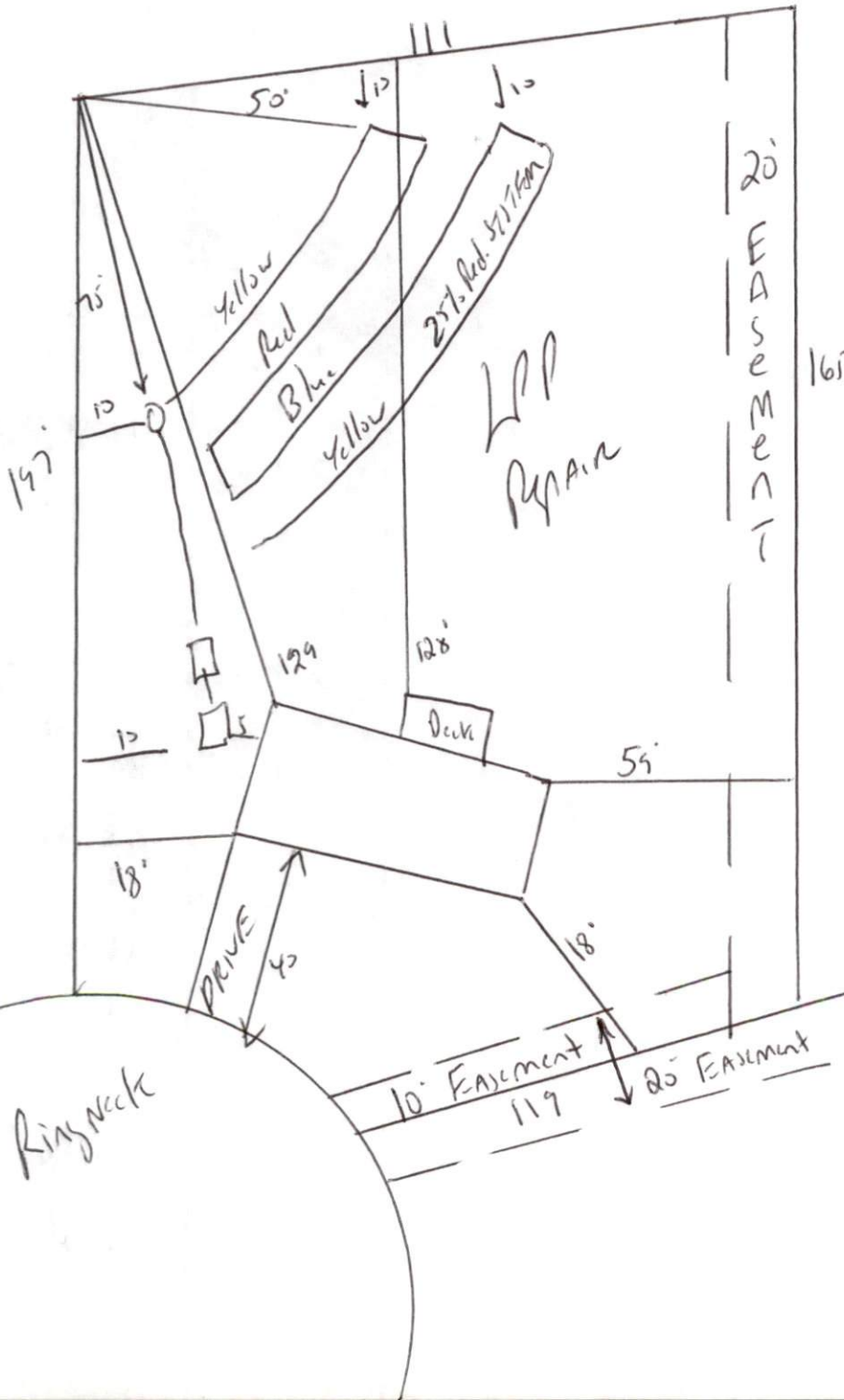

STUB out Plumbing
 Shallow - At ground level
 or higher where shown
 And pump may not
 be required - if 18"
 Ditch Depth, can be
 MAINTAIN
 Meet onsite

MAINTAIN ALL
 setBacks

Install 1x180
 At 18" Deep

of
 25%
 Reduction
 system