

HTE# 07-50017283

Harrison County Department of Public Health

23917

Improvement Permit

A building permit cannot be issued with only an Improvement Permit

ISSUED TO: CAVINES & CATER PROPERTY LOCATION: 1141
 SUBDIVISION: The Summit LOT # 103
 NEW REPAIR EXPANSION
 Type of Structure: SFD- 52x54 3DR
 Proposed Wastewater System Type: Pumps 25% Red. ST
 Projected Daily Flow: 365 GPD
 Number of bedrooms: 3 Number of Occupants: 6 max
 Basement Yes No
 Pump Required: Yes No May be required based on final location and elevations of facilities
 Type of Water Supply: Community Public Well Distance from well 50 feet Permit valid for: Five years
 Permit conditions: Met onsite maintain all set backs. ST out
Plumbing shallow at ground level or higher where shown
Keep drain field 25' from rear property line
 No expiration

Authorized State Agent: J. L. AM Date: 5-3-07 SEE ATTACHED SITE SKETCH
 The issuance of this permit by the Health Department in no way guarantees the issuance of other permits. The permit holder is responsible for checking with appropriate governing bodies in meeting their requirements. This site is subject to revocation if the site plan, plat, or the intended use changes. The Improvement Permit shall not be affected by a change in ownership of the site. This permit is subject to compliance with the provisions of the Laws and Rules for Sewage Treatment and Disposal and to conditions of this permit.

Construction Authorization

(Required for Building Permit)

The construction and installation requirements of Rules .1950, .1952, .1954, .1955, .1956, .1957, .1958, and .1959 are incorporated by references into this permit and shall be met. Systems shall be installed in accordance with the attached system layout.

ISSUED TO: CAVINES & CATER PROPERTY LOCATION: 1141
 SUBDIVISION: The Summit LOT # 103
 Facility Type: SFD- 52x54 3DR New Expansion Repair
 Basement? Yes No Basement Fixtures? Yes No
 Type of Wastewater System** Pumps 25% Red. ST (Initial) Wastewater Flow: 360 GPD
 (See note below, if applicable) 240 LF of WPP (Repair)

Installation Requirements/Conditions

Septic Tank Size 1000 gallons Exact length of each trench 2x75 feet Trench Spacing: 9 Feet on Center
 Pump Tank Size 1000 gallons Trenches shall be installed on contour at a Soil Cover: 6 inches
 Maximum Trench Depth of: 18-24 inches (Maximum soil cover shall not exceed 36" above the trench bottom)
 (Trench bottoms shall be level to +/-1/4" in all directions)
 Pump Requirements: _____ ft. TDH vs. _____ GPM _____ inches below pipe
 Aggregate Depth: _____ inches above pipe
 Conditions: _____ inches total

*If applicable: *I understand the system type specified is different from the type specified on the application. I accept the specifications of this permit.*

Owner/Legal Representative Signature: _____ Date: _____

This Construction Authorization is subject to revocation if the site plan, plat, or the intended use changes. The Construction Authorization shall not be transferred when there is a change in ownership of the site. This Construction Authorization is subject to compliance with the provisions of the Laws and Rules for Sewage Treatment and Disposal and to the conditions of this permit.

Authorized State Agent: J. L. AM Date: 5-3-07 SEE ATTACHED SITE SKETCH
 Construction Authorization Expiration Date: 5-3-2012

HTE# 07-50017283

Permit # 23917

Harnett County Department of Public Health Site Sketch

ISSUED TO: Caviness & Co

PROPERTY LOCATOR: 1141
SUBDIVISION: The Summit

LOT # 103

Authorized State Agent: J. L. ...

Date: 5-3-07

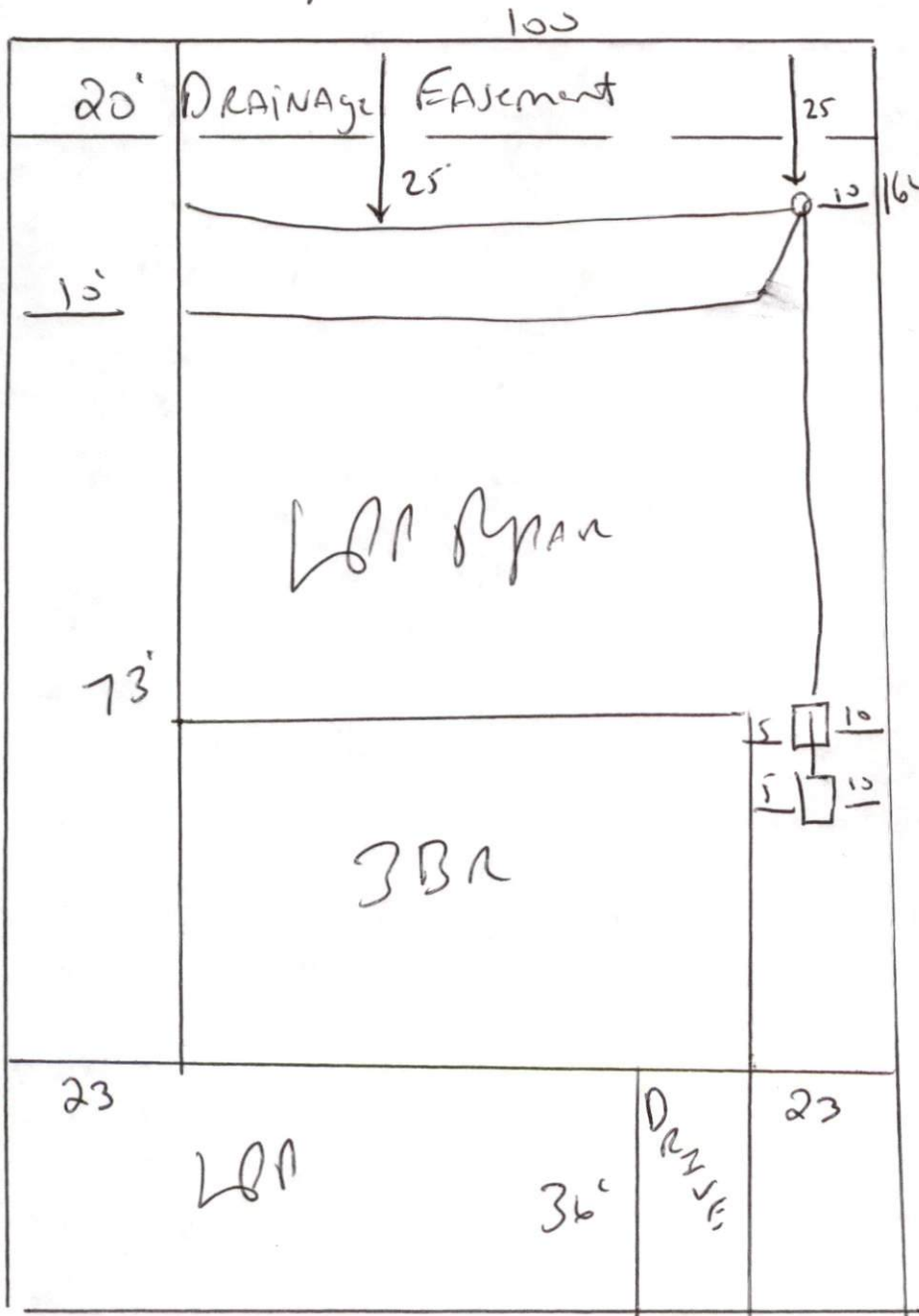

Meet onsite
 Maintain all
 set backs,
 Install 2x75
 At 18" to 24" Deep
 Keep Drain Lines
 25' from Rear
 Property Line

Rd