

HTE# 07-50017224

Harrison County Department of Public Health

23903

Improvement Permit

A building permit cannot be issued with only an Improvement Permit

ISSUED TO: Associated Bid Place PROPERTY LOCATION: 1203
SUBDIVISION: Associated Builders LOT # 2
Type of Structure: SFD- 24x51 - 30A
Proposed Wastewater System Type: Pump to 25% reduction system
Projected Daily Flow: 360 GPD
Number of bedrooms: 3 Number of Occupants: 6 max
Basement: Yes No
Pump Required: Yes No
Type of Water Supply: Community Public Well
Permit conditions: Meet on site - maintain all set backs

Authorized State Agent: [Signature] Date: 4-10-07 SEE ATTACHED SITE SKETCH
The issuance of this permit by the Health Department in no way guarantees the issuance of other permits. The permit holder is responsible for checking with appropriate governing bodies in meeting their requirements. This site is subject to revocation if the site plan, plat, or the intended use changes. The Improvement Permit shall not be affected by a change in ownership of the site. This permit is subject to compliance with the provisions of the Laws and Rules for Sewage Treatment and Disposal and to conditions of this permit.

Construction Authorization

(Required for Building Permit)

The construction and installation requirements of Rules .1950, .1952, .1954, .1955, .1956, .1957, .1958, and .1959 are incorporated by references into this permit and shall be met. Systems shall be installed in accordance with the attached system layout.

ISSUED TO: Associated Bid Place Co PROPERTY LOCATION: 1203
SUBDIVISION: Associated Builders LOT # 2
Facility Type: SFD- 24x51 - 30A New Expansion Repair
Basement? Yes No Basement Fixtures? Yes No
Type of Wastewater System\*\* Pump to 25% red. syst (Initial) Wastewater Flow: GPD
(See note below, if applicable) 360 CF of LP (Repair)

Installation Requirements/Conditions

Septic Tank Size 1000 gallons Exact length of each trench 1x265 feet Trench Spacing: 9 Feet on Center
Pump Tank Size 1000 gallons Trenches shall be installed on contour at a Soil Cover: 6 inches
Maximum Trench Depth of: 18 inches (Maximum soil cover shall not exceed 36" above the trench bottom)
Pump Requirements: ft. TDH vs. GPM Aggregate Depth: inches below pipe inches above pipe inches total
Conditions:

\*\*If applicable: I understand the system type specified is different from the type specified on the application. I accept the specifications of this permit.

Owner/Legal Representative Signature: Date:

This Construction Authorization is subject to revocation if the site plan, plat, or the intended use changes. The Construction Authorization shall not be transferred when there is a change in ownership of the site. This Construction Authorization is subject to compliance with the provisions of the Laws and Rules for Sewage Treatment and Disposal and to the conditions of this permit.

Authorized State Agent: [Signature] Date: 4-10-07 SEE ATTACHED SITE SKETCH
Construction Authorization Expiration Date: 4-10-2012

HTE# 07-50017224

Permit # 23903

# Harnett County Department of Public Health Site Sketch

ISSUED TO: Associated Bldgs & Loo Co PROPERTY LOCATOR: 1203  
SUBDIVISION: Associated Builders LOT # 2

Authorized State Agent: [Signature] Date: 7-12-07

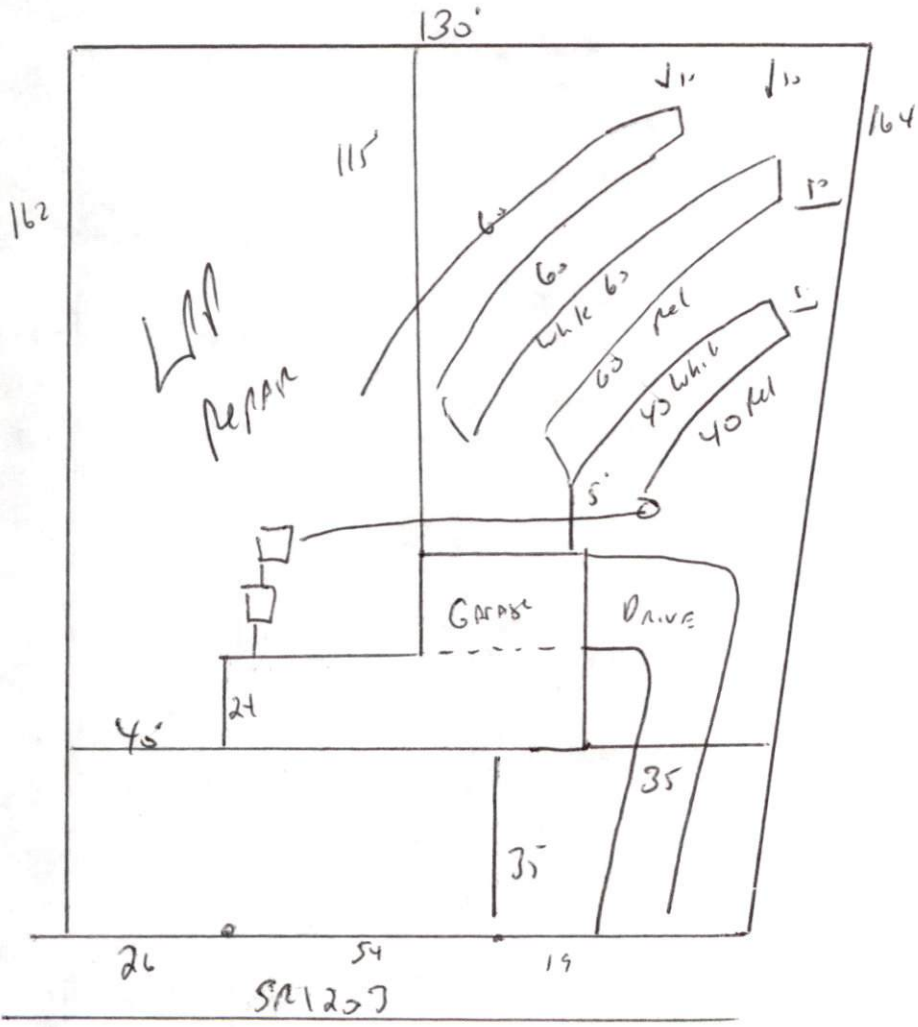

meet on site  
 maintain All setBacks  
 Start out Plumbing  
 Where shown  
 maintain All setBacks  
 Install 1x265 of  
 25% Reduction system  
 At 18"

SA 1203