

Owner:  
 Property No.:  
 Lot #: 15  
 File #:  
 Code:

**SOIL/SITE EVALUATION  
 for ON-SITE WASTEWATER SYSTEM**

Owner:  
 Address:  
 Proposed Facility: 3BR SFD Design Flow (.1949): 360  
 Location of Site: Sherman Pkwy  
 Water Supply:  Public  Individual  Well  
 Evaluation Method:  Auger Boring  Pit  
 Type of Wastewater:  Sewage  Industrial Process

Applicant: *Hometown Developers*  
 Date Evaluated: 4/18/07  
 Property Size: .71A  
 Property Recorded:  
 Spring  Other  
 Cut  
 Mixed

Profile #	1940 Landscape Position/Slope%	Horizon Depth (IN.)	SOIL MORPHOLOGY		OTHER PROFILE FACTORS				Profile Class & LTAR
			1941		1942 Soil Wetness/Color	1943 Soil Depth (IN.)	1944 Saprolite Class	1944 Restr. Horiz.	
			1941 Structure/Texture	1941 Consistence/Mineralogy					
1	57.	0-20	SL Fr	Gr	SSSP				0.45
		20-36	SCL Fi	SBL	SP				PS
		36-44	CL/SCL Fi	SBL	SP	104R 7/2 @ 40"			
2		0-30	SL Fr	Gr	SSSP				0.5
		30-44	SCL Fi	SBL	SP	104R 7/2 @ 38"			PS
3		0-22	SL Fr	Gr	SSSP				0.45
		22-24	SCL Fi	SBL	SP				PS
		24-44	CL/SCL Fi	SBL	SP	104R 7/2 @ 38"			
4		0-6	SL Fr	Gr					U
		6-14	C(M) Fi			104R 7/2 @ 12"			
5		0-10	SL Fr	Gr	SSSP				U
		10-24	SCL Fi	SBL	SP	104R 7/2 @ 18"			
6		0-22	SL Fr	Gr	SSSP				0.45
		22-36	SCL Fi	SBL	SP				PS
		36-44	CL Fi	SBL	SP	104R 7/2 @ 36"			
7		0-10	SL Fr	Gr	SSSP				U
		10-12	SCL Fi	SBL	SP				b/c of slope
		12-20	CL Fi	SBL	SP	104R 7/2 @ 25"			
8		0-16	SL Fr	Gr	SSSP				PS
		16-32	SCL Fi	SBL	SP				0.45
		32-44	SL/SCL Fi	SBL	SP	104R 7/2 @ 42"			

Description	Initial System	Repair System
Available Space (.1945)	PS 257. Red	PS LPI
System Type(s)	0.45	0.225
Site LTAR	U	

Other Factors (.1946): *Slope, interceptor drain*  
 Site Classification (.1948): PS  
 Evaluated By: HC  
 Others Present:

COMMENTS: Interceptor drain needed

LANDSCAPE POSITIONS	GROUP	TEXTURES	.1955 LTAR	CONSISTENCE MOIST	WET
R-RIDGE	I	S-SAND	1.2 - 0.8	VFR-VERY FRIABLE	NS-NON-STICKY
S-SHOULDER SLOPE		LS-LOAMY SAND		FR-FRIABLE	SS-SLIGHTLY STICKY
L-LINEAR SLOPE	II	SL-SANDY LOAM	0.8 - 0.6	FI-FIRM	S-STICKY
FS-FOOT SLOPE		L-LOAM		VFI-VERY FIRM	VS-VERY STICKY
N-NOSE SLOPE	III	SI-SILT-	0.6 - 0.3	EFI-EXTREMELY FIRM	NP-NON-PLASTIC
H-HEAD SLOPE		SIL-SILT LOAM			SP-SLIGHTLY STICKY
CC-CONCLAVE SLOPE		CL-CLAY LOAM			P-PLASTIC
CV-CONVEX SLOPE		SCL-SANDY CLAY LOAM			VP-VERY PLASTIC
T-TERRACE		SICL-SILTY CLAY LOAM			
FP-FLOOD PLAN	IV	SIC-SILTY CLAY	0.4 - 0.1		
		C-CLAY			
		SC-SANDY CLAY			

**STRUCTURE**

- SG-SINGLE GRAIN
- M-MASSIVE
- CR-CRUMB
- GR-GRANULAR
- SBK-SUBANGULAR BLOCKY
- ABK-ANGULAR BLOCKY
- PL-PLATY
- PR-PRISMATIC

**MINERALOGY**

- SLIGHTLY EXPANSIVE
- EXPANSIVE

Show profile locations and other site features (dimensions, reference or benchmark, and North).

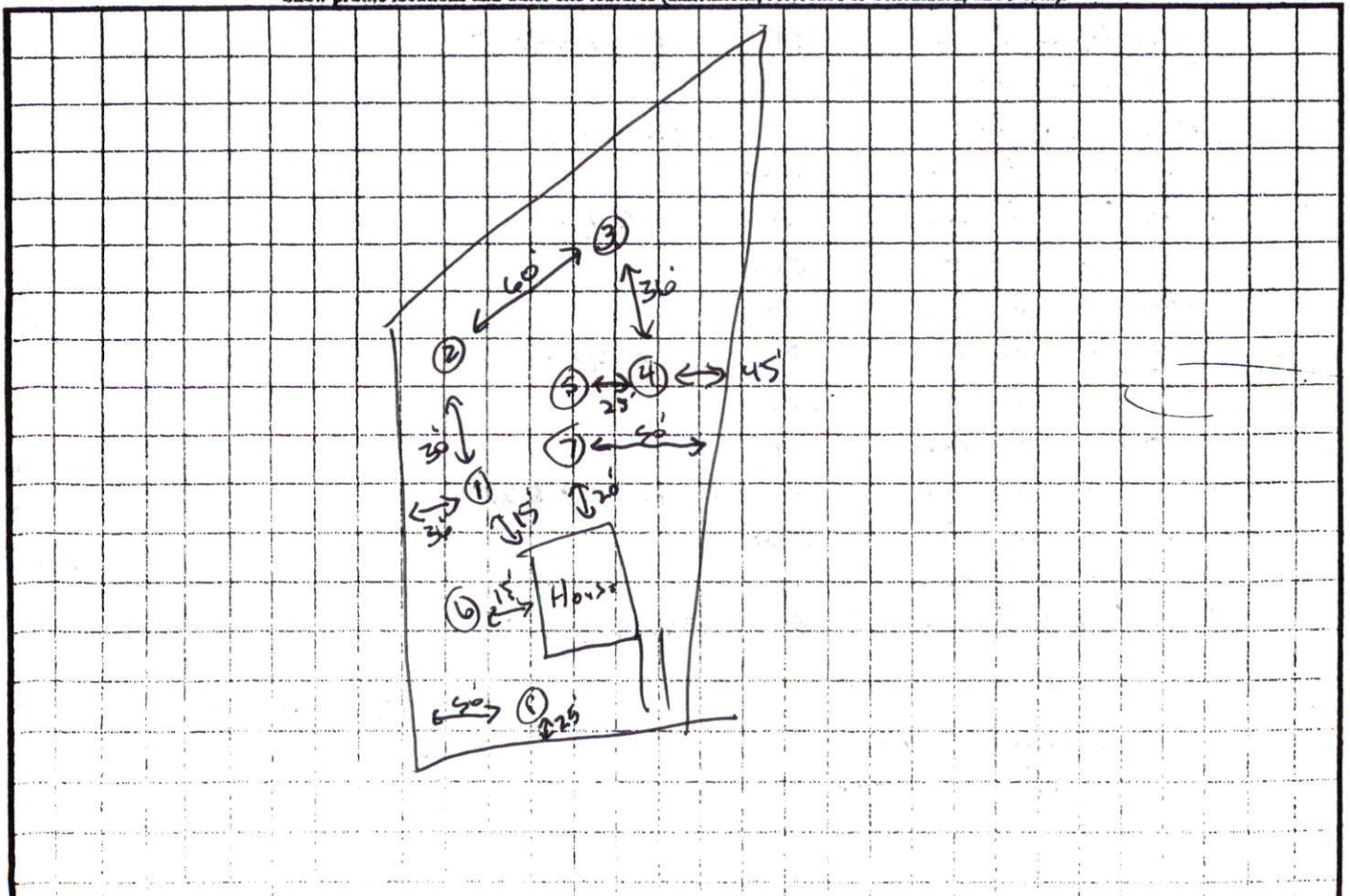

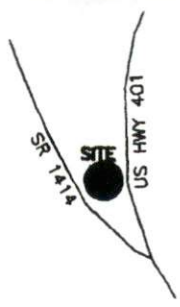

VICINITY MAP (NTS)

- LEGEND**
- NTS NOT TO SCALE
  - EIP EXISTING IRON PIPE
  - PP POWER POLE
  - W/M WATER METER
  - TB TELEPHONE BOX
  - IPS IRON PIPE SET
  - CP&L TRANSFORMER
  - CATV CABLE TV BOX
  - L POLE LIGHT POLE
  - OHPL OVERHEAD POWER LINE
  - F.E.S. FLARED END SECTION (PIPE)
  - RCP REINFORCED CONC. PIPE
  - B.O.C. BACK OF CURB
  - F.H. FIRE HYDRANT
  - C/O SEWER CLEAN OUT
  - EIS EXISTING IRON STAKE
  - M.H. MANHOLE
  - ECM EXISTING CONCRETE MONUMENT
  - P.K. PARKER KALON NAIL

CURVE	RADIUS	LENGTH	CHORD	CH.BEARING
C1	325.00'	100.40'	100.00'	S 36°13'55" W



NC GRID (NAD 83)  
REF: B.O.M. 2006 PG. 373

**M.H. RAWLS HEIRS**  
D.B. 161, PG 416

N 86°35'55"W  
10.00'

30' CAPE FEAR  
RIPARIAN BUFFER

16

S 44°55'05"E 294.19'

**SITE PLAN APPROVAL**  
DISTRICT BAZO USE SFD  
#BEDROOMS 43  
3/7/07  
M. DIXON  
Zoning Administrator

**FRANK H. McDOWELL**  
**EDNA R. McDOWELL**  
D.B. 827, PG 488

15

N 03°24'05"E 147.94'



PROP DRIVE

PROP WALK

N 62°37'04"W 170.20'

14

**SHERMAN PINES DRIVE**  
(50' PUBLIC R/W)

NOTE: SHOWN IS LOT 15 OF  
SHERMAN PINES S/D  
REF: B.O.M. 2006 PG. 373





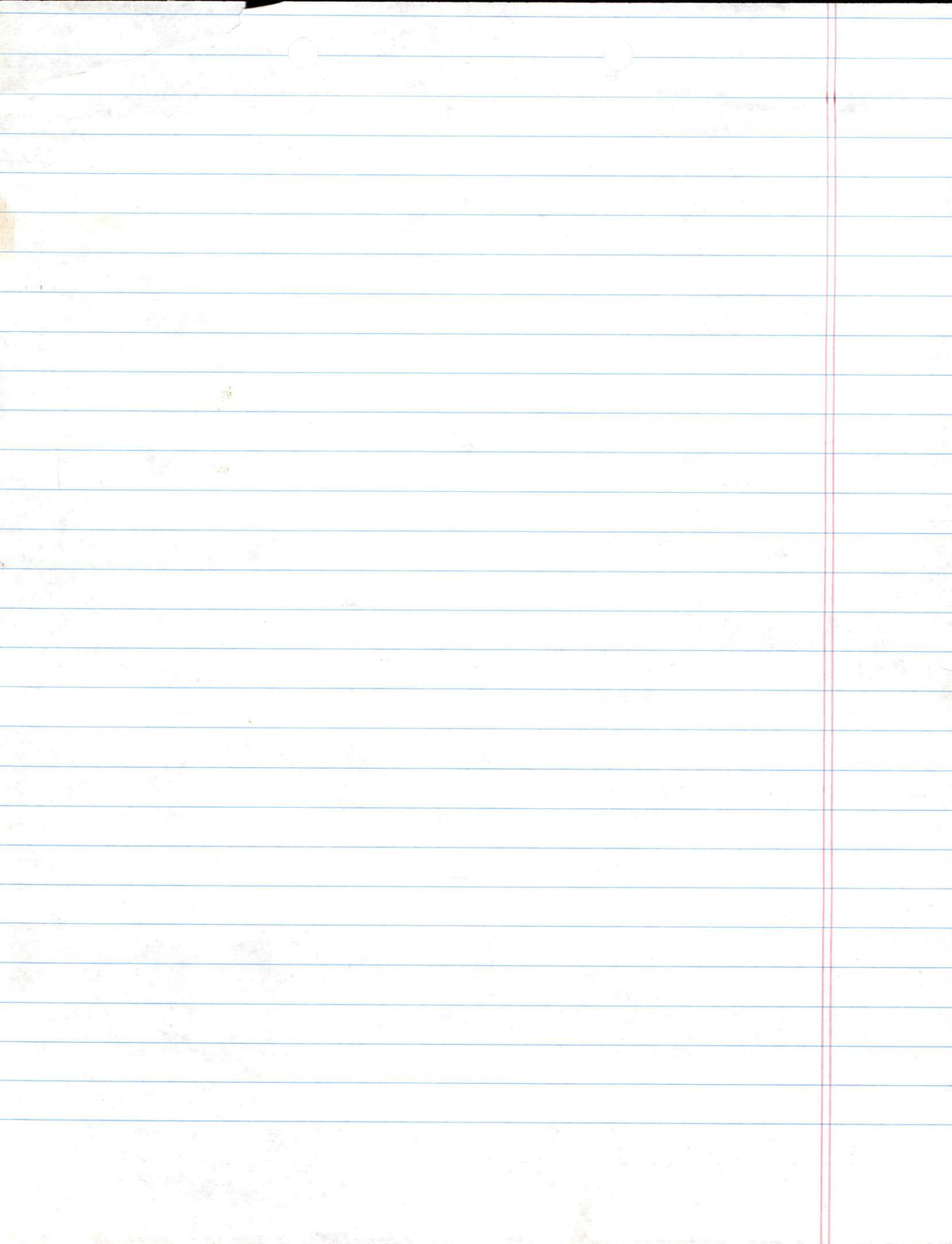

Need to layout home again  
 See mist be instructed by

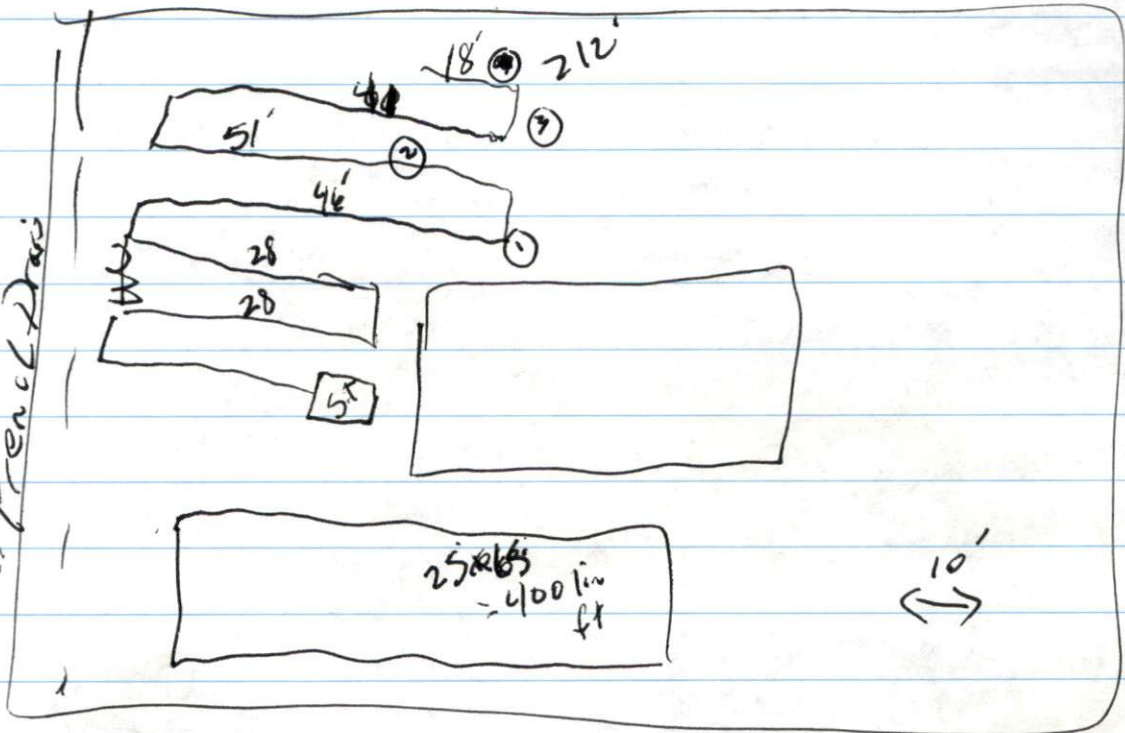

Need 320 linear ft 1600 ft<sup>2</sup>

French drain on left side of lot  
 install @ 12" bring in 6" cover

checked holes after layout back

① 104A 7/2 @ 28"      0-14 SL      BC Fr  
 14-30 SCL      SBIC Fr

② 104R 7/2 @ 33"      0-16 SL      ↗  
 16-34 SCL

③ 104R 7/2 @ 42"      0-18 SL  
 18-44 SCL

~~④ Front hole~~



3) 10.15 sin @ 48.

12.45 200  
0.18 20

4) 10.15 sin @ 32.

14.24 200  
0.10 20

5) 10.15 sin @ 32.

14.30 200. 2300 ft  
0.14 20 100 ft

graphical paper, office papers, paper

indicate to 10, 15, 20, 30, 40, 50, 60, 70, 80, 90, 100, 110, 120, 130, 140, 150, 160, 170, 180, 190, 200, 210, 220, 230, 240, 250, 260, 270, 280, 290, 300, 310, 320, 330, 340, 350, 360, 370, 380, 390, 400, 410, 420, 430, 440, 450, 460, 470, 480, 490, 500, 510, 520, 530, 540, 550, 560, 570, 580, 590, 600, 610, 620, 630, 640, 650, 660, 670, 680, 690, 700, 710, 720, 730, 740, 750, 760, 770, 780, 790, 800, 810, 820, 830, 840, 850, 860, 870, 880, 890, 900, 910, 920, 930, 940, 950, 960, 970, 980, 990, 1000

Use 350/1000 ft 1500 ft



10.15

$$360 \div 45 = 8 \text{ } \frac{0}{3} \\ \frac{20}{2}$$

2:20 PM

415107

$$\begin{array}{r} 45 \\ 52 \\ \hline 97 \\ 142 \\ \hline 239 \end{array}$$

$$\begin{array}{r} 55 \\ 47 \\ \hline 102 \\ 30 \\ \hline 131 \\ 204 \text{ ft} \end{array}$$

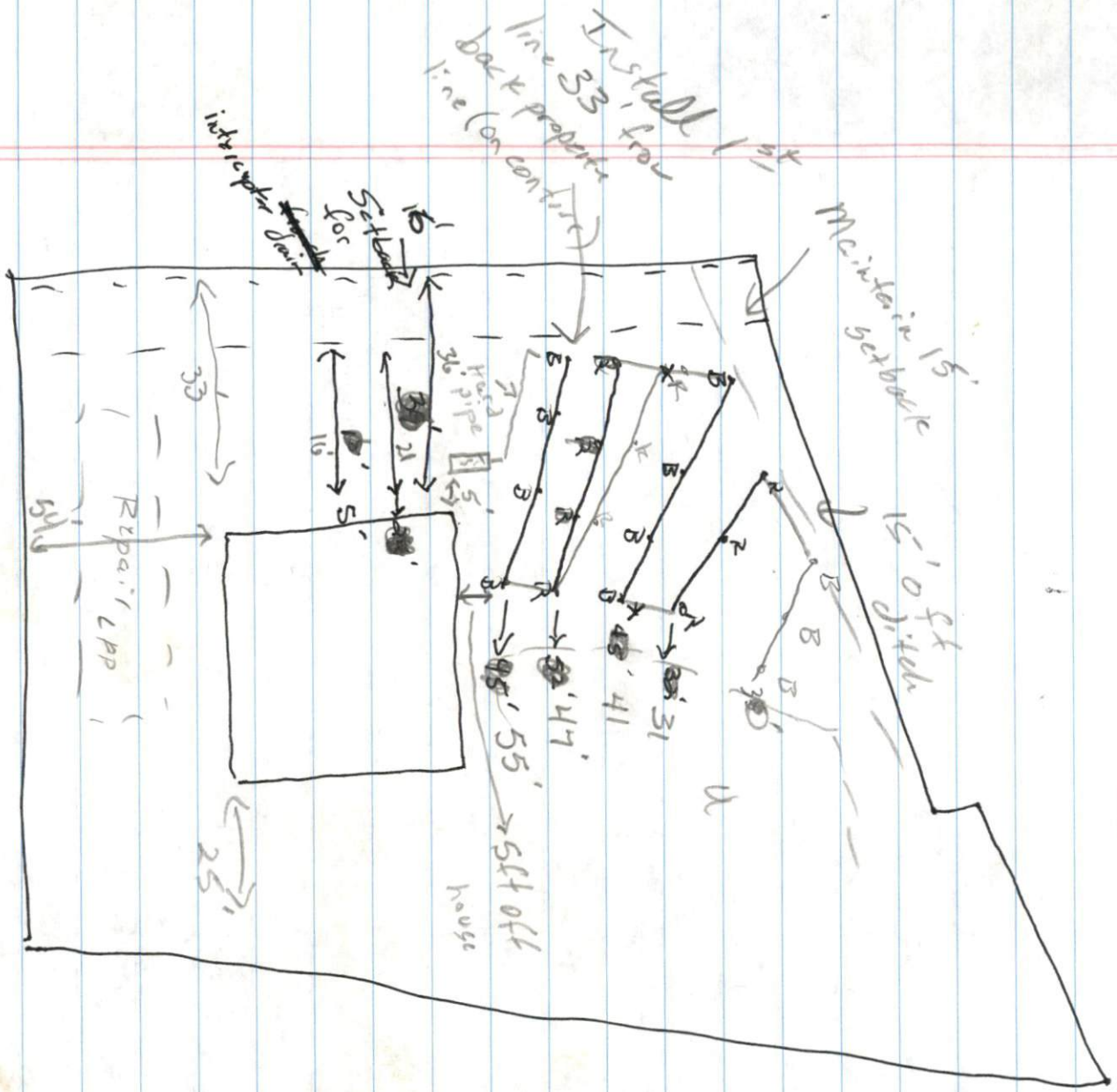

Skinner Fire's Private

Meet on-site before installation

install 6" need 6" cover

install lines as listed on sketch

Maintain all setbacks

Any questions, please call



11/12/14

11/12/14

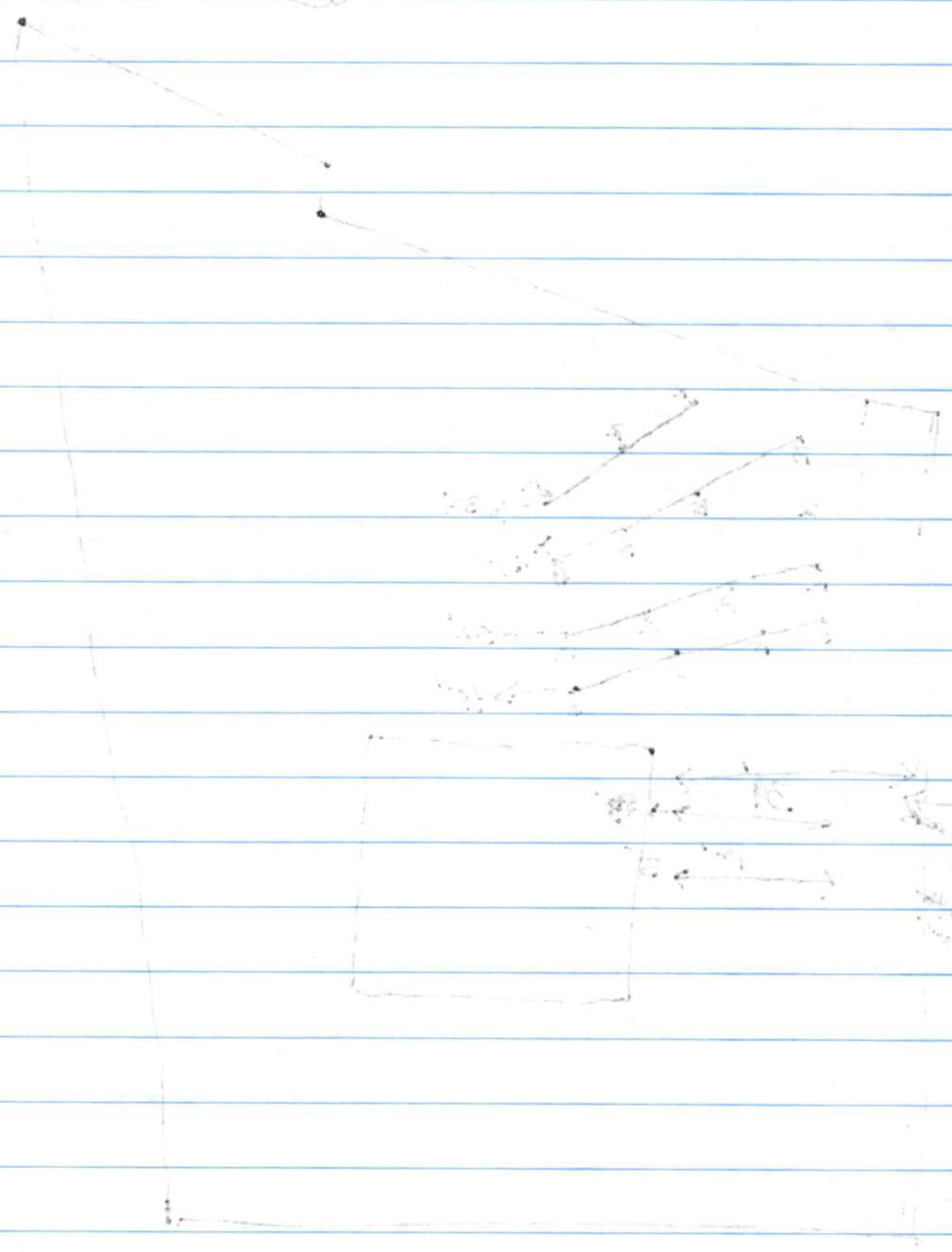

11/12/14