

Initial Application Date: 3.6.07

Application # 07.50017044
1367185

COUNTY OF HARNETT LAND USE APPLICATION

Central Permitting

102 E. Front Street, Lillington, NC 27546

Phone: (910) 893-4759

Fax: (910) 893-2793

LANDOWNER: LAMBERT HUMES, INC. Mailing Address: P.O. Box 1329
City: FUQUAY-VARINA State: N.C. Zip: 27526 Phone #: (919) 557-3686
(919) 868-3970

APPLICANT: SAME Mailing Address: _____
City: _____ State: _____ Zip: _____ Phone #: _____

PROPERTY LOCATION: SR #: 1434 SR Name: BRUCE JOHNSON ROAD
Parcel: 11.0661.0100.34 PIN: 0651-81-2122-60-1844
Zoning: RA-30 Subdivision: JOHNSON FARMS Lot #: 36 Lot Size: 17425 sq ft
Flood Plain: RA Panel: AVAIL Watershed: II Deed Book/Page: ~~200-2122-60~~ Plat Book/Page: 2006-0184
OTP

DIRECTIONS TO THE PROPERTY FROM LILLINGTON: TAKE 210 N. TOWARDS HARNETT CENTRAL -
FROM 421 AT McDONALDS GO ABOUT 1 MILE TAKE LEFT ON BRUCE JOHNSON
Rd.

PROPOSED USE:

- Sg. Family Dwelling (Size 50 x 47.6) # of Bedrooms 3 # Baths 2 Basement (w/wo bath) Garage 20'9" x 20'7" Deck 35 sq ft
- Multi-Family Dwelling No. Units _____ No. Bedrooms/Unit _____
- Manufactured Home (Size _____ x _____) # of Bedrooms _____ Garage _____ Deck _____
- Comments: included
- Number of persons per household _____
- Business Sq. Ft. Retail Space _____ Type _____
- Industry Sq. Ft. _____ Type _____
- Home Occupation (Size _____ x _____) # Rooms _____ Use _____
- Accessory Building (Size _____ x _____) Use _____
- Addition to Existing Building (Size _____ x _____) Use _____
- Other _____

Water Supply: County Well (No. dwellings _____) Other _____

Sewage Supply: New Septic Tank Existing Septic Tank County Sewer Other _____

Erosion & Sedimentation Control Plan Required? YES NO

Structures on this tract of land: Single family dwellings _____ Manufactured homes _____ Other (specify) N/A

Property owner of this tract of land own land that contains a manufactured home w/in five hundred feet (500') of tract listed above? YES NO

Required Property Line Setbacks:	Minimum	Actual	Minimum	Actual
Front	<u>35'</u>	<u>35'</u>	Rear	<u>25'</u>
Side	<u>10'</u>	<u>36'</u>	Corner	<u>20'</u>
Nearest Building	<u>—</u>	<u>—</u>		<u>—</u>

If permits are granted I agree to conform to all ordinances and the laws of the State of North Carolina regulating such work and the specifications or plans submitted. I hereby swear that the foregoing statements are accurate and correct to the best of my knowledge.

L. Brent Lohst
Signature of Applicant

3-6-07
Date

This application expires 6 months from the date issued if no permits have been issued

A RECORDED SURVEY PLAT AND RECORDED DEED ARE REQUIRED WHEN APPLYING FOR A LAND USE PERMIT

3/7 N

Lambert Homes, Inc.

Lot # 36	Subdivision: Johnson Farms
Address: Bruce Johnson Rd. LITTLETON, N.C.	
Recorded - Book: 2006	Page: 986-988 Tax Map: 0651-81-2122
Zoning: RA-30	Lot Size: 17,425 sq.ft. Scale: 1" = 100'

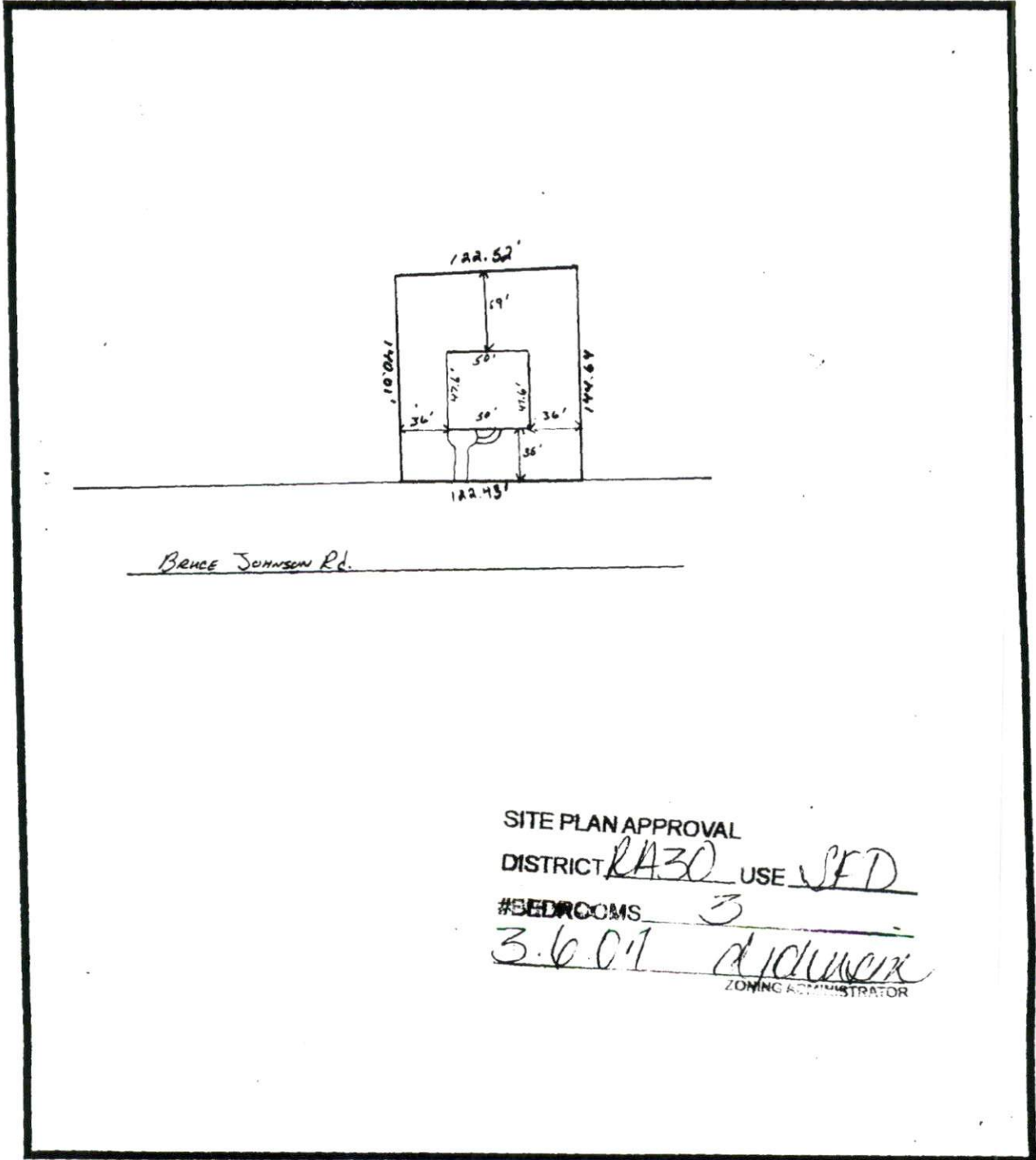

Bruce Johnson Rd.

SITE PLAN APPROVAL
DISTRICT RA30 USE SFD
#BEDROOMS 3
3.6.01 [Signature]
ZONING ADMINISTRATOR

OWNER NAME: LAMBERT HOMES, INC

APPLICATION #: 01-50017042
01-50017043
01-50017044

This application to be filled out only when applying for a new septic system.

County Health Department Application for Improvement Permit and/or Authorization to Construct

IF THE INFORMATION IN THIS APPLICATION IS FALSIFIED, CHANGED, OR THE SITE IS ALTERED, THEN THE IMPROVEMENT PERMIT OR AUTHORIZATION TO CONSTRUCT SHALL BECOME INVALID. The permit is valid for either 60 months or without expiration depending upon documentation submitted. (complete site plan = 60 months; complete plat = without expiration)

DEVELOPMENT INFORMATION

- New single family residence
- Expansion of existing system
- Repair to malfunctioning sewage disposal system
- Non-residential type of structure

WATER SUPPLY

- New well
- Existing well
- Community well
- Public water
- Spring

Are there any existing wells, springs, or existing waterlines on this property?

yes no unknown

SEPTIC

If applying for authorization to construct please indicate desired system type(s): can be ranked in order of preference, must choose one.

- Accepted Innovative
- Alternative Other
- Conventional Any

The applicant shall notify the local health department upon submittal of this application if any of the following apply to the property in question. If the answer is "yes", applicant must attach supporting documentation.

- YES NO Does the site contain any Jurisdictional Wetlands?
- YES NO Does the site contain any existing Wastewater Systems?
- YES NO Is any wastewater going to be generated on the site other than domestic sewage?
- YES NO Is the site subject to approval by any other Public Agency?
- YES NO Are there any easements or Right of Ways on this property?
- YES NO Does the site contain any existing water, cable, phone or underground electric lines?

If yes please call No Cuts at 800-632-4949 to locate the lines. This is a free service.

I Have Read This Application And Certify That The Information Provided Herein Is True, Complete And Correct. Authorized County And State Officials Are Granted Right Of Entry To Conduct Necessary Inspections To Determine Compliance With Applicable Laws And Rules.

I Understand That I Am Solely Responsible For The Proper Identification And Labeling Of All Property Lines And Corners And Making The Site Accessible So That A Complete Site Evaluation Can Be Performed.

[Signature]
PROPERTY OWNERS OR OWNERS LEGAL REPRESENTATIVE SIGNATURE (REQUIRED)

3-6-07
DATE

Application Number: 07-50017042

Harnett County Central Permitting Department
PO Box 65, Lillington, NC 27546
910-893-7525

07-50017043
07-50017044

Environmental Health New Septic Systems Test
Environmental Health Code 800

- Place "property flags" on each corner iron of lot. All property lines must be clearly flagged approximately every 50 feet between corners.
- Place "house corner flags" at each corner of where the house/manufactured home will sit. Use additional flagging to outline driveways, garages, decks, out buildings, swimming pools, etc.
- Place flags at locations as developed on site plan by Customer Service Technician and you.
- Place Environmental Health "orange" card in location that is easily viewed from road.
- If property is thickly wooded, Environmental Health requires that you clean out the undergrowth to allow the soil evaluation to be performed. Inspectors should be able to walk freely around site. *No grading of property should be done.*
- Call No Cuts to locate utility lines prior to scheduling inspection. 800-632-4949 (This is a free service)
- After preparing proposed site call the voice permitting system at 910-893-7525 and give code **800** for Environmental Health confirmation. **Please note confirmation number given at end of recording for proof of request.**
- Use Click2Gov or IVR to hear results. Once approved, proceed to Central Permitting for permits.

Environmental Health Existing Tank Inspections
Environmental Health Code 800

- Place Environmental Health "orange" card in location that is easily viewed from road. Follow above instructions for placing flags on property.
- Prepare for inspection by removing soil over door as diagram indicates. Loosen trap door cover. (Unless inspection is for a septic tank in a mobile home park)
- After preparing trapdoor call the voice permitting system at 910-893-7525 and give code **800** for Environmental Health confirmation. **Please note confirmation number given at end of recording for proof of request.**
- Use Click2Gov or IVR to hear results. Once approved, proceed to Central Permitting for remaining permits.

Health and Sanitation Inspections

- After submitting plans for food and lodging to Central Permitting, please allow approximately 7-10 working days for plan status. Use Click2Gov or IVR to hear results.
- Once all plans are approved, proceed to Central Permitting for remaining permits.

Fire Marshal Inspections

- After submitting plans for Fire Marshal review to Central Permitting, please allow approximately 7-10 working days for approval. Use Click2Gov or IVR to hear results. Once all plans are approved, proceed to Central Permitting for permits.
- Fire Marshal's letter must be placed on job site until work is completed.

Public Utilities

- Place stake with "orange" tape/name thirty feet (30) from the center of the road at the location you wish to have water tap installed.
- Allow four to six weeks after application for water/sewer taps. Call Utilities at 893-7575 for technical assistance.

Building Inspections

- After submitting plans for Building Inspections, please allow approximately 3 working days for review. Use Click2Gov or IVR to hear results. Once all plans are approved, proceed to Central Permitting for permits.
- For new housing/set up permits must meet E 911 / Addressing guidelines prior to scheduling final inspection.
- Use Click2Gov or IVR to hear results.

E911 Addressing

- **Addressing Confirmation Code 814**
- Address numbers shall be mounted on the house, 3 inches high (5" for commercial).
- Numbers must be a contrasting color from house, must be clearly visible night and day at entrance of driveway if home is 100 ft or more from road, or if mailbox is on opposite side of road.
- Once you purchase permits and footing inspection has been approved call the voice permitting system at 910-893-7525 and give code **814** for address confirmation. This must be called in even if you have contacted E911 for verbal confirmation. Check Click2Gov for results and address.

• Inspection results can be viewed online at <http://www.harnett.org/services-213.asp> then select Click2Gov

Applicant/Owner Signature [Signature] Date 3-6-07