

### Improvement Permit

A building permit cannot be issued with only an Improvement Permit

ISSUED TO: Lonnie Jones PROPERTY LOCATION: Old 421  
 SUBDIVISION Shaylah's Knoll LOT # 4  
 NEW  REPAIR  EXPANSION  Site Improvements required prior to Construction Authorization Issuance:  
 Type of Structure: SFO - 51x60 3BR  
 Proposed Wastewater System Type: Pump to 25% Reduction system  
 Projected Daily Flow: 360 GPD  
 Number of bedrooms: 3 Number of Occupants: 6 max  
 Basement  Yes  No  
 Pump Required:  Yes  No  May be required based on final location and elevations of facilities  
 Type of Water Supply:  Community  Public  Well Distance from well 50 feet Permit valid for:  Five years  
 Permit conditions: meat onsite maintain all set backs  No expiration  
STUB out Plumbing shallow, At ground level or higher, where shown and  
if 18 to 24" o.tch depths can be maintained then pump may not be needed

Authorized State Agent: Ju WARR Date: 02.22.07 SEE ATTACHED SITE SKETCH  
 The issuance of this permit by the Health Department in no way guarantees the issuance of other permits. The permit holder is responsible for checking with appropriate governing bodies in meeting their requirements. This site is subject to revocation if the site plan, plat, or the intended use changes. The Improvement Permit shall not be affected by a change in ownership of the site. This permit is subject to compliance with the provisions of the Laws and Rules for Sewage Treatment and Disposal and to conditions of this permit.

### Construction Authorization

(Required for Building Permit)

The construction and installation requirements of Rules .1950, .1952, .1954, .1955, .1956, .1957, .1958, and .1959 are incorporated by references into this permit and shall be met. Systems shall be installed in accordance with the attached system layout.

ISSUED TO: Lonnie Jones PROPERTY LOCATION: Old 421  
 SUBDIVISION Shaylah's Knoll LOT # 4  
 Facility Type: SFO - 51x60 3BR  New  Expansion  Repair  
 Basement?  Yes  No Basement Fixtures?  Yes  No  
 Type of Wastewater System\*\* Pump to 25% Red. Sys. (Initial) Wastewater Flow: 360 GPD  
 (See note below, if applicable  290 LF of LPP (Repair))

**Installation Requirements/Conditions**

Septic Tank Size <u>1000</u> gallons	Exact length of each trench <u>3x60</u> <del>4x80</del> feet	Trench Spacing: <u>9</u> Feet on Center
Pump Tank Size <u>1000</u> gallons	Trenches shall be installed on contour at a Maximum Trench Depth of: <u>18.24</u> inches (Trench bottoms shall be level to +1-1/4" in all directions)	Soil Cover: <u>6</u> inches (Maximum soil cover shall not exceed 36" above the trench bottom)
Pump Requirements: _____ ft. TDH vs. _____ GPM Conditions: _____		Aggregate Depth: _____ inches below pipe _____ inches above pipe _____ inches total

*→ If needed*

**\*\*If applicable:** *I understand the system type specified is different from the type specified on the application. I accept the specifications of this permit.*

Owner/Legal Representative Signature: \_\_\_\_\_ Date: \_\_\_\_\_

This Construction Authorization is subject to revocation if the site plan, plat, or the intended use changes. The Construction Authorization shall not be transferred when there is a change in ownership of the site. This Construction Authorization is subject to compliance with the provisions of the Laws and Rules for Sewage Treatment and Disposal and to the conditions of this permit.

Authorized State Agent: Ju WARR Date: 02.22.07 SEE ATTACHED SITE SKETCH  
 Construction Authorization Expiration Date: 02.22.2012

HTE# 07-50016799

Permit # 23666

# Harnett County Department of Public Health Site Sketch

PROPERTY LOCATOR: Old 421

ISSUED TO: Lonnie Jones

SUBDIVISION Shaylans Knoll

LOT # 4

Authorized State Agent: *J. W. [Signature]*

Date: 02-22-07

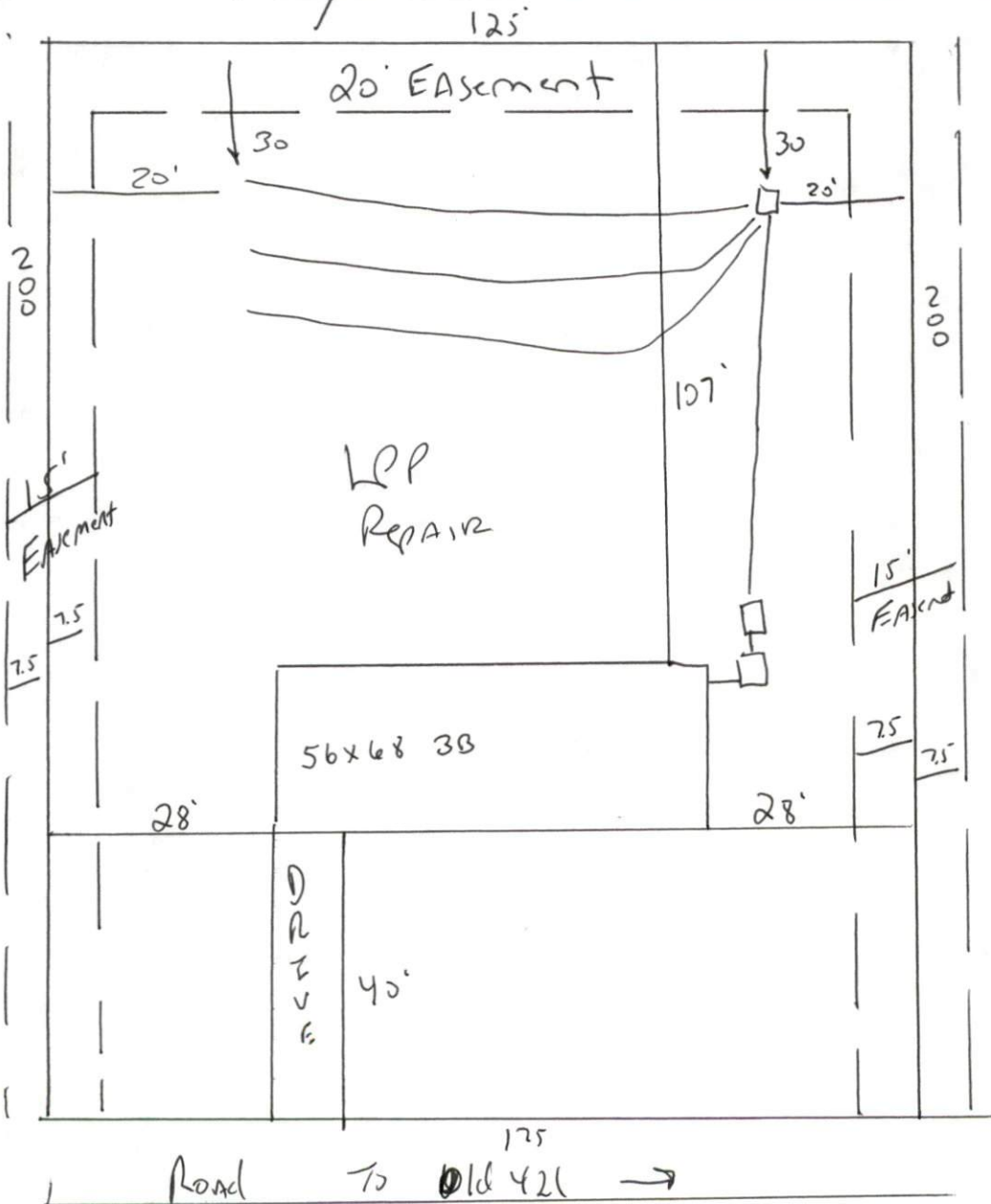

Meet onsite  
 Maintain all  
 set back - including  
 set backs from easements  
 Stub out Plumbing  
 shallow, at ground level  
 or higher, where shown  
 And, 18 to 24"  
 Ditch Depth can be  
 maintained then  
 Pump may not be  
 required.  
 Install 3x60  
 of 25% Reduction system  
 at 18 to 24" Deep.  
 May install as 1x180  
 of 25% Reduction system