

HTE# 07-5-16737 RR Harnett County Department of Public Health

PERMIT # 25659

Operation Permit

21658

New Installation Septic Tank Nitrification Line Repair Expansion

PROPERTY LOCATION: Lemuel Black Rd

Name: (owner) Howell Edwards SUBDIVISION Gate west LOT # 11

System Installer: O Strickland Registration # _____

Basement with plumbing: Garage Number of Bedrooms 3

Type of Water Supply: Community Public Well Distance from well 100 feet

System Type: Pump to E-2 Flow Types V and VI Systems expire in 5 years.

(In accordance with Table V a) Owner must contact Health Department 6 months prior to expiration for permit renewal.

This system has been installed in compliance with applicable North Carolina General Statutes, Rules for Sewage Treatment and Disposal, and all conditions of the Improvement Permit and Construction Authorization.

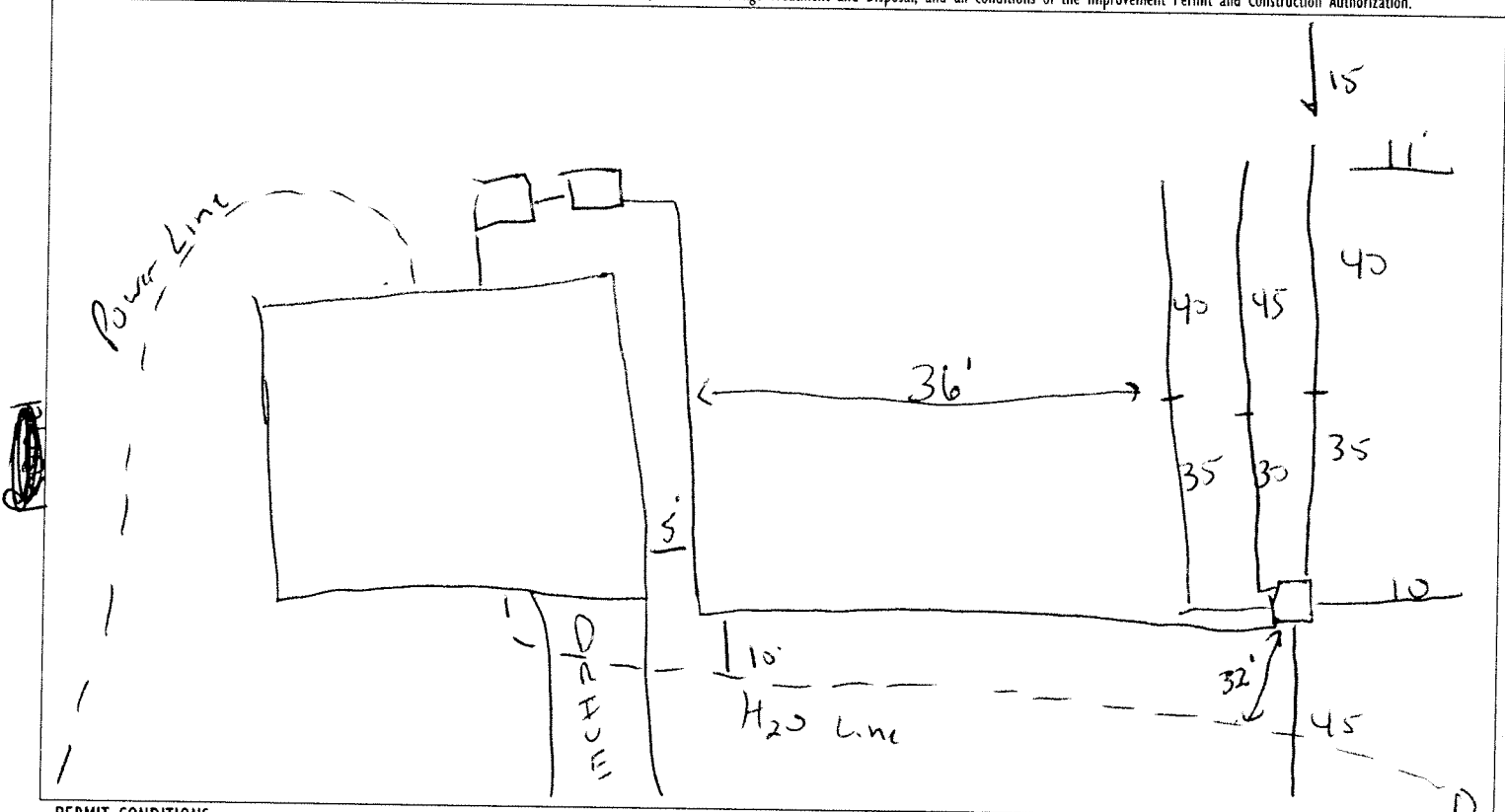

PERMIT CONDITIONS:

- I. Performance: System shall perform in accordance with Rule .1961.
- II. Monitoring: As required by Rule .1961.
- III. Maintenance: As required by Rule .1961. Other: _____
Subsurface system operator required? Yes No
If yes, see attached sheet for additional operation conditions, maintenance and reporting.
- IV. Operation: _____
- V. Other: _____

D-Box Pump Alarm H2O Line PWR Line

Following are the specifications for the sewage disposal system on the above captioned property.

Type of system: Conventional Other Pump to E-2 Flow Septic Tank: 1000 gallons Pump Tank: 1000 gallons
Subsurface Drainage Field No. of ditches 3 exact length of each ditch 75 feet width of ditches 3 feet depth of ditches 18 inches
French Drain Required: _____ Linear feet

Authorized State Agent Joe West RPHS Date 10-21-10

HTE# 07-S-16737RR

Permit # 25257

Harnett County Department of Public Health Site Sketch

ISSUED TO: HOWEL LOWMEYER PROPERTY LOCATOR: LEWELL BLACK RD
SUBDIVISION: GATEWAY LOT # 11

Authorized State Agent: [Signature] Date: 8/31/07

