

Improvement Permit

A building permit cannot be issued with only an Improvement Permit

ISSUED TO: CAVINNESS O CATES

PROPERTY LOCATION: 1141
SUBDIVISION: The Summit

NEW REPAIR EXPANSION
Type of Structure: SFO 52x56 @ 4 BR

Site Improvements required prior to Construction Authorization

Proposed Wastewater System Type: 25% Reduction syst

Projected Daily Flow: 400 GPD

Number of bedrooms: 4 Number of Occupants: 8 max

Basement Yes No

Pump Required: Yes No May be required based on final location and elevations of facilities

Type of Water Supply: Community Public Well Distance from well 50 feet Permit valid for:

Permit conditions: Meet onsite for final layout
STUB Plumbing out shallow, At ground level or higher, where shown
MAINTAIN ALL SETBACKS

Authorized State Agent: Joe Waters Date: 02-14-07 SEE ATTACHED

The issuance of this permit by the Health Department in no way guarantees the issuance of other permits. The permit holder is responsible for checking with appropriate gove their requirements. This site is subject to revocation if the site plan, plat, or the intended use changes. The Improvement Permit shall not be affected by a change in ownershi permit is subject to compliance with the provisions of the Laws and Rules for Sewage Treatment and Disposal and to conditions of this permit.

Construction Authorization

(Required for Building Permit)

The construction and installation requirements of Rules .1950, .1952, .1954, .1955, .1956, .1957, .1958, and .1959 are incorporated by references into this permit and shall b installed in accordance with the attached system layout.

ISSUED TO: CAVINNESS O CATES PROPERTY LOCATION: 1141
SUBDIVISION: The Summit

Facility Type: SFO - 52x56 - 4 BR New Expansion Repair

Basement? Yes No Basement Fixtures? Yes No

Type of Wastewater System** 25% Reduction syst (Initial) Wastewater Flow: 400 GPD

(See note below, if applicable) 300 LF of LPP (Repair)

Installation Requirements/Conditions

Septic Tank Size 1000 gallons Exact length of each trench 1x210 feet Trench Spacing: 9 Feet

Pump Tank Size _____ gallons Trenches shall be installed on contour at a Soil Cover: 6 inches

Maximum Trench Depth of: 18.24 inches (Maximum soil cover shall not ex 36" above the trench bottom) in all directions)

Pump Requirements: _____ ft. TDH vs. _____ GPM

Aggregate Depth: _____

Conditions: _____

**If applicable: I understand the system type specified is different from the type specified on the application. I accept the specification.

Owner/Legal Representative Signature: _____ Date: _____

This Construction Authorization is subject to revocation if the site plan, plat, or the intended use changes. The Construction Authorization shall not be transferred when there is of the site. This Construction Authorization is subject to compliance with the provisions of the Laws and Rules for Sewage Treatment and Disposal and to the conditions of this

Authorized State Agent: Joe Waters Date: 02-14-07 SEE ATTACHED

Construction Authorization Expiration Date: 02-14-2012

HTE# 07-500 16520n

Permit # 23652

Harnett County Department of Public Health Site Sketch

ISSUED TO: CAVINSON SCATER

PROPERTY LOCATOR: 1141

SUBDIVISION The Summit

LOT

Authorized State Agent: J. [Signature]

Date: 02-14-07

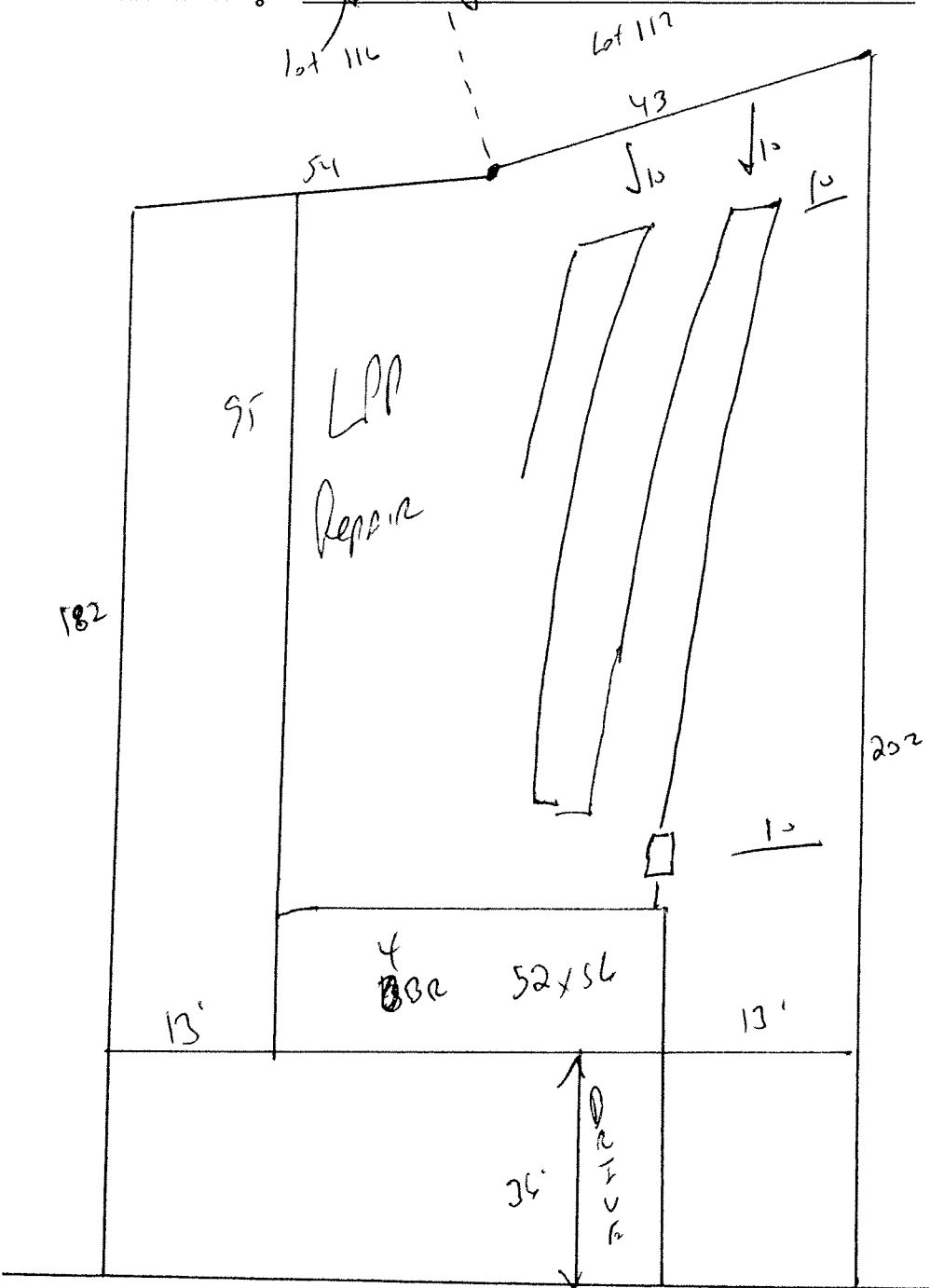

STUB OUT F
 SHALLOW AT 8'
 OR HIGHER, WHO
 MAINTAIN ALL
 INSTALL 1x210-
 REDUCTION SYSTEM
 18 TO 24"

Cavinton Road