

**Improvement Permit**

A building permit cannot be issued with only an Improvement Permit

ISSUED TO: Caviness & Cates  
NEW  REPAIR  EXPANSION   
Type of Structure: SFD - 56x64 4 BR  
Proposed Wastewater System Type: 25% Reduction System  
Projected Daily Flow: 480 GPD  
Number of bedrooms: 4 Number of Occupants: 8 max

PROPERTY LOCATION: 1141  
SUBDIVISION: The Summit  
Site Improvements required prior to Construction Authorization

Basement  Yes  No  
Pump Required:  Yes  No  May be required based on final location and elevations of facilities  
Type of Water Supply:  Community  Public  Well Distance from well 50 feet Permit valid for: 5  
Permit conditions: STUB out Plumbing shallow where shown (at ground level or higher) MAINTAIN ALL SETBACKS meet code

Authorized State Agent: [Signature] Date: 01-17-07 SEE ATTACHED  
The issuance of this permit by the Health Department in no way guarantees the issuance of other permits. The permit holder is responsible for checking with appropriate government requirements. This site is subject to revocation if the site plan, plat, or the intended use changes. The Improvement Permit shall not be affected by a change in ownership. This permit is subject to compliance with the provisions of the Laws and Rules for Sewage Treatment and Disposal and to conditions of this permit.

**Construction Authorization**

(Required for Building Permit)

The construction and installation requirements of Rules .1950, .1952, .1954, .1955, .1956, .1957, .1958, and .1959 are incorporated by references into this permit and shall be installed in accordance with the attached system layout.

ISSUED TO: Caviness & Cates PROPERTY LOCATION: 1141  
SUBDIVISION: The Summit  
Facility Type: SFD - 56x64 - 4 BR  New  Expansion  Repair  
Basement?  Yes  No Basement Fixtures?  Yes  No  
Type of Wastewater System\*\* 25% Reduction System (Initial) Wastewater Flow: 480 GPD  
(See note below, if applicable)  325 LF of LPP (Repair)

**Installation Requirements/Conditions**

Septic Tank Size 1000 gallons Exact length of each trench 1x210 feet Trench Spacing: 9 Feet  
Pump Tank Size \_\_\_\_\_ gallons Trenches shall be installed on contour at a Soil Cover: 6 inches  
Maximum Trench Depth of: 18-24 inches (Maximum soil cover shall not exceed 36" above the trench bottom)  
(Trench bottoms shall be level to +/- 1/4" in all directions)

Pump Requirements: \_\_\_\_\_ ft. TDH vs. \_\_\_\_\_ GPM Aggregate Depth: \_\_\_\_\_

Conditions: \_\_\_\_\_

\*\*If applicable: I understand the system type specified is different from the type specified on the application. I accept the specification.

Owner/Legal Representative Signature: \_\_\_\_\_ Date: \_\_\_\_\_

This Construction Authorization is subject to revocation if the site plan, plat, or the intended use changes. The Construction Authorization shall not be transferred when there is a change of ownership. This Construction Authorization is subject to compliance with the provisions of the Laws and Rules for Sewage Treatment and Disposal and to the conditions of this permit.

Authorized State Agent: [Signature] Date: 01-19-07 SEE ATTACHED

Construction Authorization Expiration Date: 01-19-2012

HTE# 07-50016518

Permit # 23607

# Harnett County Department of Public Health Site Sketch

ISSUED TO: CAVIN, Q CATE

PROPERTY LOCATOR: 1141

SUBDIVISION The Summit

LOT

Authorized State Agent: Joe L...

Date: 01-19-07

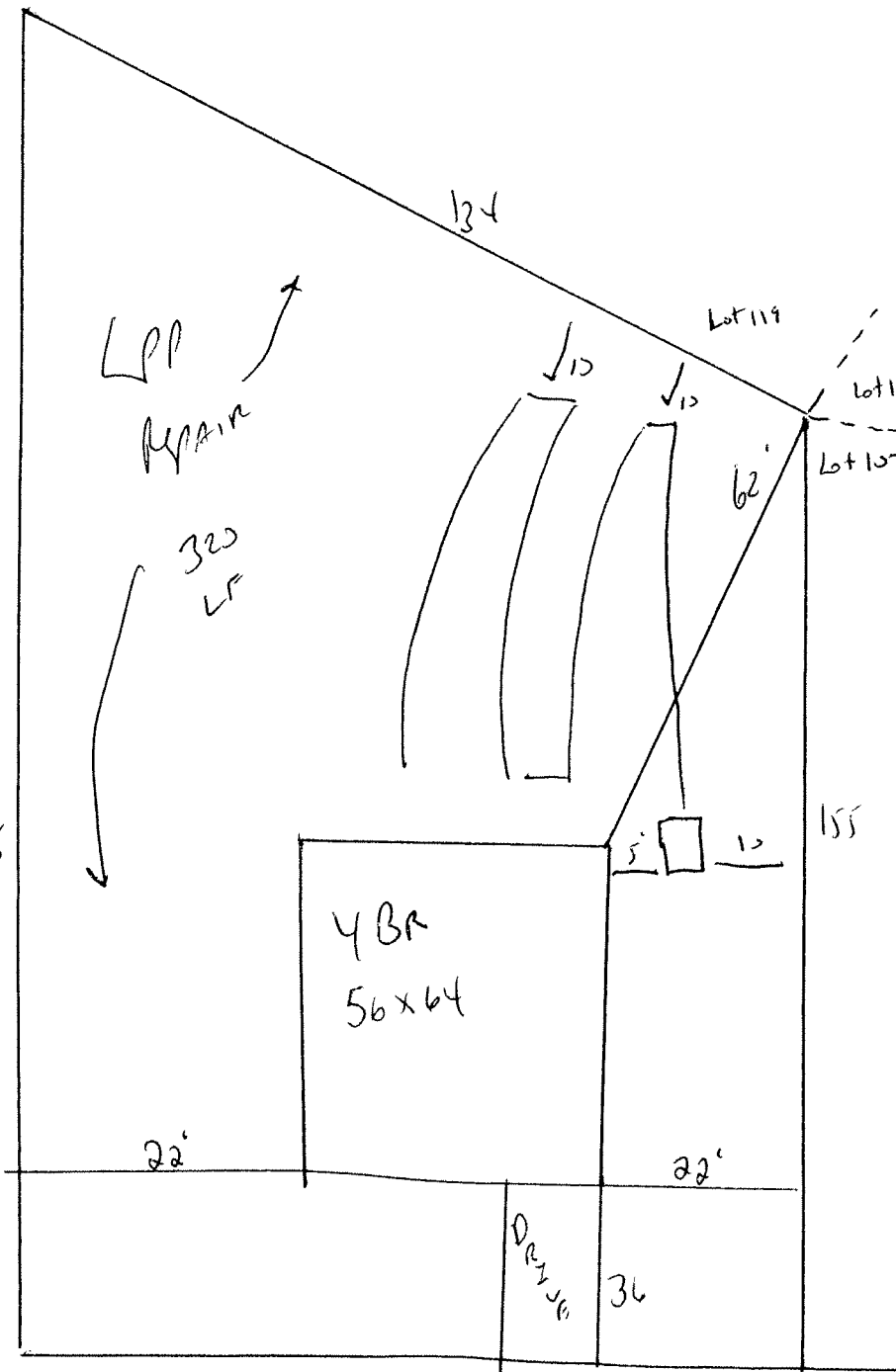

STUB OUT  
 shallow  
 Cat ground  
 maintain  
 set back  
 meet  
 install  
 425% K  
 SYSTEM  
 18' to 25'

02 95