

HTE# 07-500/6496

Harnett County Department of Public Health

23449

Improvement Permit

A building permit cannot be issued with only an Improvement Permit

ISSUED TO: ISRAEL LUCAS PROPERTY LOCATION: 1139
 SUBDIVISION: Tingen Place LOT # 62
 Type of Structure: SFO 52x68 3BR Site Improvements required prior to Construction Authorization Issuance:
 NEW REPAIR EXPANSION
 Proposed Wastewater System Type: Pump to Conventional
 Projected Daily Flow: 360 GPD
 Number of bedrooms: 3 Number of Occupants: 6 max
 Basement Yes No
 Pump Required: Yes No May be required based on final location and elevations of facilities
 Type of Water Supply: Community Public Well Distance from well _____ feet Permit valid for: Five years No expiration
 Permit conditions: STUB out Plumbing shallow (At Ground level or higher) and Pump may not be required. Meet on site for final layout - may be able to use 25% reduction system to get out of pump.

Authorized State Agent: Ju Lucas Date: 01-08-07 SEE ATTACHED SITE SKETCH
 The issuance of this permit by the Health Department in no way guarantees the issuance of other permits. The permit holder is responsible for checking with appropriate governing bodies in meeting their requirements. This site is subject to revocation if the site plan, plat, or the intended use changes. The Improvement Permit shall not be affected by a change in ownership of the site. This permit is subject to compliance with the provisions of the Laws and Rules for Sewage Treatment and Disposal and to conditions of this permit.

Construction Authorization

(Required for Building Permit)

The construction and installation requirements of Rules .1950, .1952, .1954, .1955, .1956, .1957, .1958, and .1959 are incorporated by references into this permit and shall be met. Systems shall be installed in accordance with the attached system layout.

ISSUED TO: ISRAEL LUCAS PROPERTY LOCATION: 1139
 SUBDIVISION: Tingen Place LOT # 62
 Facility Type: SFO-52x68-3BR New Expansion Repair
 Basement? Yes No Basement Fixtures? Yes No
 Type of Wastewater System** Pump to Conventional (Initial) Wastewater Flow: 360 GPD
 (See note below, if applicable) 240 LF of LPP (Repair)

Installation Requirements/Conditions

Septic Tank Size 1000 gallons Exact length of each trench 1x200 feet Trench Spacing: 9 Feet on Center
 Pump Tank Size 1000 gallons Trenches shall be installed on contour at a Soil Cover: 6 inches
 ↪ If Needed Maximum Trench Depth of: 18-24 inches (Maximum soil cover shall not exceed 36" above the trench bottom)
 (Trench bottoms shall be level to +/-1/4" in all directions)
 Pump Requirements: _____ ft. TDH vs. _____ GPM Aggregate Depth: 6 inches below pipe
 Conditions: _____ 2 inches above pipe
 _____ 12 inches total

**If applicable: I understand the system type specified is different from the type specified on the application. I accept the specifications of this permit.

Owner/Legal Representative Signature: _____ Date: _____

This Construction Authorization is subject to revocation if the site plan, plat, or the intended use changes. The Construction Authorization shall not be transferred when there is a change in ownership of the site. This Construction Authorization is subject to compliance with the provisions of the Laws and Rules for Sewage Treatment and Disposal and to the conditions of this permit.

Authorized State Agent: Ju Lucas Date: 01-08-07 SEE ATTACHED SITE SKETCH
 Construction Authorization Expiration Date: 01-08-2012

HTE# 07-50016494

Permit # 23449

Harnett County Department of Public Health Site Sketch

ISSUED TO: Israel Lucas PROPERTY LOCATOR: 1139
SUBDIVISION: Tinjan Place LOT # 62

Authorized State Agent: J. Lucas Date: 01-08-07

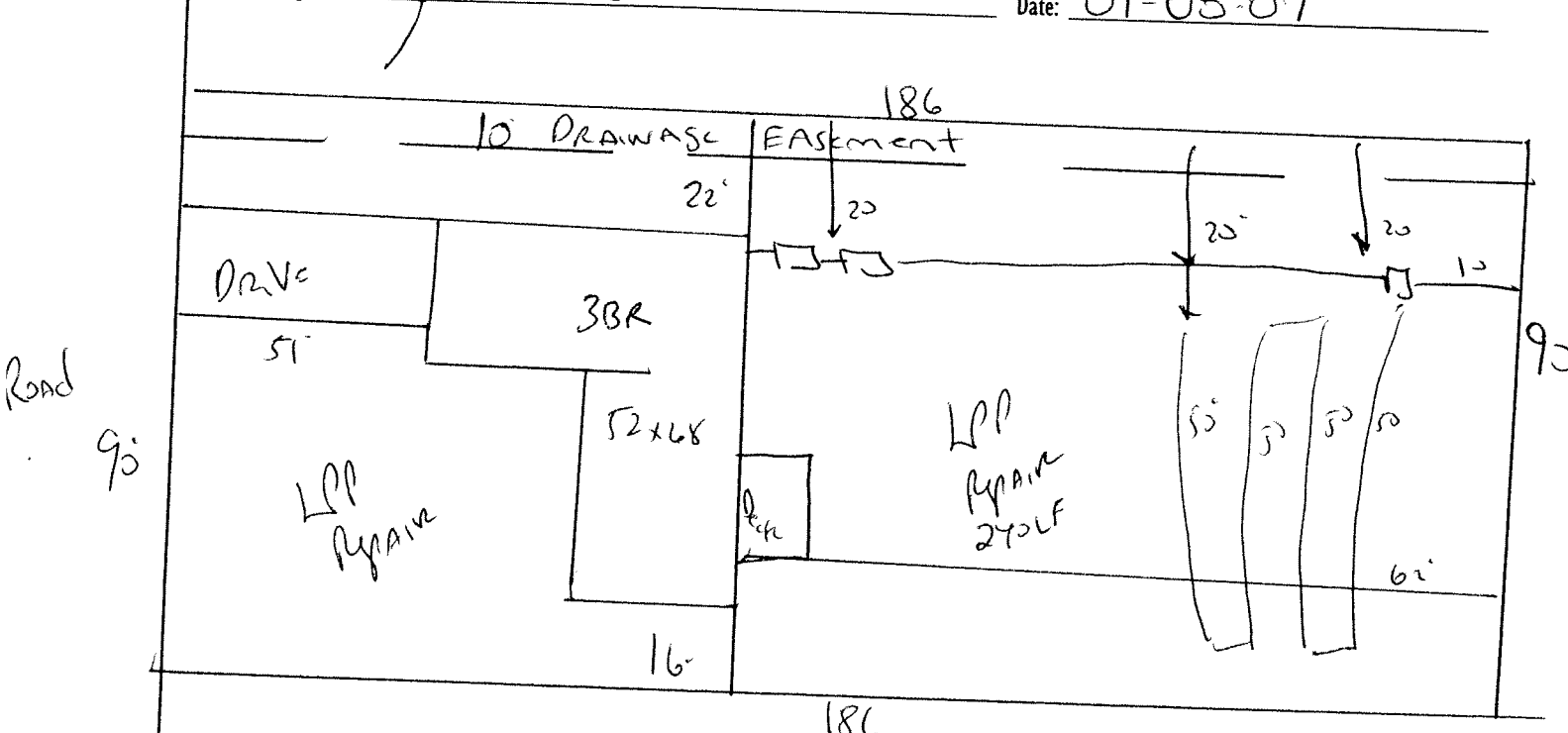

STUB out Plumbing shallow, (At ground level or higher) where shown and Pump may not be Required. MAY use 25% reduction system. ~~•~~ ~~•~~ MUST meet onsite before installing syptic system keep drain lines 20' from property lines with EASEMENT Along it. (If pumped, supply line can be 15' from property line with EASEMENT) MAINTAIN ALL setBacks