

HTE# 06-50016458 Harnett County Department of Public Health 23641

Improvement Permit

A building permit cannot be issued with only an Improvement Permit

ISSUED TO: CUSTOM Contracting PROPERTY LOCATION: 1201
 NEW REPAIR EXPANSION SUBDIVISION: CAROLINA SEASONS LOT # 7-7
 Type of Structure: SFD-54x56 3BR Site Improvements required prior to Construction Authorization Issuance:
 Proposed Wastewater System Type: GRAVEL
 Projected Daily Flow: 360 GPD
 Number of bedrooms: 3 Number of Occupants: 6 max
 Basement Yes No
 Pump Required: Yes No May be required based on final location and elevations of facilities
 Type of Water Supply: Community Public Well Distance from well 50 feet Permit valid for: Five years
 Permit conditions: STUB out plumbing shallow - AT ground level or higher No expiration
maintain all s+backs

Authorized State Agent: [Signature] Date: 02-01-07 32257 SEE ATTACHED SITE SKETCH
 The issuance of this permit by the Health Department in no way guarantees the issuance of other permits. The permit holder is responsible for checking with appropriate governing bodies in meeting their requirements. This site is subject to revocation if the site plan, plat, or the intended use changes. The Improvement Permit shall not be affected by a change in ownership of the site. This permit is subject to compliance with the provisions of the Laws and Rules for Sewage Treatment and Disposal and to conditions of this permit.

Construction Authorization

(Required for Building Permit)

The construction and installation requirements of Rules .1950, .1952, .1954, .1955, .1956, .1957, .1958, and .1959 are incorporated by references into this permit and shall be met. Systems shall be installed in accordance with the attached system layout.

ISSUED TO: CUSTOM Contracting PROPERTY LOCATION: 1201
 Facility Type: SFD-54x56 3BR New Expansion Repair
 Basement? Yes No Basement fixtures? Yes No
 Type of Wastewater System** GRAVEL (Initial) Wastewater Flow: 360 GPD
 (See note below, if applicable) 243 LF of VAP (Repair)

Installation Requirements/Conditions

Septic Tank Size 1000 gallons Exact length of each trench 1x20 feet Trench Spacing: 9 Feet on Center
 Pump Tank Size _____ gallons Trenches shall be installed on contour at a Soil Cover: 6 inches
 Maximum Trench Depth of: 18-24 inches (Maximum soil cover shall not exceed 36" above the trench bottom)
 (Trench bottoms shall be level to +/-1/4" in all directions)
 Pump Requirements: _____ ft. TDH vs. _____ GPM Aggregate Depth: 6 inches below pipe
 Conditions: _____ 2 inches above pipe
12 inches total

**If applicable: *I understand the system type specified is different from the type specified on the application. I accept the specifications of this permit.*

Owner/Legal Representative Signature: _____ Date: _____

This Construction Authorization is subject to revocation if the site plan, plat, or the intended use changes. The Construction Authorization shall not be transferred when there is a change in ownership of the site. This Construction Authorization is subject to compliance with the provisions of the Laws and Rules for Sewage Treatment and Disposal and to the conditions of this permit.

Authorized State Agent: [Signature] Date: 02-01-07 32257 SEE ATTACHED SITE SKETCH
 Construction Authorization Expiration Date: 07-01-2012 3-23-2012

HTE# 06-50016458R

Permit # 23641

Harnett County Department of Public Health Site Sketch

ISSUED TO: Custom Contracting

PROPERTY LOCATOR: 1201
SUBDIVISION: CAROLINA SEASONS LOT # 77

Authorized State Agent: J. WARR J-LWA

Date: 02-01-07 3:23-07

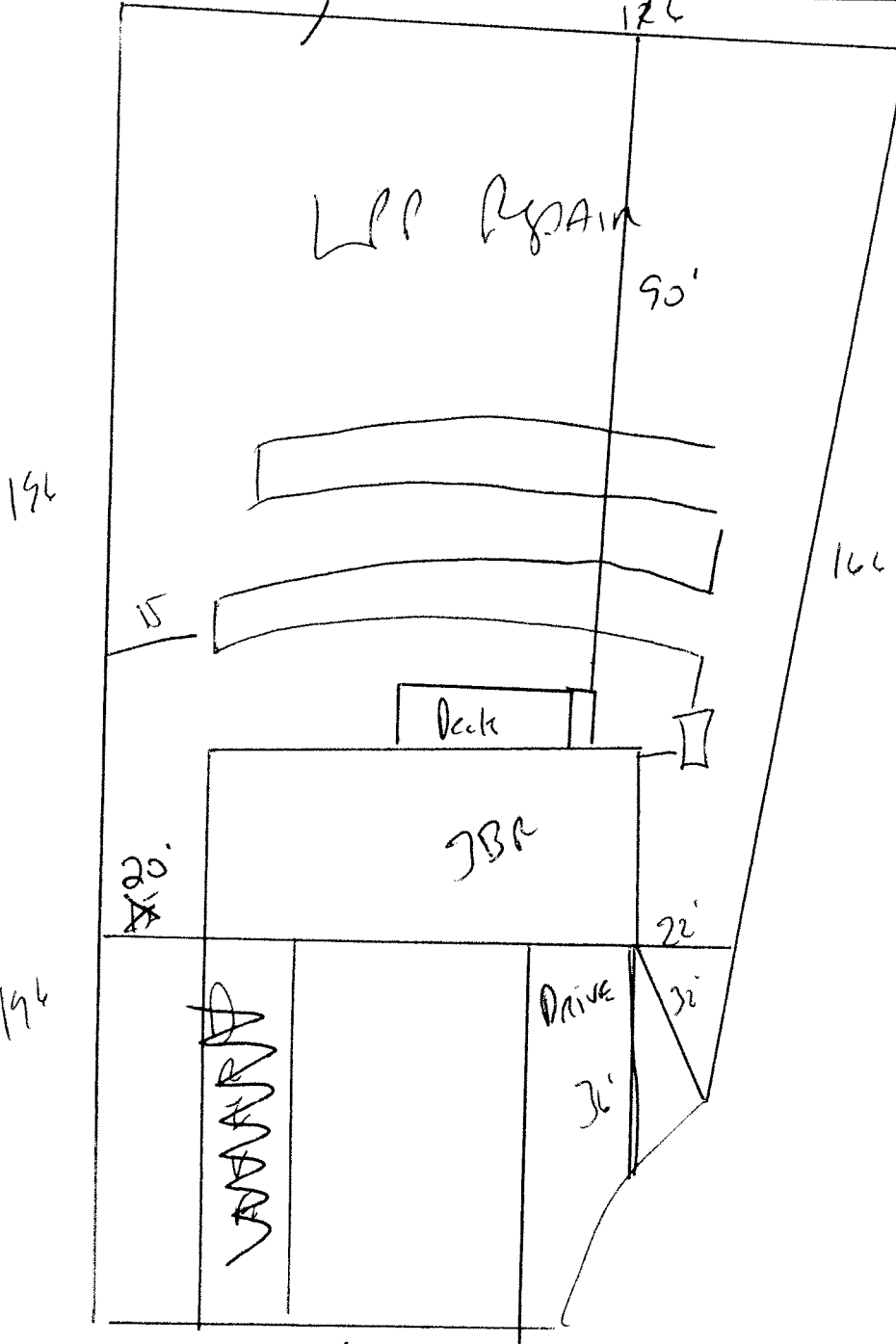

STUB OUT
 Plumbing shall be
 at ground level or
 higher
 maintain all
 set backs
 Install 1x200
 At 18 to 24" Deep.

64
Pond