

HTE# 0650016332

Harriet County Department of Public Health

23651

Cumberland Homes

Improvement Permit

A building permit cannot be issued with only an Improvement Permit

ISSUED TO: Home Co. Builders

PROPERTY LOCATION: 1210
SUBDIVISION Persimmon H. II LOT # 69

NEW REPAIR EXPANSION
Type of Structure: SFD - 56x46 - 3BR
Proposed Wastewater System Type: 25% Reduction system
Projected Daily Flow: 360 GPD
Number of bedrooms: 3 Number of Occupants: 6 max

Site Improvements required prior to Construction Authorization Issuance:

Basement Yes No
Pump Required: Yes No May be required based on final location and elevations of facilities
Type of Water Supply: Community Public Well Distance from well 50 feet Permit valid for: Five years
Permit conditions: STUB out Plumbing shallow, at ground level or higher where shown No expiration

Authorized State Agent: J. W. [Signature] Date: 02-09-07 SEE ATTACHED SITE SKETCH
The issuance of this permit by the Health Department in no way guarantees the issuance of other permits. The permit holder is responsible for checking with appropriate governing bodies in meeting their requirements. This site is subject to revocation if the site plan, plat, or the intended use changes. The Improvement Permit shall not be affected by a change in ownership of the site. This permit is subject to compliance with the provisions of the Laws and Rules for Sewage Treatment and Disposal and to conditions of this permit.

Construction Authorization

(Required for Building Permit)

The construction and installation requirements of Rules .1950, .1952, .1954, .1956, .1957, .1958, and .1959 are incorporated by references into this permit and shall be met. Systems shall be installed in accordance with the attached system layout.

ISSUED TO: Home Co. Builders PROPERTY LOCATION: 1210
SUBDIVISION Persimmon H. II LOT # 69

Facility Type: SFD - 56x46 - 3BR New Expansion Repair
Basement? Yes No Basement Fixtures? Yes No
Type of Wastewater System** 25% Reduction Sys. (Initial) Wastewater Flow: 360 GPD
(See note below, if applicable 360 LF of LPP (Repair))

Installation Requirements/Conditions

Septic Tank Size 1000 gallons Exact length of each trench 1x300 feet Trench Spacing: 7 Feet on Center
Pump Tank Size _____ gallons Trenches shall be installed on contour at a Soil Cover: 6 inches
Maximum Trench Depth of: 18 inches (Maximum soil cover shall not exceed 36" above the trench bottom)
(Trench bottoms shall be level to +/- 1/4" in all directions)
Pump Requirements: _____ ft. TDH vs. _____ GPM Aggregate Depth: _____ inches below pipe
Conditions: _____ inches above pipe
_____ inches total

**If applicable: *I understand the system type specified is different from the type specified on the application. I accept the specifications of this permit.*

Owner/Legal Representative Signature: _____ Date: _____

This Construction Authorization is subject to revocation if the site plan, plat, or the intended use changes. The Construction Authorization shall not be transferred when there is a change in ownership of the site. This Construction Authorization is subject to compliance with the provisions of the Laws and Rules for Sewage Treatment and Disposal and to the conditions of this permit.

Authorized State Agent: J. W. [Signature] Date: 02-09-07 SEE ATTACHED SITE SKETCH
Construction Authorization Expiration Date: 02-09-2012

HTE# 06-500 16332

Permit # 23651

Harnett County Department of Public Health Site Sketch

Cumberland Homes

ISSUED TO: Home Co. Builder

PROPERTY LOCATOR: 1210

SUBDIVISION Persimmon H. II

LOT # 69

Authorized State Agent: J. W. [Signature]

Date: 02-05-07

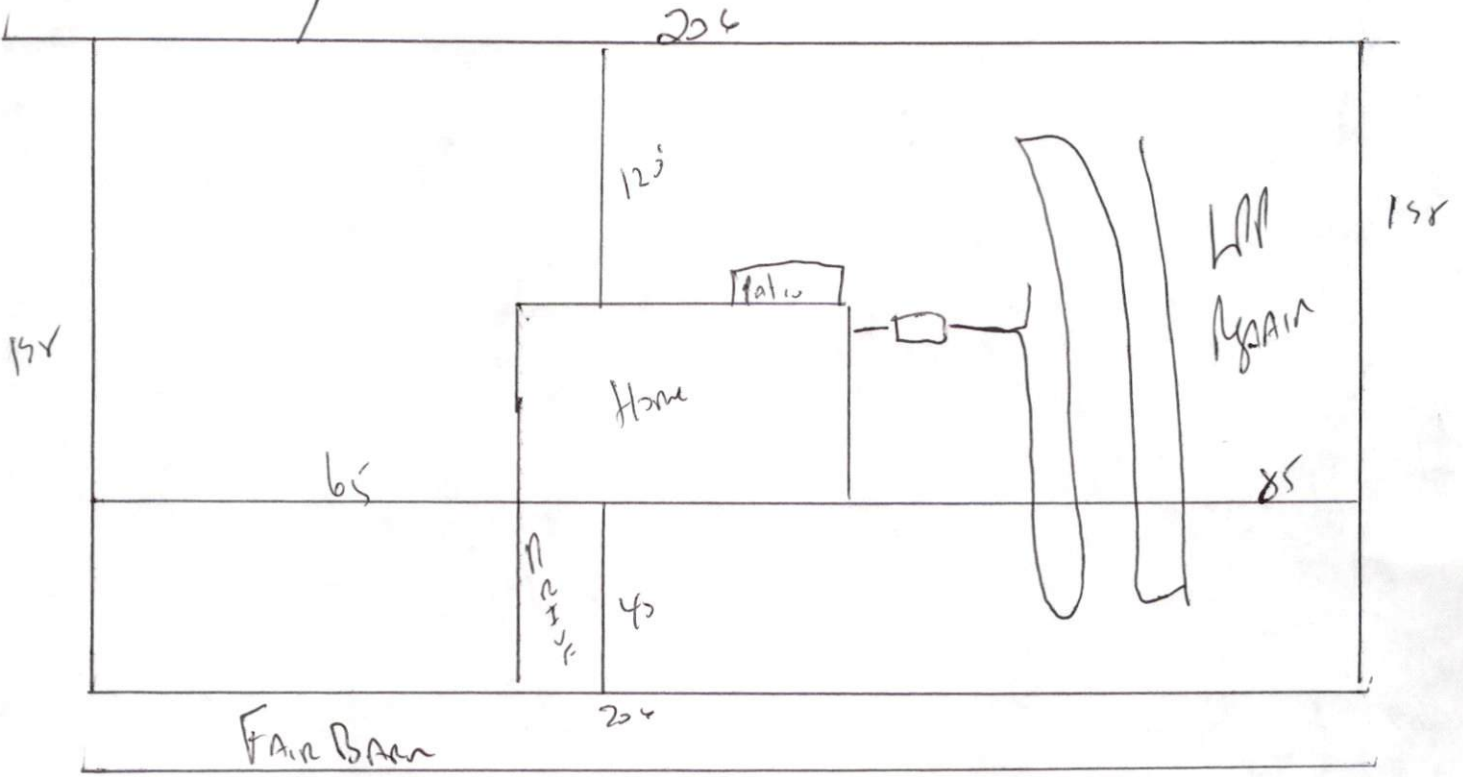

STAB out Plumbing shallows where shown

MAINTAIN ALL SET BACKS

INSTALL 1x200 of 25% Reduction system at 18"