

HTE# 06-500/6247

Harr County Department of Public Health

23424

Improvement Permit

A building permit cannot be issued with only an Improvement Permit

ISSUED TO: Steve Sernigan Sdk Homes PROPERTY LOCATION: 1108
 SUBDIVISION Yorkshire Plantation LOT # 137
 NEW REPAIR EXPANSION Site Improvements required prior to Construction Authorization Issuance:
 Type of Structure: SFD 60x31 JBR
 Proposed Wastewater System Type: Pump to conventional 25% reduction system
 Projected Daily Flow: 360 GPD
 Number of bedrooms: 3 Number of Occupants: 6 max
 Basement Yes No
 Pump Required: Yes No May be required based on final location and elevations of facilities
 Type of Water Supply: Community Public Well Distance from well _____ feet Permit valid for: Five years
 Permit conditions: Sub at Plumbing shall be where shown & Pump may not be Required No expiration

Authorized State Agent: [Signature] Date: 12-17-06 SEE ATTACHED SITE SKETCH
 The issuance of this permit by the Health Department in no way guarantees the issuance of other permits. The permit holder is responsible for checking with appropriate governing bodies in meeting their requirements. This site is subject to revocation if the site plan, plat, or the intended use changes. The Improvement Permit shall not be affected by a change in ownership of the site. This permit is subject to compliance with the provisions of the Laws and Rules for Sewage Treatment and Disposal and to conditions of this permit.

Construction Authorization

(Required for Building Permit)

The construction and installation requirements of Rules .1950, .1952, .1954, .1955, .1956, .1957, .1958, and .1959 are incorporated by references into this permit and shall be met. Systems shall be installed in accordance with the attached system layout.

ISSUED TO: Steve Sernigan Sdk Homes PROPERTY LOCATION: 1108
 SUBDIVISION Yorkshire Plantation LOT # 137
 Facility Type: SFD 60x31 JBR New Expansion Repair
 Basement? Yes No Basement Fixtures? Yes No
 Type of Wastewater System** Pump to 25% Red. Sys. (Initial) Wastewater Flow: 360 GPD
 (See note below, if applicable 240LF of LPP Repair (Repair)

Installation Requirements/Conditions

Septic Tank Size 1000 gallons Exact length of each trench 1x150 feet Trench Spacing: 9 Feet on Center
 Pump Tank Size 1000 gallons Trenches shall be installed on contour at a Soil Cover: 6 inches
 Maximum Trench Depth of: 18.24 inches (Maximum soil cover shall not exceed 36" above the trench bottom)
 (Trench bottoms shall be level to +1/4" in all directions)
 Pump Requirements: _____ ft. TDH vs. _____ GPM Aggregate Depth: _____ inches below pipe
 Conditions: _____ inches above pipe
 _____ inches total

**If applicable: I understand the system type specified is different from the type specified on the application. I accept the specifications of this permit.

Owner/Legal Representative Signature: _____ Date: _____

This Construction Authorization is subject to revocation if the site plan, plat, or the intended use changes. The Construction Authorization shall not be transferred when there is a change in ownership of the site. This Construction Authorization is subject to compliance with the provisions of the Laws and Rules for Sewage Treatment and Disposal and to the conditions of this permit.

Authorized State Agent: [Signature] Date: 12-17-06 SEE ATTACHED SITE SKETCH
 Construction Authorization Expiration Date: 12-17-2011

HTE# 06-50016247

Permit # 23424

Harnett County Department of Public Health Site Sketch

PROPERTY LOCATOR: 1108

ISSUED TO: Steve Joernigm

SUBDIVISION Yorkshire Plantation

LOT # 137

Authorized State Agent:

[Signature]

Date: 12-1-2006

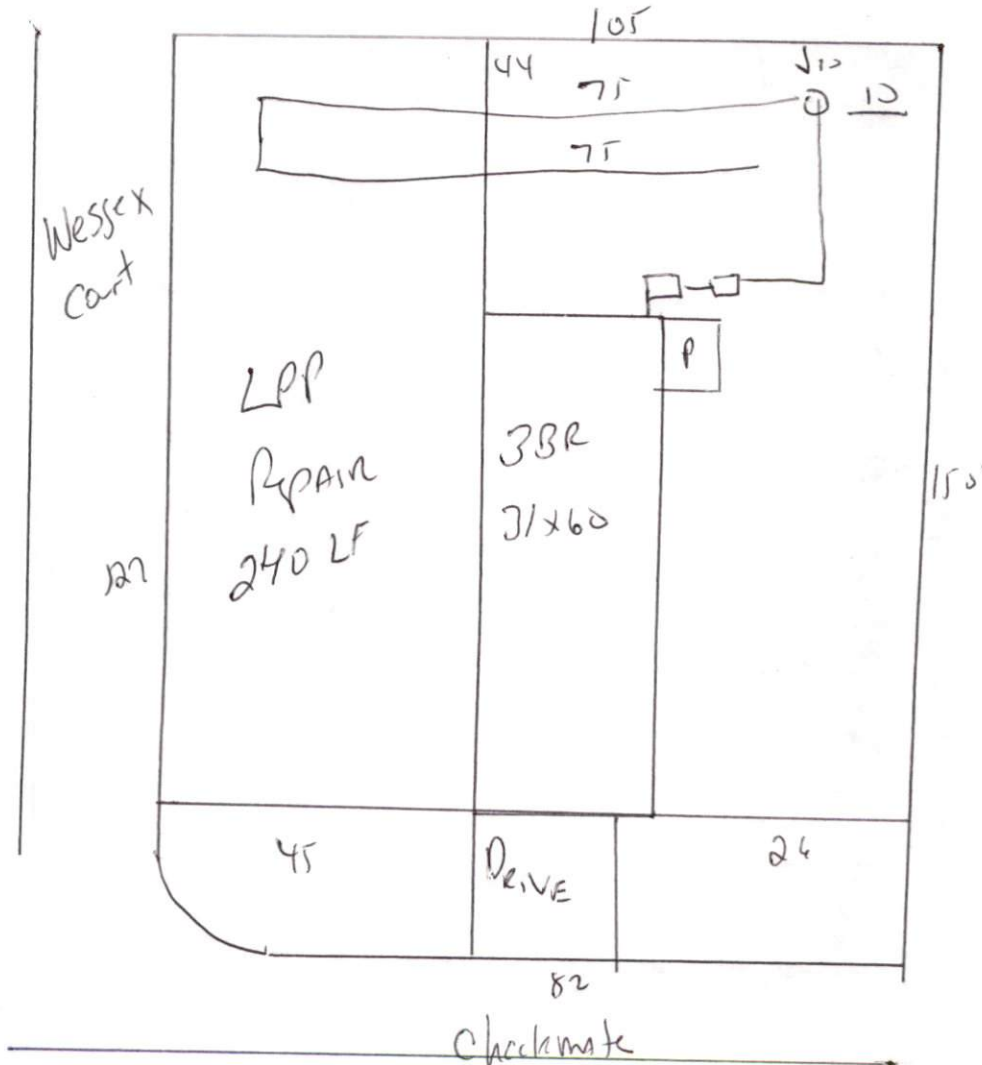

Install
1x150 of 25%
Reduction System
At 18 to 24" Deep

Meet onsite for Final layout
STUB out plumbing shallow where shown & pump may not
be required