

HTE# 06-50016183

Harnett County Department of Public Health

23408

Improvement Permit

A building permit cannot be issued with only an Improvement Permit

ISSUED TO: Kenneth Cummings PROPERTY LOCATION: 1125
 NEW REPAIR EXPANSION SUBDIVISION Woodshire LOT # 104
 Type of Structure: SFD 51x38 3BR Site Improvements required prior to Construction Authorization Issuance:
 Proposed Wastewater System Type: 25% Reduction System
 Projected Daily Flow: 360 GPD
 Number of bedrooms: 3 Number of Occupants: 6 max
 Basement Yes No
 Pump Required: Yes No May be required based on final location and elevations of facilities
 Type of Water Supply: Community Public Well Distance from well 50 feet Permit valid for: Five years
 Permit conditions: Meet onsite for final layout & maintain all set backs No expiration
Key drain lines 10' from power lines & 20' from property lines with easement
See site sketch sheet for more details

Authorized State Agent: J. W. Ari Date: 11-22-06 SEE ATTACHED SITE SKETCH
 The issuance of this permit by the Health Department in no way guarantees the issuance of other permits. The permit holder is responsible for checking with appropriate governing bodies in meeting their requirements. This site is subject to revocation if the site plan, plat, or the intended use changes. The Improvement Permit shall not be affected by a change in ownership of the site. This permit is subject to compliance with the provisions of the Laws and Rules for Sewage Treatment and Disposal and to conditions of this permit.

Construction Authorization

(Required for Building Permit)

The construction and installation requirements of Rules .1950, .1952, .1954, .1955, .1956, .1957, .1958, and .1959 are incorporated by references into this permit and shall be met. Systems shall be installed in accordance with the attached system layout.

ISSUED TO: Kenneth Cummings PROPERTY LOCATION: 1125
 SUBDIVISION Woodshire LOT # 104
 Facility Type: SFD - 51x38 New Expansion Repair
 Basement? Yes No Basement Fixtures? Yes No
 Type of Wastewater System** 25% Reduction system (Initial) Wastewater Flow: _____ GPD
 (See note below, if applicable LLP Ryan 240 LF (Repair))

Installation Requirements/Conditions

Septic Tank Size 1000 gallons Exact length of each trench 4x40 feet Trench Spacing: 39 Feet on Center
 Pump Tank Size _____ gallons Trenches shall be installed on contour at a Soil Cover: 6 inches
 Maximum Trench Depth of: 18 inches (Maximum soil cover shall not exceed 36" above the trench bottom)
 in all directions)
 Pump Requirements: _____ ft. TDH vs. _____ GPM Aggregate Depth: _____ inches below pipe
 _____ inches above pipe
 Conditions: _____ inches total

**If applicable: *I understand the system type specified is different from the type specified on the application. I accept the specifications of this permit.*

Owner/Legal Representative Signature: _____ Date: _____

This Construction Authorization is subject to revocation if the site plan, plat, or the intended use changes. The Construction Authorization shall not be transferred when there is a change in ownership of the site. This Construction Authorization is subject to compliance with the provisions of the Laws and Rules for Sewage Treatment and Disposal and to the conditions of this permit.

Authorized State Agent: J. W. Ari Date: 11-22-06 SEE ATTACHED SITE SKETCH
 Construction Authorization Expiration Date: 11-22-2011

HTE# 06-50016183

Permit # 23408

Harnett County Department of Public Health Site Sketch

ISSUED TO: Kenneth Cummings PROPERTY LOCATOR: 1125
SUBDIVISION: Woodshire LOT # 104
Authorized State Agent: [Signature] Date: 11-22-06

SONORA

93

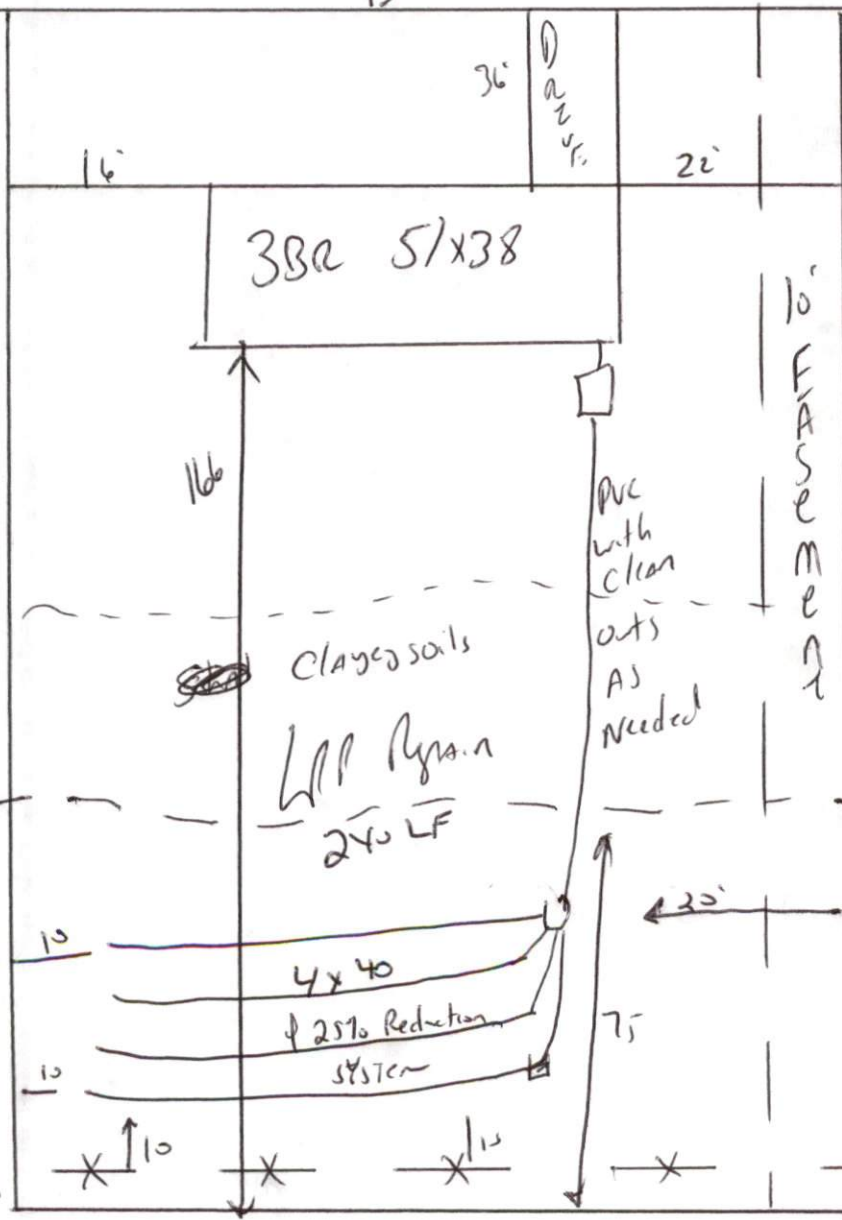

Meet onsite for
Final layout
Stub out Plumbing
Shallow
Maintain All set Backs
Keep drain lines
10' from power line
And 20' from Property
Line with Easement
Along it.
Install 4x40
25% Reduction system

SR-1125