

HTE# 06-50016169

## Harnett County Department of Public Health

23418

## Improvement Permit

A building permit cannot be issued with only an Improvement Permit

ISSUED TO: Kent Pierce PROPERTY LOCATION: Near  
SUBDIVISION: Laurel Valley LOT # 24  
NEW ☒ REPAIR ☐ EXPANSION ☐  
Type of Structure: SFD - 35x58 3DR  
Proposed Wastewater System Type: 25% Reduction System  
Projected Daily Flow: 360 GPD  
Number of bedrooms: 3 Number of Occupants: 6 max  
Basement ☐ Yes ☒ No  
Pump Required: ☐ Yes ☒ No ☐ May be required based on final location and elevations of facilities  
Type of Water Supply: ☐ Community ☒ Public ☐ Well Distance from well 50 feet Permit valid for: ☒ Five years  
Permit conditions: STUB out Plumbing shallow where shown - maintain all setbacks ☐ No expiration  
met on site

Authorized State Agent: J. L. LAR Date: 12-01-06 SEE ATTACHED SITE SKETCH

The issuance of this permit by the Health Department in no way guarantees the issuance of other permits. The permit holder is responsible for checking with appropriate governing bodies in meeting their requirements. This site is subject to revocation if the site plan, plat, or the intended use changes. The Improvement Permit shall not be affected by a change in ownership of the site. This permit is subject to compliance with the provisions of the Laws and Rules for Sewage Treatment and Disposal and to conditions of this permit.

## Construction Authorization

(Required for Building Permit)

The construction and installation requirements of Rules .1950, .1952, .1954, .1955, .1956, .1957, .1958, and .1959 are incorporated by references into this permit and shall be met. Systems shall be installed in accordance with the attached system layout.

ISSUED TO: Kent Pierce PROPERTY LOCATION: Near  
SUBDIVISION: Laurel Valley LOT # 24  
Facility Type: SFD - 35x58 3DR ☒ New ☐ Expansion ☐ Repair  
Basement? ☒ Yes ☐ No Basement Fixtures? ☐ Yes ☐ No  
Type of Wastewater System\*\* 25% Reduction System (Initial) Wastewater Flow: 360 GPD  
(See note below, if applicable ☒)  
LPP Repair - 480 LF (Repair)

## Installation Requirements/Conditions

Septic Tank Size 1000 gallons  
Pump Tank Size \_\_\_\_\_ gallons  
Exact length of each trench 1x265 feet  
Trenches shall be installed on contour at a  
Maximum Trench Depth of: 18 inches  
(Trench bottoms shall be level to  $\pm 1/4"$  in all directions)  
Pump Requirements: \_\_\_\_\_ ft. TDH vs. \_\_\_\_\_ GPM  
Trench Spacing: 9 Feet on Center  
Soil Cover: 6 inches  
(Maximum soil cover shall not exceed 36" above the trench bottom)  
Aggregate Depth: \_\_\_\_\_ inches below pipe  
\_\_\_\_\_ inches above pipe  
\_\_\_\_\_ inches total  
Conditions: \_\_\_\_\_

\*\*If applicable: I understand the system type specified is different from the type specified on the application. I accept the specifications of this permit.

Owner/Legal Representative Signature: \_\_\_\_\_ Date: \_\_\_\_\_

This Construction Authorization is subject to revocation if the site plan, plat, or the intended use changes. The Construction Authorization shall not be transferred when there is a change in ownership of the site. This Construction Authorization is subject to compliance with the provisions of the Laws and Rules for Sewage Treatment and Disposal and to the conditions of this permit.

Authorized State Agent: J. L. LAR Date: 12-01-06 SEE ATTACHED SITE SKETCH

Construction Authorization Expiration Date: 12-01-2011

HTE# 06500-16169

Permit # 23418

# Harnett County Department of Public Health Site Sketch

PROPERTY LOCATON: NC 21

ISSUED TO: Kent Pierce

SUBDIVISION

Lamuel Valley

LOT # 04

Authorized State Agent:

Date: 1/25/2025

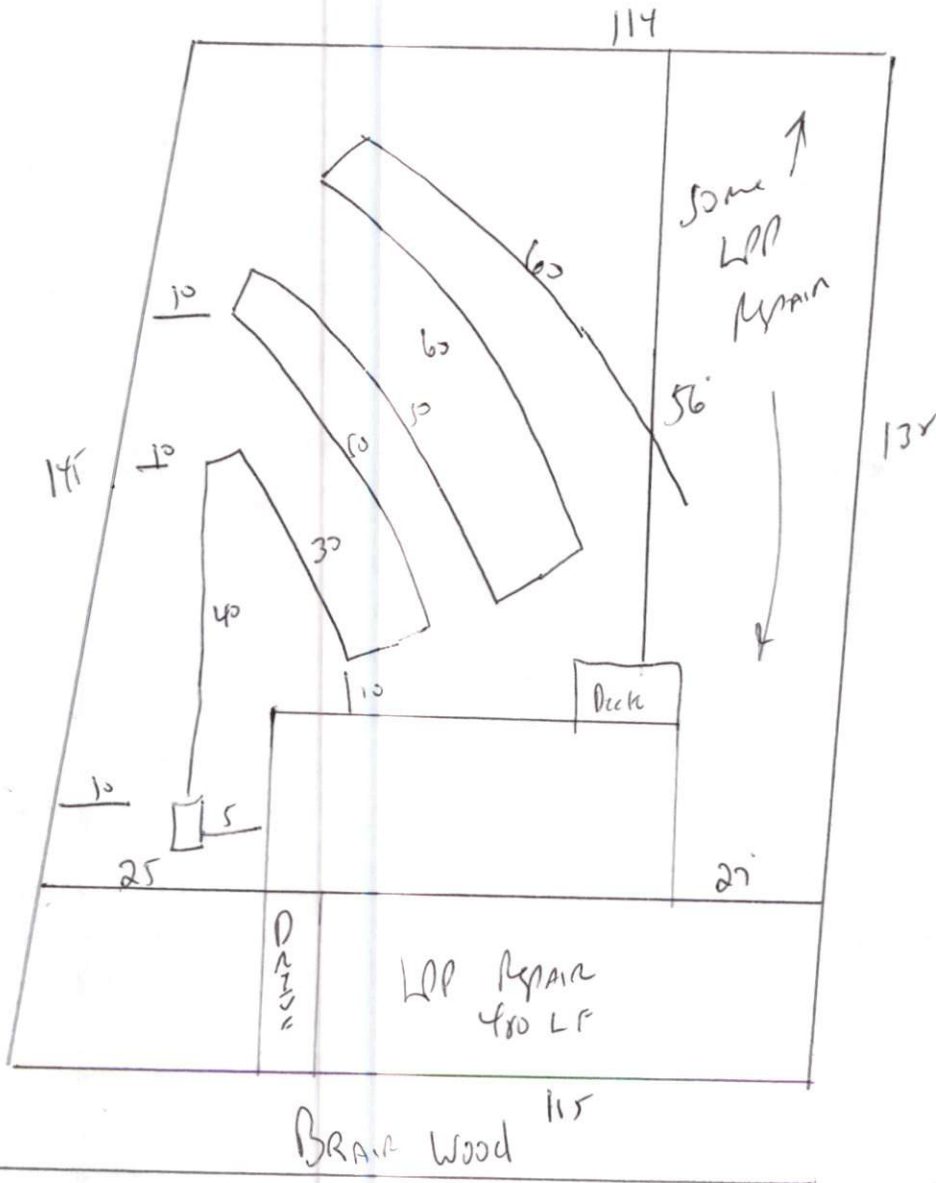

STUB OUT  
Plumbing shallow  
Where shown  
(At ground level or higher)

Maintain all set Back,  
meet on site for  
Final Layout