

HTE# 20-50016034

Harnett County Department of Public Health

24351

Improvement Permit

A building permit cannot be issued with only an Improvement Permit

ISSUED TO: William Becker PROPERTY LOCATION: 1116
SUBDIVISION Colonial Hills LOT # 62

NEW REPAIR EXPANSION Site Improvements required prior to Construction Authorization Issuance:

Type of Structure: SFO-50x50 3BR

Proposed Wastewater System Type: Pump to 2 1/2 Red. system

Projected Daily Flow: 360 GPD

Number of bedrooms: 3 Number of Occupants: 6 max

Basement Yes No

Pump Required: Yes No May be required based on final location and elevations of facilities

Type of Water Supply: Community Public Well Distance from well 50 feet Permit valid for: Five years No expiration

Permit conditions: Meet on site for final layout maintain all set backs

STUB out Plumbing shallow at ground level or higher where shown and Pump may not be needed if 18 to 24" ditch depth can be maintained.

Authorized State Agent: Joe W... Date: 09-10-07 SEE ATTACHED SITE SKETCH

The issuance of this permit by the Health Department in no way guarantees the issuance of other permits. The permit holder is responsible for checking with appropriate governing bodies in meeting their requirements. This site is subject to revocation if the site plan, plat, or the intended use changes. The Improvement Permit shall not be affected by a change in ownership of the site. This permit is subject to compliance with the provisions of the Laws and Rules for Sewage Treatment and Disposal and to conditions of this permit.

Construction Authorization

(Required for Building Permit)

The construction and installation requirements of Rules .1950, .1952, .1954, .1955, .1956, .1957, .1958, and .1959 are incorporated by references into this permit and shall be met. Systems shall be installed in accordance with the attached system layout.

ISSUED TO: William Becker PROPERTY LOCATION: 1116
SUBDIVISION Colonial Hills LOT # 62

Facility Type: SFO-50x50-3BR New Expansion Repair

Basement? Yes No Basement Fixtures? Yes No

Type of Wastewater System** Pump to 2 1/2 Red. Sys. (Initial) Wastewater Flow: 360 GPD

(See note below, if applicable Pump to 180 LF of 2 1/2 Red. Sys (Repair)

Installation Requirements/Conditions

Septic Tank Size 1000 gallons Exact length of each trench 1 x 180 feet Trench Spacing: 9 Feet on Center

Pump Tank Size 1000 gallons Trenches shall be installed on contour at a Soil Cover: 6 inches

Maximum Trench Depth of: 18.24 inches (Maximum soil cover shall not exceed 36" above the trench bottom)

(Trench bottoms shall be level to +/- 1/4" in all directions)

Pump Requirements: _____ ft. TDH vs. _____ GPM _____ inches below pipe

Aggregate Depth: _____ inches above pipe

Conditions: _____ inches total

**If applicable: *I understand the system type specified is different from the type specified on the application. I accept the specifications of this permit.*

Owner/Legal Representative Signature: _____ Date: _____

This Construction Authorization is subject to revocation if the site plan, plat, or the intended use changes. The Construction Authorization shall not be transferred when there is a change in ownership of the site. This Construction Authorization is subject to compliance with the provisions of the Laws and Rules for Sewage Treatment and Disposal and to the conditions of this permit.

Authorized State Agent: Joe W... Date: 09-10-07 SEE ATTACHED SITE SKETCH

Construction Authorization Expiration Date: 09-10-2012

HTE# 06-50016034

Permit # 24351

Harnett County Department of Public Health Site Sketch

ISSUED TO: William Becker

PROPERTY LOCATOR: 1116

SUBDIVISION

Colonial Hills

LOT #

62

Authorized State Agent:

J. L. [Signature]

Date: 09-10-07

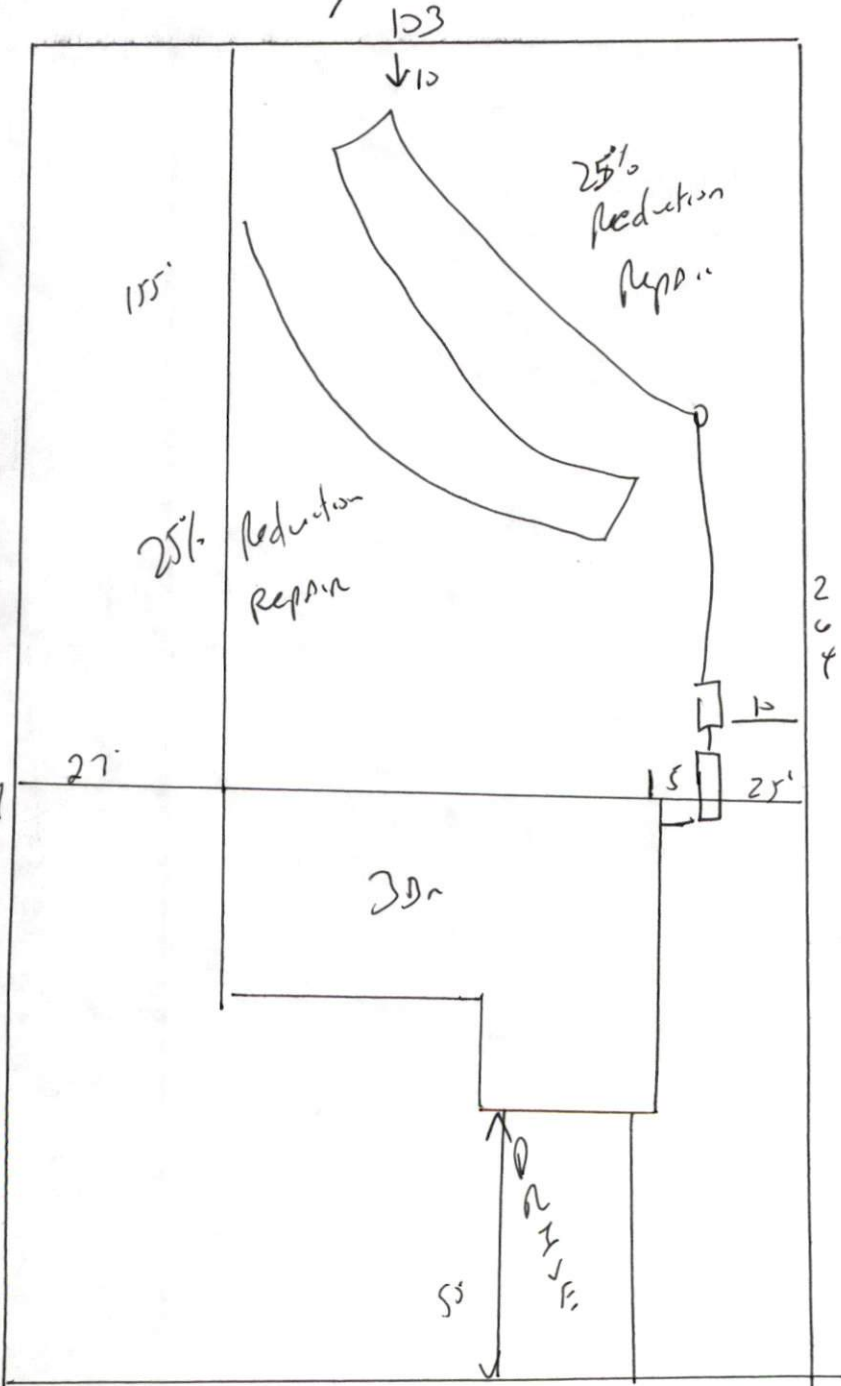

Meet onsite for Final Layout
 STUB out Plumbing shallow
 At ground level or higher
 Where shown. IF 18 to
 24" ditch depth can be
 maintain then pump may
 not be required.

Install 1x180 1/2 25%
 Reduction system.

102 Road