

### Improvement Permit

A building permit cannot be issued with only an Improvement Permit

ISSUED TO: RBC Homes PROPERTY LOCATION: 1116  
 SUBDIVISION: Colonial Hills LOT # 57  
 NEW  REPAIR  EXPANSION   
 Type of Structure: SFD- 34x39- 3BR  
 Proposed Wastewater System Type: 25% Red. system  
 Projected Daily Flow: 360 GPD  
 Number of bedrooms: 3 Number of Occupants: 6 max  
 Basement  Yes  No  
 Pump Required:  Yes  No  May be required based on final location and elevations of facilities  
 Type of Water Supply:  Community  Public  Well Distance from well 50 feet Permit valid for:  Five years  
 Permit conditions: met on site maintain all set back  No expiration  
STUD out Plumbing shallow where shown.

Authorized State Agent: [Signature] Date: 07-21-07 SEE ATTACHED SITE SKETCH  
 The issuance of this permit by the Health Department in no way guarantees the issuance of other permits. The permit holder is responsible for checking with appropriate governing bodies in meeting their requirements. This site is subject to revocation if the site plan, plat, or the intended use changes. The Improvement Permit shall not be affected by a change in ownership of the site. This permit is subject to compliance with the provisions of the Laws and Rules for Sewage Treatment and Disposal and to conditions of this permit.

### Construction Authorization

(Required for Building Permit)

The construction and installation requirements of Rules .1950, .1952, .1954, .1955, .1956, .1957, .1958, and .1959 are incorporated by references into this permit and shall be met. Systems shall be installed in accordance with the attached system layout.

ISSUED TO: RBC Homes PROPERTY LOCATION: 1116  
 SUBDIVISION: Colonial Hills LOT # 57  
 Facility Type: SFD- 34x39 3BR  New  Expansion  Repair  
 Basement?  Yes  No Basement Fixtures?  Yes  No  
 Type of Wastewater System\*\* 25% Reduction sys. (Initial) Wastewater Flow: 360 GPD  
 (See note below, if applicable  360 LF 1 LRP (Repair))

#### Installation Requirements/Conditions

Septic Tank Size 1000 gallons Exact length of each trench 1 x 225 feet Trench Spacing: 9 Feet on Center  
 Pump Tank Size \_\_\_\_\_ gallons Trenches shall be installed on contour at a Soil Cover: 6 inches  
 Maximum Trench Depth of: 18 inches (Maximum soil cover shall not exceed 36" above the trench bottom)  
 (Trench bottoms shall be level to +/-1/4" in all directions)  
 Pump Requirements: \_\_\_\_\_ ft. TDH vs. \_\_\_\_\_ GPM \_\_\_\_\_ inches below pipe  
 Aggregate Depth: \_\_\_\_\_ inches above pipe  
 Conditions: \_\_\_\_\_ inches total

\*\*If applicable: I understand the system type specified is different from the type specified on the application. I accept the specifications of this permit.

Owner/Legal Representative Signature: \_\_\_\_\_ Date: \_\_\_\_\_

This Construction Authorization is subject to revocation if the site plan, plat, or the intended use changes. The Construction Authorization shall not be transferred when there is a change in ownership of the site. This Construction Authorization is subject to compliance with the provisions of the Laws and Rules for Sewage Treatment and Disposal and to the conditions of this permit.

Authorized State Agent: [Signature] Date: 07-21-07 SEE ATTACHED SITE SKETCH  
 Construction Authorization Expiration Date: 07-21-2012

HTE# 06-500/6029 RR

Permit # 23809

# Harnett County Department of Public Health Site Sketch

ISSUED TO: RBC Homes

PROPERTY LOCATOR: 1114

SUBDIVISION Colonial Hills

LOT # 57

Authorized State Agent: J. L. [Signature]

Date: 3-21-07

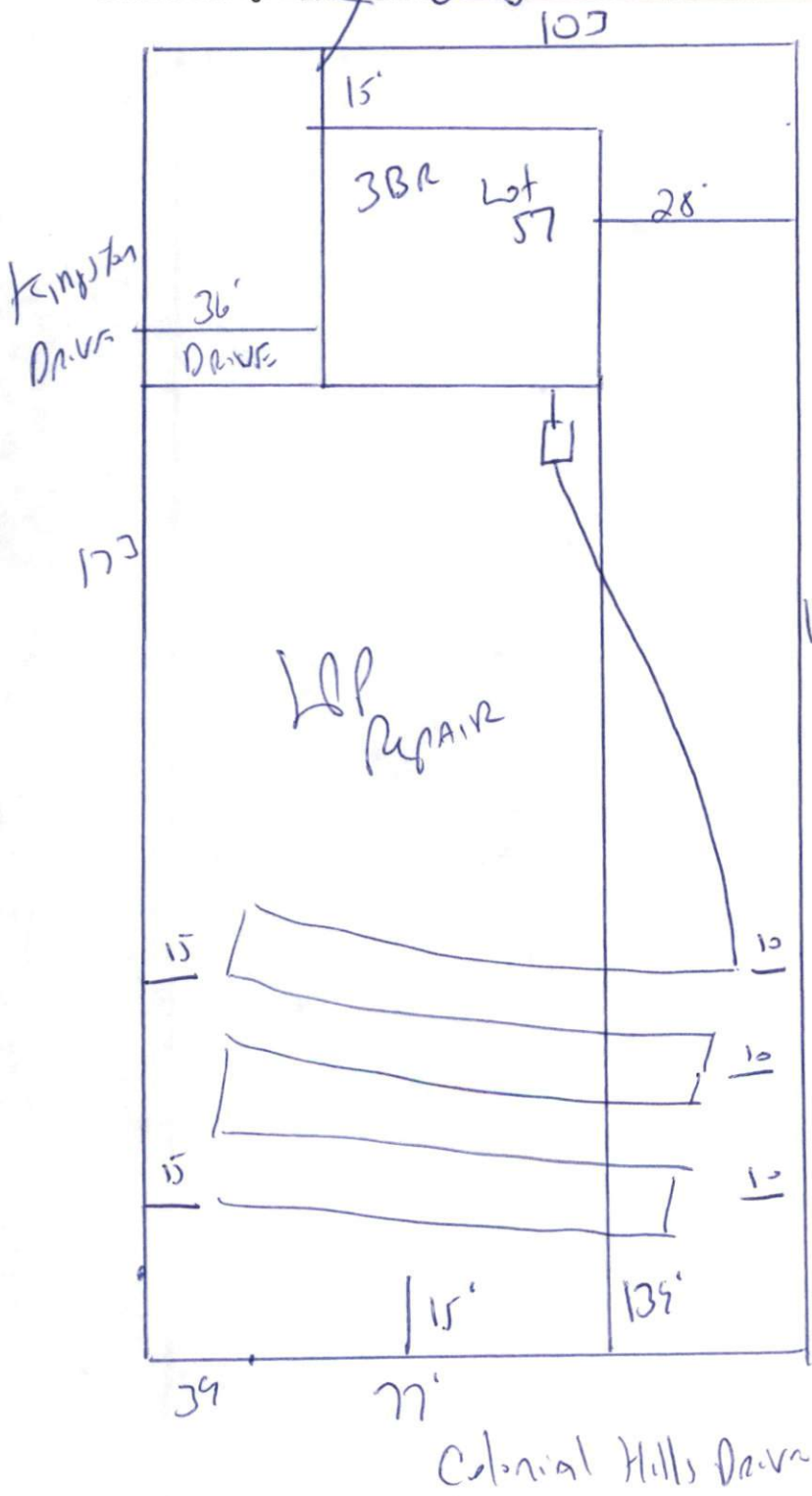

Meet onsite  
 STUB out Plumbing  
 shallow, at ground level  
 or higher where shown  
 MAINTAIN ALL set BACKS

Install 1x225 of  
 9 25% reduction system  
 AT 18"

Colonial Hills Drive