

### Improvement Permit

A building permit cannot be issued with only an Improvement Permit

ISSUED TO: RBC Home      PROPERTY LOCATION: 1116  
 NEW  REPAIR  EXPANSION       SUBDIVISION: Colonial Hills      LOT # 55  
 Type of Structure: SFD 44x56 3BR      Site Improvements required prior to Construction Authorization Issuance:  
 Proposed Wastewater System Type: Pump to 25% reduction system  
 Projected Daily Flow: 360 GPD  
 Number of bedrooms: 3      Number of Occupants: 6 max  
 Basement  Yes  No  
 Pump Required:  Yes  No       May be required based on final location and elevations of facilities  
 Type of Water Supply:  Community  Public  Well      Distance from well 50 feet      Permit valid for:  Five years  
 Permit conditions: Meet onsite for Final Layout Maintain All SETBACK       No expiration

Authorized State Agent: [Signature]      Date: 02-08-07      SEE ATTACHED SITE SKETCH  
 The issuance of this permit by the Health Department in no way guarantees the issuance of other permits. The permit holder is responsible for checking with appropriate governing bodies in meeting their requirements. This site is subject to revocation if the site plan, plat, or the intended use changes. The Improvement Permit shall not be affected by a change in ownership of the site. This permit is subject to compliance with the provisions of the Laws and Rules for Sewage Treatment and Disposal and to conditions of this permit.

### Construction Authorization

(Required for Building Permit)

The construction and installation requirements of Rules .1950, .1952, .1954, .1955, .1956, .1957, .1958, and .1959 are incorporated by references into this permit and shall be met. Systems shall be installed in accordance with the attached system layout.

ISSUED TO: RBC Home      PROPERTY LOCATION: 1116  
 SUBDIVISION: Colonial Hills      LOT # 55  
 Facility Type: SFD-44x56-3BR  New  Expansion  Repair  
 Basement?  Yes  No      Basement Fixtures?  Yes  No  
 Type of Wastewater System\*\* Pump to 25% Red. Sys. (Initial)      Wastewater Flow: 360 GPD  
 (See note below, if applicable)  360 LF of LPP (Repair)

**Installation Requirements/Conditions**

Septic Tank Size 1000 gallons      Exact length of each trench 1x225 feet      Trench Spacing: 9 Feet on Center  
 Pump Tank Size 1000 gallons      Trenches shall be installed on contour at a      Soil Cover: 6 inches  
    Maximum Trench Depth of: 18 max inches      (Maximum soil cover shall not exceed 36" above the trench bottom)  
    (Trench bottoms shall be level to +/-1/4" in all directions)  
 Pump Requirements: \_\_\_\_\_ ft. TDH vs. \_\_\_\_\_ GPM      \_\_\_\_\_ inches below pipe  
    Aggregate Depth: \_\_\_\_\_ inches above pipe  
 Conditions: \_\_\_\_\_      \_\_\_\_\_ inches total

**\*\*If applicable:**      *I understand the system type specified is different from the type specified on the application. I accept the specifications of this permit.*

Owner/Legal Representative Signature: \_\_\_\_\_ Date: \_\_\_\_\_

This Construction Authorization is subject to revocation if the site plan, plat, or the intended use changes. The Construction Authorization shall not be transferred when there is a change in ownership of the site. This Construction Authorization is subject to compliance with the provisions of the Laws and Rules for Sewage Treatment and Disposal and to the conditions of this permit.

Authorized State Agent: [Signature]      Date: 020807      SEE ATTACHED SITE SKETCH  
 Construction Authorization Expiration Date: 02.08.2011

HTE# 06-50016027R

Permit # 23802

# Harnett County Department of Public Health Site Sketch

ISSUED TO: RBC Homes

PROPERTY LOCATOR: 1116

SUBDIVISION Colonial Hills

LOT # 55

Authorized State Agent:

*J. Waters*

Date: 03-08-07

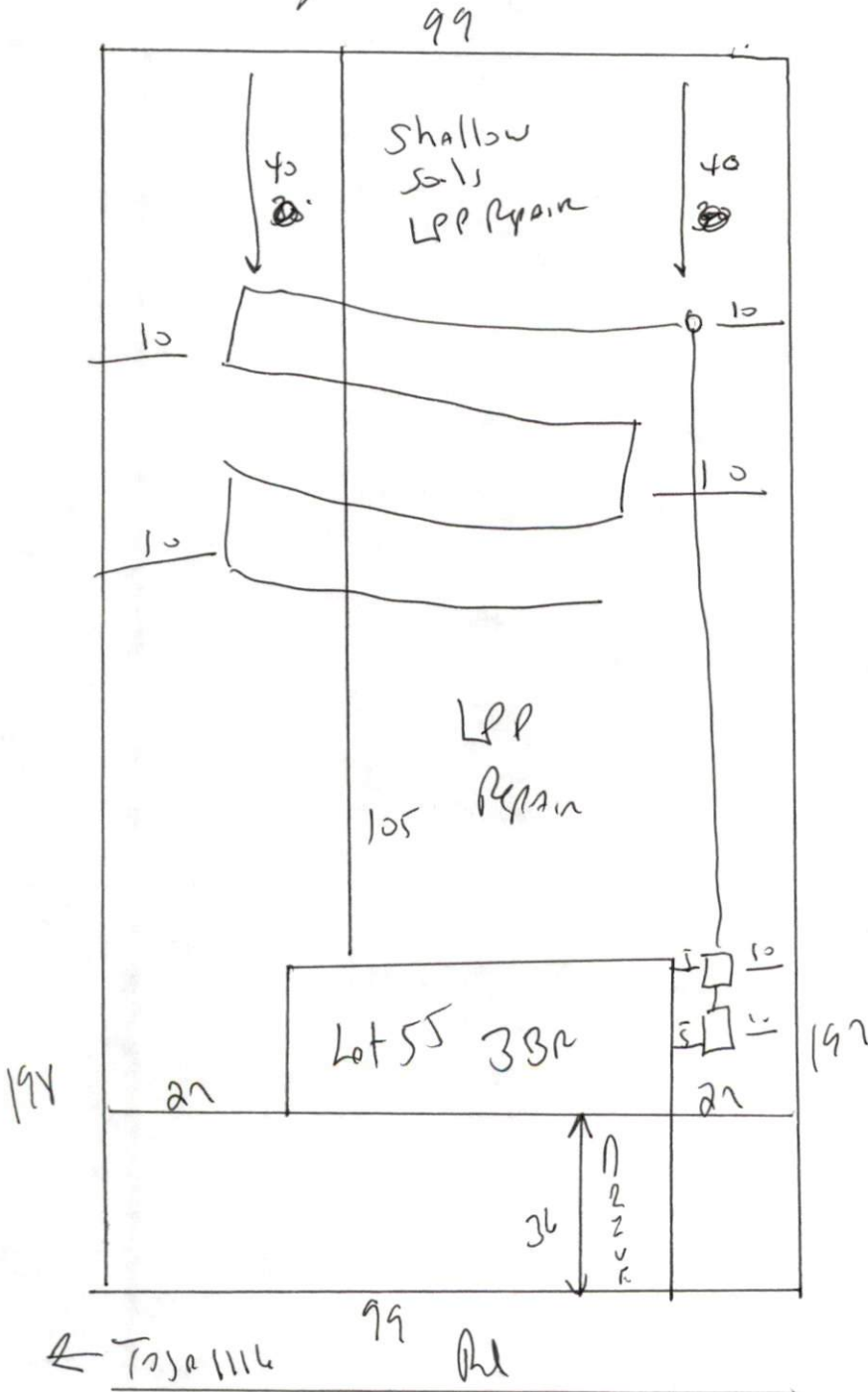

Meet on site for  
Final Layout  
maintain all setbacks,  
Install 1x225 of 25%  
Reduction system at  
18" Ditch Depth