

HTE# 06.500/6022

Harnett County Department of Public Health

23624

Improvement Permit

A building permit cannot be issued with only an Improvement Permit

ISSUED TO: ADK Partners PROPERTY LOCATION: 1114
 SUBDIVISION: Colonial Hills LOT # 51
 NEW REPAIR EXPANSION
 Type of Structure: SFD - 40x65 - 30A Site Improvements required prior to Construction Authorization Issuance:
 Proposed Wastewater System Type: Pump to conventional
 Projected Daily Flow: 360 GPD
 Number of bedrooms: 3 Number of Occupants: 6 max
 Basement Yes No
 Pump Required: Yes No May be required based on final location and elevations of facilities
 Type of Water Supply: Community Public Well Distance from well _____ feet Permit valid for: Five years
 Permit conditions: Meet on site for final Adjust - 57.3 out Plumbing shallow No expiration
At ground level or higher & Pump may not be needed - maintain all set back

Authorized State Agent: [Signature] Date: 01-25-07 SEE ATTACHED SITE SKETCH
 The issuance of this permit by the Health Department in no way guarantees the issuance of other permits. The permit holder is responsible for checking with appropriate governing bodies in meeting their requirements. This site is subject to revocation if the site plan, plat, or the intended use changes. The Improvement Permit shall not be affected by a change in ownership of the site. This permit is subject to compliance with the provisions of the Laws and Rules for Sewage Treatment and Disposal and to conditions of this permit.

Construction Authorization

(Required for Building Permit)

The construction and installation requirements of Rules .1950, .1952, .1954, .1955, .1956, .1957, .1958, and .1959 are incorporated by references into this permit and shall be met. Systems shall be installed in accordance with the attached system layout.

ISSUED TO: ADK Partners PROPERTY LOCATION: 1114
 SUBDIVISION: Colonial Hills LOT # 51
 Facility Type: SFD - 40x65 30A New Expansion Repair
 Basement? Yes No Basement Fixtures? Yes No
 Type of Wastewater System** Pump to 25% reduction system (Initial) Wastewater Flow: 360 GPD
 (See note below, if applicable 290 LF of LPP (Repair))

Installation Requirements/Conditions

Septic Tank Size 1000 gallons Exact length of each trench 1x240 feet Trench Spacing: 9 Feet on Center
 Pump Tank Size 1000 gallons Trenches shall be installed on contour at a Soil Cover: 6 inches
if needed Maximum Trench Depth of: 18-24 inches (Maximum soil cover shall not exceed 36" above the trench bottom)
 Pump Requirements: _____ ft. TDH vs. _____ GPM in all directions
 Conditions: _____ Aggregate Depth: 6 inches below pipe
12 inches above pipe
12 inches total

**If applicable: *I understand the system type specified is different from the type specified on the application. I accept the specifications of this permit.*

Owner/Legal Representative Signature: _____ Date: _____

This Construction Authorization is subject to revocation if the site plan, plat, or the intended use changes. The Construction Authorization shall not be transferred when there is a change in ownership of the site. This Construction Authorization is subject to compliance with the provisions of the Laws and Rules for Sewage Treatment and Disposal and to the conditions of this permit.

Authorized State Agent: [Signature] Date: 01-25-07 SEE ATTACHED SITE SKETCH
 Construction Authorization Expiration Date: 01-25-2012

HTE# 06-50016022

Permit # 23624

Harnett County Department of Public Health Site Sketch

ISSUED TO: ADK Partnership PROPERTY LOCATOR: 1116
SUBDIVISION Colonial Hills LOT # 51

Authorized State Agent: [Signature] Date: 01-25-07

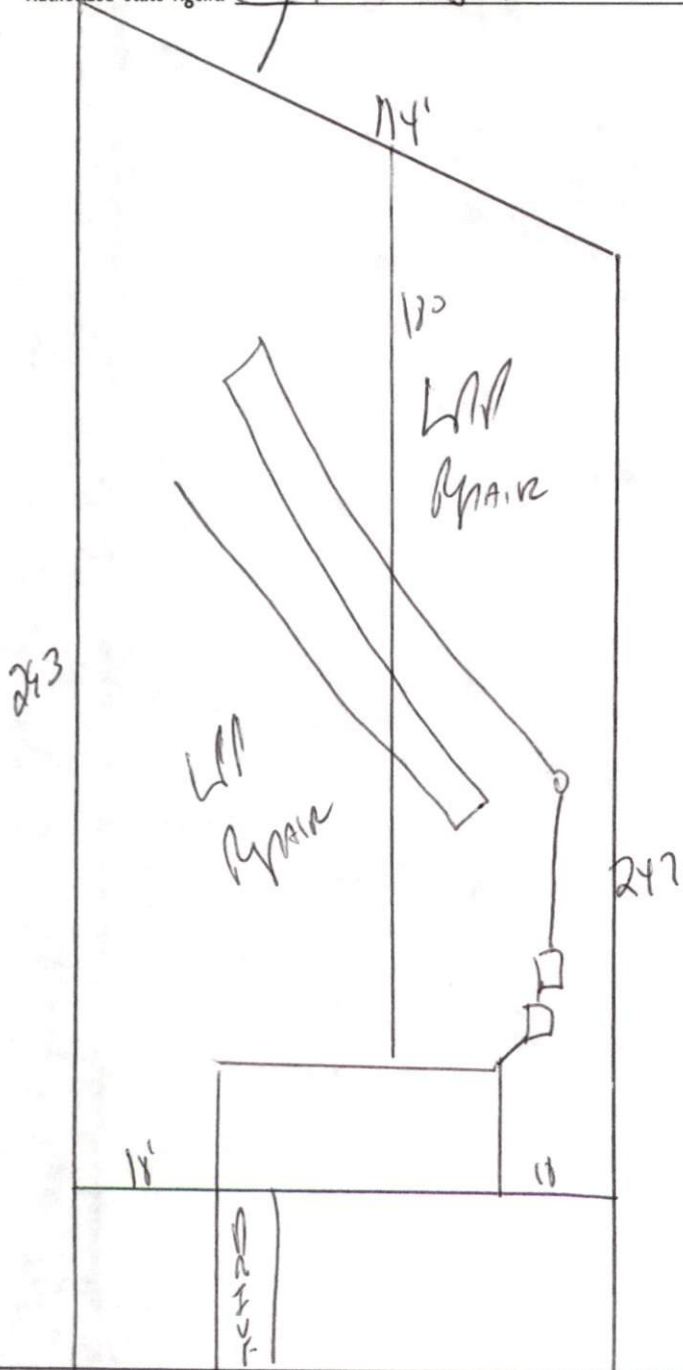

Stub out Plumbing shallow
 where shown (at ground level
 or higher) and Pump may
 not be needed.
 Meet onsite for Final
 layout
 Maintain all setbacks
 Install 1x240 at 18 to 24

114
Downing Court