

Thomas J. Boyce
P.O. Box 81
Pittsboro, NC 27312
919-868-8135
NC Licensed Soil Scientist # 1241
NC Registered Sanitarian # 1353

Atkins Place, LLC
Keith Bullock and Adam Raynor

Rc:Dexterfield Subdivision, Lots 14, 15, 26, and 27

Dear Mr. Bullock and Mr. Raynor,

A final soils evaluation was completed on the above referenced property in January, 2008. The purpose of the evaluation was to determine the ability of the soils to support a subsurface waste disposal system for initial and/or repair for a three bedroom house. All ratings and determinations were made in accordance with "Laws and Rules for Sewage Treatment and Disposal Systems, 15A NCAC 18A .1900".

Typical soils over the lots were 18-24 inches of sandy loam over a sandy clay loam to 46 inches. The soil limiting factor was soil wetness at 46 inches. Loading rates varied from .375-.6 gpd/sqft. Systems were designed for these lots at these loading rates and site plans were drawn. The purpose for the designs was the encroachment of a permanent sediment basin that affected each of these lots. Site plans are to scale showing house placement with system layout and design for each lot.

This report does not guarantee or represent approval or issuance of permits as needed by the local health department. This report only represents my opinion as a licensed soil scientist. I trust this is the information that you require at this time. If you have any questions, please call.

Sincerely,

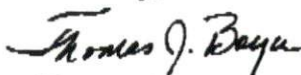
Thomas J. Boyce



lot 141 Dexterfield

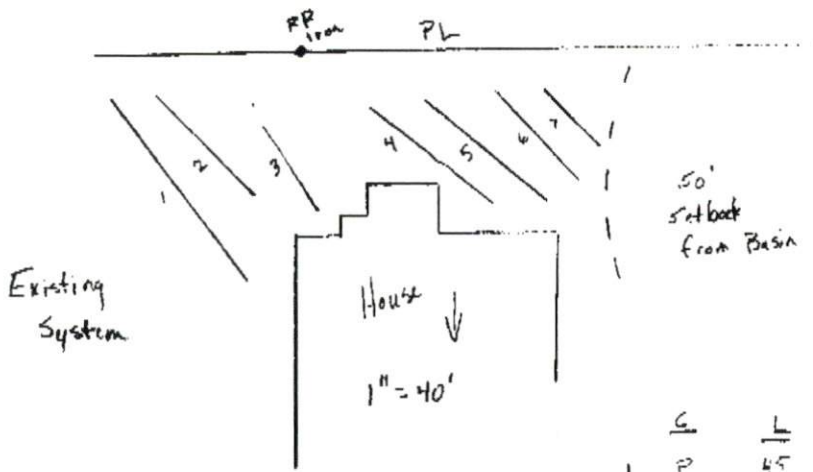

3 BDRM
 .375 as permitted
 160' PPBPS required for repair

Typical Soils
 0-18-5L
 18-46 SCL
 <2-46"

Repair System may
 require Pressure Manifold
 to equally distribute effluent

	<u>C</u>	<u>L</u>
1	P	45
2	K	31
3	Y	20
4	K	32
5	Y	33
6	P	25
7	R	14
		<hr/> 205 Total





205 Total

7	R	16
6	R	25
5	V	33
4	K	32
3	V	20
2	K	34
1	P	45
5	L	

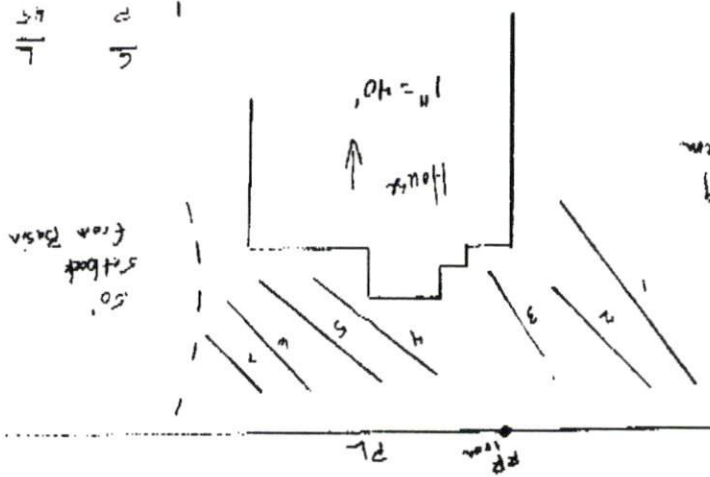

Repair System may require Pressure Manifold to equally distribute effluent

Typical Soils

0-18-5L
18-46 SL
42-46"

3 BDRM
.375 as permitted
160' PPBPS required for repair

Lot 14 Dexterfield