



Harnett County Government Complex
307 Cornelius Harnett Boulevard
Lillington, NC 27546

ph: 910-893-7550

fax: 910-893-9429

March 15, 2007

R & R Enterprises of Fayetteville
5431 Rodwell Rd
Fayetteville, NC 28311

RE: Harnett County Land Use Application 06-5-15961R

Dear Sir or Madam:

An Environmental Health Specialist from the Harnett County Health Department attempted to evaluate your property for the purpose of issuing an Improvement Permit. This individual was unable to evaluate your property for one or more of the following reasons.

- 1. Property lines/corners not marked or labeled
- 2. House corners not marked or labeled
- 3. Directions not clear to property
- 4. Property needs brush or vegetation removed
- 5. Backhoe pits required
- 6. Other **Home must match attached plan. Please submit new plot plan with changes to Central Permitting and follow their instructions.**

If you should have any questions, I can be reached at 910-893-7547 Monday thru Friday from 8am to 9am.

Sincerely,

Joe West, R.S.
Environmental Health Specialist
Harnett County Health Department

JW/sgw

Copy: Central Permitting

06-50015961R

Lot 43 Colonial Hills

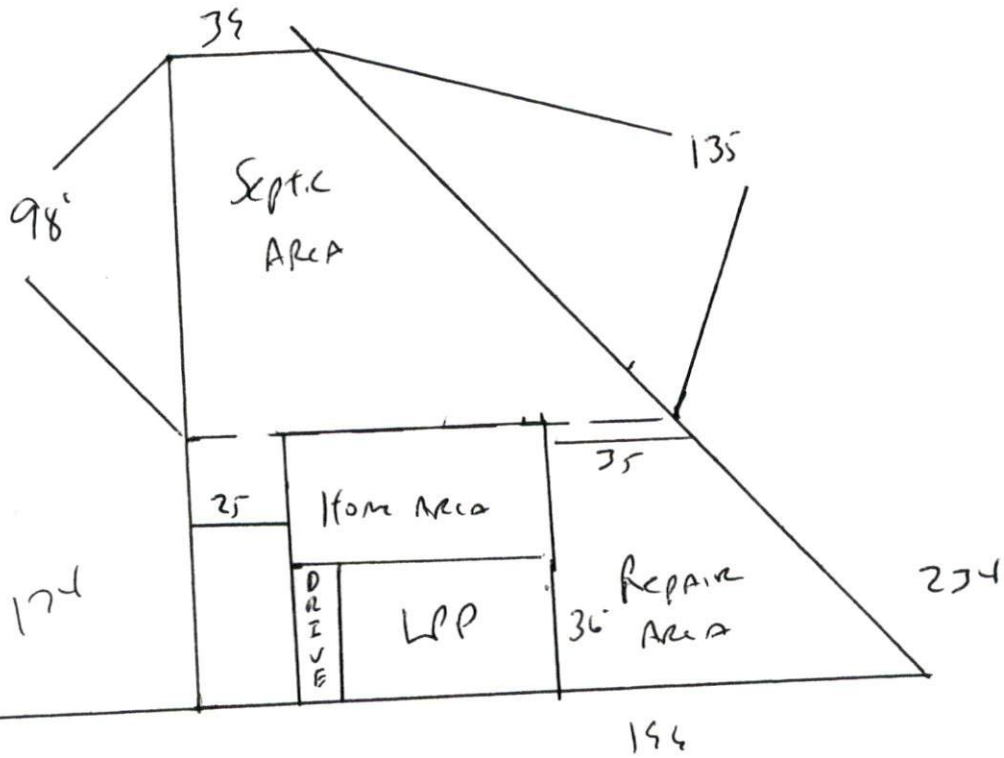

← To SR 1116

Road

194