

HTE# 06-5-15844

Har t County Department of Public Health

23722

Improvement Permit

A building permit cannot be issued with only an Improvement Permit

ISSUED TO: EDWARD L MARTIN JR

PROPERTY LOCATION: SR1440 James Norris
SUBDIVISION Kennes Creek Sec 2 LOT # 41

NEW REPAIR EXPANSION

Site Improvements required prior to Construction Authorization Issuance:

Type of Structure: SFD

Proposed Wastewater System Type: 25% RED System

Projected Daily Flow: 360 GPD

Number of bedrooms: 3 Number of Occupants: 6 max

Basement Yes No

Pump Required: Yes No May be required based on final location and elevations of facilities

Type of Water Supply: Community Public Well Distance from well _____ feet

Permit valid for: Five years

Permit conditions: SEPTIC TANK MUST BE ON LEFT FRONT CORNER OF HOME WITH FRONT
YARD CLEARED TO ALLOW FOR DRAINFIELD - IF NOT ABLE TO DEMONSTRATE SYSTEM
LAYOUT WELL REQUIRE PUMP + RELAY OUT ON SEPTIC SYSTEM

Authorized State Agent: James E. Manhart Date: 2-22-07 SEE ATTACHED SITE SKETCH

The issuance of this permit by the Health Department in no way guarantees the issuance of other permits. The permit holder is responsible for checking with appropriate governing bodies in meeting their requirements. This site is subject to revocation if the site plan, plat, or the intended use changes. The Improvement Permit shall not be affected by a change in ownership of the site. This permit is subject to compliance with the provisions of the Laws and Rules for Sewage Treatment and Disposal and to conditions of this permit.

Construction Authorization

(Required for Building Permit)

The construction and installation requirements of Rules .1950, .1952, .1954, .1955, .1956, .1957, .1958, and .1959 are incorporated by references into this permit and shall be met. Systems shall be installed in accordance with the attached system layout.

ISSUED TO: EDWARD L MARTIN JR

PROPERTY LOCATION: SR1440 James Norris

SUBDIVISION Kennes Creek Sec 2 LOT # 41

Facility Type: SFD New Expansion Repair

Basement? Yes No Basement Fixtures? Yes No

Type of Wastewater System** 25% REDUCTION (Initial) Wastewater Flow: 360 GPD

(See note below, if applicable)
25% REDUCTION SYSTEM (Repair)

Installation Requirements/Conditions

Septic Tank Size 1000 gallons Exact length of each trench 150 feet Trench Spacing: 9 Feet on Center

Pump Tank Size _____ gallons Trenches shall be installed on contour at a Soil Cover: 6 inches
Maximum Trench Depth of: 28-18 inches (Maximum soil cover shall not exceed
(Trench bottoms shall be level to +1-1/4" 36" above the trench bottom)
in all directions)

Pump Requirements: _____ ft. TDH vs. _____ GPM Aggregate Depth: 6 inches below pipe

Conditions: *SAME AS PERMIT CONDITIONS ABOVE. 2 inches above pipe
12 inches total

**If applicable: I understand the system type specified is different from the type specified on the application. I accept the specifications of this permit.

Owner/Legal Representative Signature: _____ Date: _____

This Construction Authorization is subject to revocation if the site plan, plat, or the intended use changes. The Construction Authorization shall not be transferred when there is a change in ownership of the site. This Construction Authorization is subject to compliance with the provisions of the Laws and Rules for Sewage Treatment and Disposal and to the conditions of this permit.

SEE ATTACHED SITE SKETCH

Authorized State Agent: James E. Manhart Date: 2-22-07

Construction Authorization Expiration Date: 2-22-12

HTE# 06-5-15844

Permit # 23722

Harnett County Department of Public Health Site Sketch

PROPERTY LOCATOR: 561440 James Norris

ISSUED TO: EDWARD L MARTIN JR SUBDIVISION Kenneths Creek Sec 2 LOT # 41

Authorized State Agent: James E. Manhart Date: 2-22-07

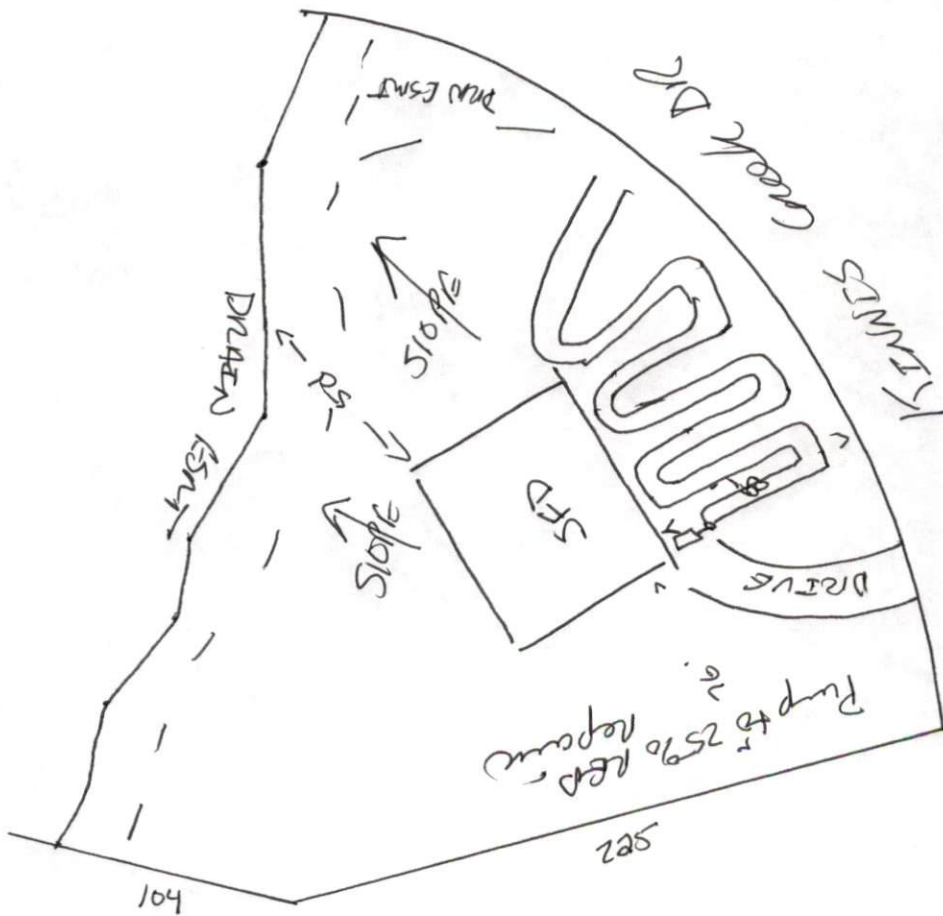

* TAKE NOTICE
TO TANK
PLACEMENT
REFER BACK
TO PERMIT
ISSUED
STATEMENT.