

HTE# 06-500/56162

Harriet County Department of Public Health

23406

Improvement Permit

A building permit cannot be issued with only an Improvement Permit

ISSUED TO: H & H Const.

PROPERTY LOCATION: 1125
SUBDIVISION: Woodbine LOT # 150

NEW REPAIR EXPANSION
Type of Structure: SFD 4BR 60x62
Proposed Wastewater System Type: 25% Reduction System
Projected Daily Flow: 480 GPD
Number of bedrooms: 4 Number of Occupants: 8 max

Site Improvements required prior to Construction Authorization Issuance:

Basement Yes No
Pump Required: Yes No May be required based on final location and elevations of facilities
Type of Water Supply: Community Public Well Distance from well 50 feet Permit valid for: Five years
Permit conditions: SMUB out Plumbing shallow pt ground level where shown
Maintain ALL JET BATH meet onsite No expiration

Authorized State Agent: J. Lani Date: 11-21-06 SEE ATTACHED SITE SKETCH

The issuance of this permit by the Health Department in no way guarantees the issuance of other permits. The permit holder is responsible for checking with appropriate governing bodies in meeting their requirements. This site is subject to revocation if the site plan, plat, or the intended use changes. The Improvement Permit shall not be affected by a change in ownership of the site. This permit is subject to compliance with the provisions of the Laws and Rules for Sewage Treatment and Disposal and to conditions of this permit.

Construction Authorization

(Required for Building Permit)

The construction and installation requirements of Rules .1950, .1952, .1954, .1955, .1956, .1957, .1958, and .1959 are incorporated by references into this permit and shall be met. Systems shall be installed in accordance with the attached system layout.

ISSUED TO: H & H Const. PROPERTY LOCATION: 1125
SUBDIVISION: Woodbine LOT # 150

Facility Type: SFD 60x62 New Expansion Repair
Basement? Yes No Basement Fixtures? Yes No
Type of Wastewater System** 25% Reduction System (Initial) Wastewater Flow: 480 GPD
(See note below, if applicable) ATU to LPP @ (Repair)

Installation Requirements/Conditions 180 LF

Septic Tank Size 1000 gallons Exact length of each trench 1x 150 feet Trench Spacing: 9 Feet on Center
Pump Tank Size _____ gallons Trenches shall be installed on contour at a Soil Cover: 6 inches
Maximum Trench Depth of: 18-30 inches (Maximum soil cover shall not exceed 36" above the trench bottom)
(Trench bottoms shall be level to +1-1/4" in all directions)

Pump Requirements: _____ ft. TDH vs. _____ GPM _____ inches below pipe
Aggregate Depth: _____ inches above pipe
Conditions: Meet onsite _____ inches total

*If applicable: I understand the system type specified is different from the type specified on the application. I accept the specifications of this permit.

Owner/Legal Representative Signature: _____ Date: _____

This Construction Authorization is subject to revocation if the site plan, plat, or the intended use changes. The Construction Authorization shall not be transferred when there is a change in ownership of the site. This Construction Authorization is subject to compliance with the provisions of the Laws and Rules for Sewage Treatment and Disposal and to the conditions of this permit.

Authorized State Agent: J. Lani Date: 11-21-06 SEE ATTACHED SITE SKETCH

Construction Authorization Expiration Date: 11-21-2011

HTE# 06-500 15616R

Permit # 23406

Harnett County Department of Public Health Site Sketch

ISSUED TO: H&H Const.

PROPERTY LOCATOR: 1125
SUBDIVISION: Woodbine

LOT # 150

Authorized State Agent: J. L. [Signature]

Date: 11-21-06

Temp
Storm
Pond

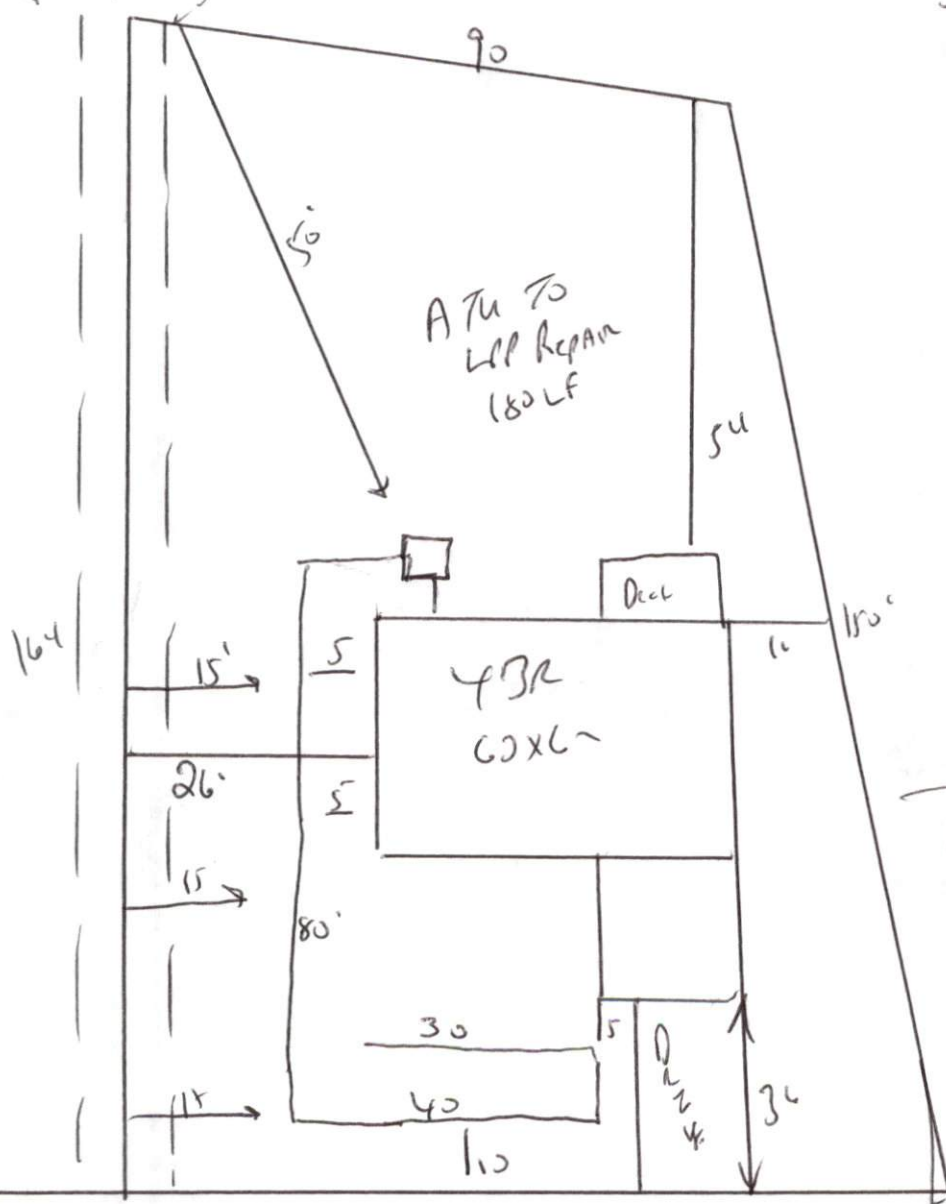

STUB out Plumbing
Shallow where shown
Keep system 50'
from Temp. Storm pond
Keep drain 15' from
Property line with Easement
Along it.

Install 1x150 1/2" 25%
Reduction system at
18 to 30" Deep
Meet onsite.

Repair Requirement of
ATU To LPP may not
be needed after Temp.
Storm pond is filled
in. (Using ATU To Reduce
Set Back to Storm pond)

107

Wood Point Dr.