

HTE# D050015573

Harnett County Department of Public Health

23251

Improvement Permit

A building permit cannot be issued with only an Improvement Permit

ISSUED TO: Kmac Custom Homes Inc. PROPERTY LOCATION: 1437 Ballard Rd FV NC 27526
SUBDIVISION Riverstone LOT # 17

NEW REPAIR EXPANSION Site Improvements required prior to Construction Authorization Issuance:

Type of Structure: sfd

Proposed Wastewater System Type: 25% Reduction

Projected Daily Flow: 300 gpd GPD

Number of bedrooms: 3 Number of Occupants: 6 max

Basement Yes No

Pump Required: Yes No May be required based on final location and elevations of facilities

Type of Water Supply: Community Public Well Distance from well 100 feet Permit valid for: Five years No expiration

Permit conditions: maintain all required setbacks.

Authorized State Agent: Jamie Twilington RS Date: 8/30/10 SEE ATTACHED SITE SKETCH

The issuance of this permit by the Health Department in no way guarantees the issuance of other permits. The permit holder is responsible for checking with appropriate governing bodies in meeting their requirements. This site is subject to revocation if the site plan, plat, or the intended use changes. The Improvement Permit shall not be affected by a change in ownership of the site. This permit is subject to compliance with the provisions of the Laws and Rules for Sewage Treatment and Disposal and to conditions of this permit.

Construction Authorization

(Required for Building Permit)

The construction and installation requirements of Rules .1950, .1952, .1954, .1955, .1956, .1957, .1958, and .1959 are incorporated by references into this permit and shall be met. Systems shall be installed in accordance with the attached system layout.

ISSUED TO: Kmac Custom Homes, Inc. PROPERTY LOCATION: 1437 Ballard Road FV, NC 27526
SUBDIVISION Riverstone LOT # 17

Facility Type: sfd 53' x 50' New Expansion Repair

Basement? Yes No Basement Fixtures? Yes No

Type of Wastewater System** 25% Reduction (Initial) Wastewater Flow: 300 GPD

(See note below, if applicable LPP (Repair)

Installation Requirements/Conditions

Septic Tank Size 1000 gallons Exact length of each trench 90 feet Trench Spacing: 3 Feet on Center

Pump Tank Size _____ gallons Trenches shall be installed on contour at a Soil Cover: 12-18 inches

Maximum Trench Depth of: 18-20 inches (Maximum soil cover shall not exceed 36" above the trench bottom)

Pump Requirements: _____ ft. TDH vs. _____ GPM in all directions) Aggregate Depth: 6" inches below pipe 2" inches above pipe

Conditions: _____ 12' inches total

**If applicable: *I understand the system type specified is different from the type specified on the application. I accept the specifications of this permit.*

Owner/Legal Representative Signature: _____ Date: _____

This Construction Authorization is subject to revocation if the site plan, plat, or the intended use changes. The Construction Authorization shall not be transferred when there is a change in ownership of the site. This Construction Authorization is subject to compliance with the provisions of the Laws and Rules for Sewage Treatment and Disposal and to the conditions of this permit.

Authorized State Agent: Jamie Twilington RS Date: 8/30/10 SEE ATTACHED SITE SKETCH

Construction Authorization Expiration Date: 8/30/11

HTE# 0050015573

Permit # 23251

Harnett County Department of Public Health Site Sketch

PROPERTY LOCATOR: 1437 Ballard Road

ISSUED TO: Kmac Custom Homes Inc SUBDIVISION Riverstone LOT # 17

Authorized State Agent: Jamie Twilington RS Date: 8-30-06

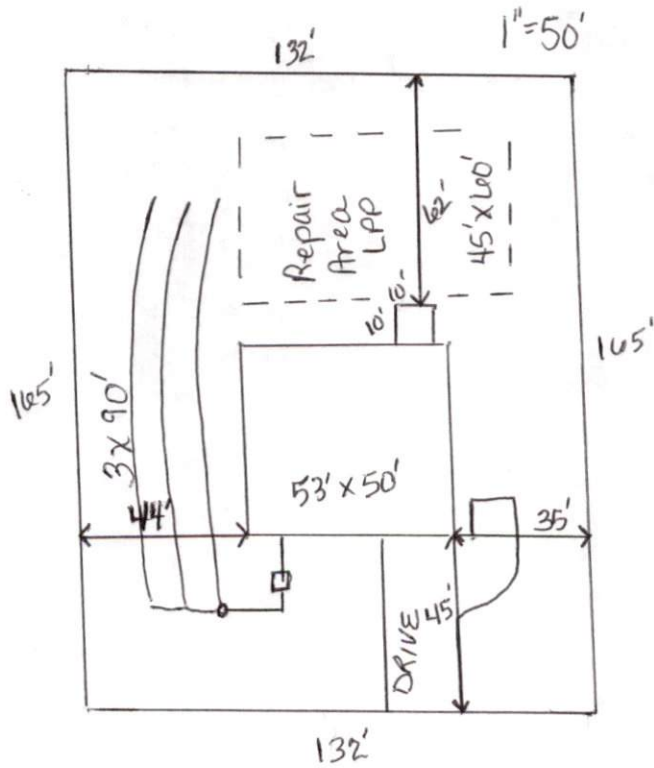

* maintain all required setbacks.