

HTE# 06-50015566

IMPROVEMENT PERMIT

23196

Be it ordained by the Harnett County Board of Health as follows: Section III, Item B. "No person shall begin construction of any building at which a septic tank system is to be used for disposal of sewage without first obtaining a written permit from the Harnett County Health Department."

Name: (owner) Steve Jernigan New Installation Septic Tank Repair

Property Location: SR# 27 Nitrification Line Expansion

Subdivision Laurel Valley Lot # 40

Tax ID# _____ Quadrant # _____

Number of Bedrooms Proposed: 3(360gpd) Lot Size: .34ac

Basement with Plumbing: Garage:

Water Supply: Well Public Community

Distance From Well: 100 ft.

Following is the minimum specifications for sewage disposal system on above captioned property. Subject to final approval.

Type of system: Conventional Other 25% Reduction System

Size of tank: Septic Tank: 1000 gallons Pump Tank: _____ gallons

Subsurface No. of exact length width of depth of
Drainage Field ditches 1 of each ditch 130 ft. ditches 3 ft. ditches 18-24 in.
of 25% Reduction System

French Drain Required: _____ Linear feet

Date: 8/23/06
PERMIT EXPIRES 5 YEARS FROM ABOVE DATE

This permit is subject to revocation if site plans or intended use change.

Signed: [Signature]
Environmental Health Specialist
[Signature]
1"=60'

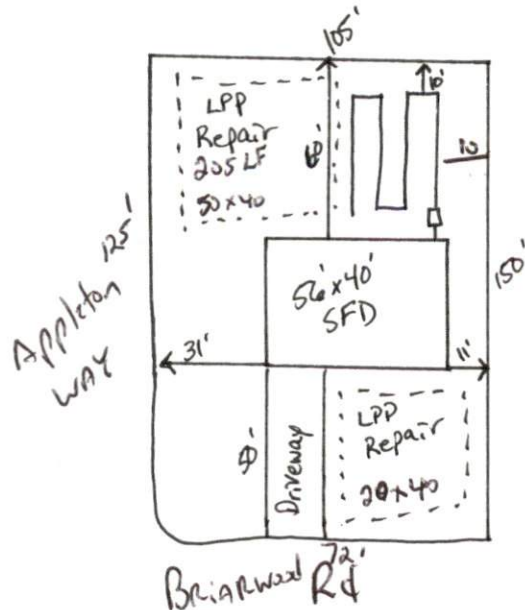

* maintain all setbacks
* Stub out plumbing shallow

HARNETT COUNTY DEPARTMENT OF PUBLIC HEALTH AUTHORIZATION TO CONSTRUCT

Authorization is hereby given to construct a wastewater system to the specifications described by Harnett County Department of Public Health, Improvement Permit # 23196. This authorization shall be valid for a period not to exceed five (5) years from the date of issuance. ***This authorization will be invalid if ownership, site plans, or intended use change.***

Name Steve Jernigan Telephone # 919-625-0363

Address 4609 Forest Highland Dr. Raleigh, NC 27604

Property Location SR# 27 Road Name NC 27

Subdivision Laurel Valley Lot # 40 # Bedrooms Proposed 3 (360gpd) Lot Size .34AC

TYPE OF SYSTEM

New Installation Repair Septic Tank Nitrification Lines

Conventional Other 25% Reduction System

Basement With Plumbing Without Plumbing

Water Supply: Well Public Water Supply Minimum Well Setback: 100 Ft.

Septic Tank 1000 gal Pump Chamber _____ gal

NITRIFICATION FIELD SPECIFICATIONS

Number of fields 1 # of lines per field 1 Length of lines 130 Ft.

Width of ditches 3 ft. Depth of ditches 18-24 inches

French Drain: Linear feet required _____ Depth of gravel _____

No wastewater system shall be covered or placed into use by any person until an inspection by the Harnett County Health Department has determined that the system has been installed according to the conditions of the Improvement Permit and that a valid Operations Permit has been issued.

Catherine Pierce
Signature of Authorized Agent for Harnett County

8/17/06
Date