

HTE# 06-5-15492

# IMPROVEMENT PERMIT 23126

Be it ordained by the Harnett County Board of Health as follows: Section III, Item B. "No person shall begin construction of any building at which a septic tank system is to be used for disposal of sewage without first obtaining a written permit from the Harnett County Health Department."

Name: (owner) Marshall Johnson Construction New Installation  Septic Tank  Repair

Property Location: SR# 1703 RED HILL CH RD Nitrification Line  Expansion

Subdivision CANE MILL ESTATES Lot # 22

Tax ID# \_\_\_\_\_ Quadrant # \_\_\_\_\_

Number of Bedrooms Proposed: 4 BM - 4806 PD Lot Size: 1.40 ACRES

Basement with Plumbing:  Garage:

Water Supply:  Well  Public  Community

Distance From Well: 50 ft.

**Following is the minimum specifications for sewage disposal system on above captioned property. Subject to final approval.**

Type of system:  Conventional  Other 25% Reduction System

Size of tank: Septic Tank: 1200 gallons Pump Tank: \_\_\_\_\_ gallons

Subsurface No. of exact length width of depth of  
Drainage Field ditches 4 ft. of each ditch 100 ft. ditches 3 ft. ditches 22" max in.

French Drain Required: — Linear feet

Date: 8-14-06

**This permit is subject to revocation if site plans or intended use change.**

**PERMIT EXPIRES 5 YEARS FROM ABOVE DATE**

Signed: James E. Mardon  
Environmental Health Specialist

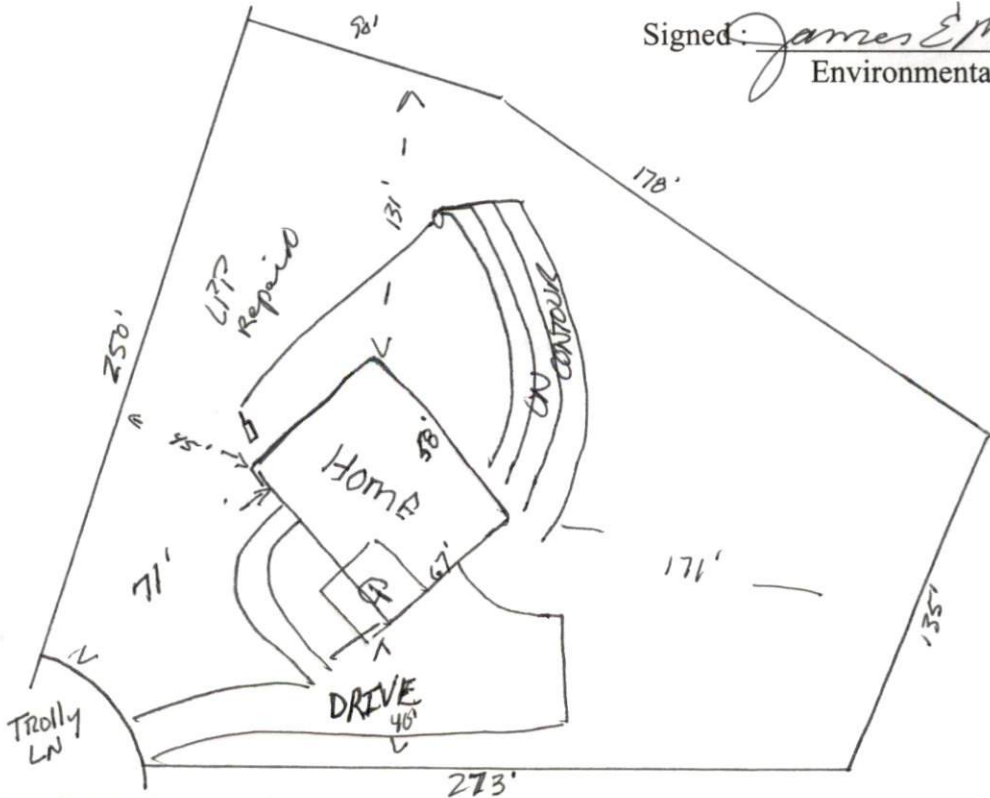

# HARNETT COUNTY DEPARTMENT OF PUBLIC HEALTH AUTHORIZATION TO CONSTRUCT

Authorization is hereby given to construct a wastewater system to the specifications described by Harnett County Department of Public Health, Improvement Permit # 25126. This authorization shall be valid for a period not to exceed five (5) years from the date of issuance. ***This authorization will be invalid if ownership, site plans, or intended use change.***

Name Marshall Johnson Construction Telephone # 919-854-2064

Address 283 BARNEK EIK RD BENSON N.C. 27504

Property Location SR# 1703 Road Name RED HILL CH RD

Subdivision CASEMILL EST Lot # 22 # Bedrooms Proposed 4 BDR 480 GPD Lot Size 1.40

### TYPE OF SYSTEM

New Installation    Repair    Septic Tank    Nitrification Lines

Conventional    Other 25% Reduction Syst

Basement    With Plumbing    Without Plumbing

Water Supply:  Well    Public Water Supply Minimum Well Setback: \_\_\_\_\_ Ft.

Septic Tank 1200 gal   Pump Chamber \_\_\_\_\_ gal

### NITRIFICATION FIELD SPECIFICATIONS

Number of fields 2 # of lines per field 4 Length of lines 100 Ft.

Width of ditches 3 ft. Depth of ditches 22" inches

French Drain: Linear feet required \_\_\_\_\_ Depth of gravel \_\_\_\_\_

No wastewater system shall be covered or placed into use by any person until an inspection by the Harnett County Health Department has determined that the system has been installed according to the conditions of the Improvement Permit and that a valid Operations Permit has been issued.

James E. Montfort  
Signature of Authorized Agent for Harnett County

8/14/06  
Date