

Improvement Permit

A building permit cannot be issued with only an Improvement Permit

ISSUED TO: OAK CITY HOMES PROPERTY LOCATION: BALLARD RD
 NEW REPAIR EXPANSION SUBDIVISION: BALLARD WOODS LOT # 96
 Type of Structure: SFD Site Improvements required prior to Construction Authorization Issuance:
 Proposed Wastewater System Type: PUMP TO 25% REDUCTION. (.1955p)
 Projected Daily Flow: 360 GPD
 Number of bedrooms: 3 Number of Occupants: 6 max
 Basement Yes No
 Pump Required: Yes No May be required based on final location and elevations of facilities
 Type of Water Supply: Community Public Well Distance from well 100 feet Permit valid for: Five years
 Permit conditions: PERMIT WRITTEN BASED ON RULE .1955p . 75% OF EACH SYSTEM DESIGNED No expiration

Authorized State Agent: [Signature] Date: 2/2/07 SEE ATTACHED SITE SKETCH
 The issuance of this permit by the Health Department in no way guarantees the issuance of other permits. The permit holder is responsible for checking with appropriate governing bodies in meeting their requirements. This site is subject to revocation if the site plan, plat, or the intended use changes. The Improvement Permit shall not be affected by a change in ownership of the site. This permit is subject to compliance with the provisions of the Laws and Rules for Sewage Treatment and Disposal and to conditions of this permit.

Construction Authorization

(Required for Building Permit)

The construction and installation requirements of Rules .1950, .1952, .1954, .1955, .1956, .1957, .1958, and .1959 are incorporated by references into this permit and shall be met. Systems shall be installed in accordance with the attached system layout.

ISSUED TO: OAK CITY HOME PROPERTY LOCATION: BALLARD RD
 SUBDIVISION: BALLARD WOODS LOT # 96
 Facility Type: SFD New Expansion Repair
 Basement? Yes No Basement Fixtures? Yes No
 Type of Wastewater System** Pump To 25% REDUCT. (Initial) Wastewater Flow: 360 GPD
 (See note below, if applicable * RULE .1955p USED
Pump To 25% REDUCT. (Repair)

Installation Requirements/Conditions

Septic Tank Size 1000 gallons Exact length of each trench 225 feet Trench Spacing: 9 Feet on Center
 Pump Tank Size 1000 gallons Trenches shall be installed on contour at a Soil Cover: 6-10 inches
 Maximum Trench Depth of: 18-22 inches (Maximum soil cover shall not exceed 36" above the trench bottom)
 Pump Requirements: _____ ft. TDH vs. _____ GPM _____ inches below pipe
 Aggregate Depth: _____ inches above pipe
 Conditions: ALL CONDITIONS OF .1955p MUST BE MET INCLUDING STRENGTH OF DIVERSION VALVE _____ inches total
AREA DRAINFIELD MUST BE EVALUATED FOR WITNESS CONDITIONS BY THE HEALTH DEPT. PRIOR TO INSTALLATION

**If applicable: I understand the system type specified is different from the type specified on the application. I accept the specifications of this permit.
 Owner/Legal Representative Signature: _____ Date: _____

This Construction Authorization is subject to revocation if the site plan, plat, or the intended use changes. The Construction Authorization shall not be transferred when there is a change in ownership of the site. This Construction Authorization is subject to compliance with the provisions of the Laws and Rules for Sewage Treatment and Disposal and to the conditions of this permit.

Authorized State Agent: [Signature] Date: 2/2/07 SEE ATTACHED SITE SKETCH
 Construction Authorization Expiration Date: 2/2/12

HTE# 06-5-15446

Permit # 23525

Harnett County Department of Public Health Site Sketch

PROPERTY LOCATOR: BALLARD RD

ISSUED TO: OAK CITY HOMES

SUBDIVISION BALLARD WOODS

LOT # 96

Authorized State Agent: ~~is~~ RS

Date: 2/2/07

- * NEW PERMIT ISSUED DUE TO SITE DISTURBANCE WHICH AFFECTED DRAINFIELD AREA OF ORIGINAL PERMIT
- * PERMIT ISSUED USING RULE 1955P - COPY ATTACHED
- INITIAL AND REPAIR SYSTEMS ^{TO BE} INSTALLED

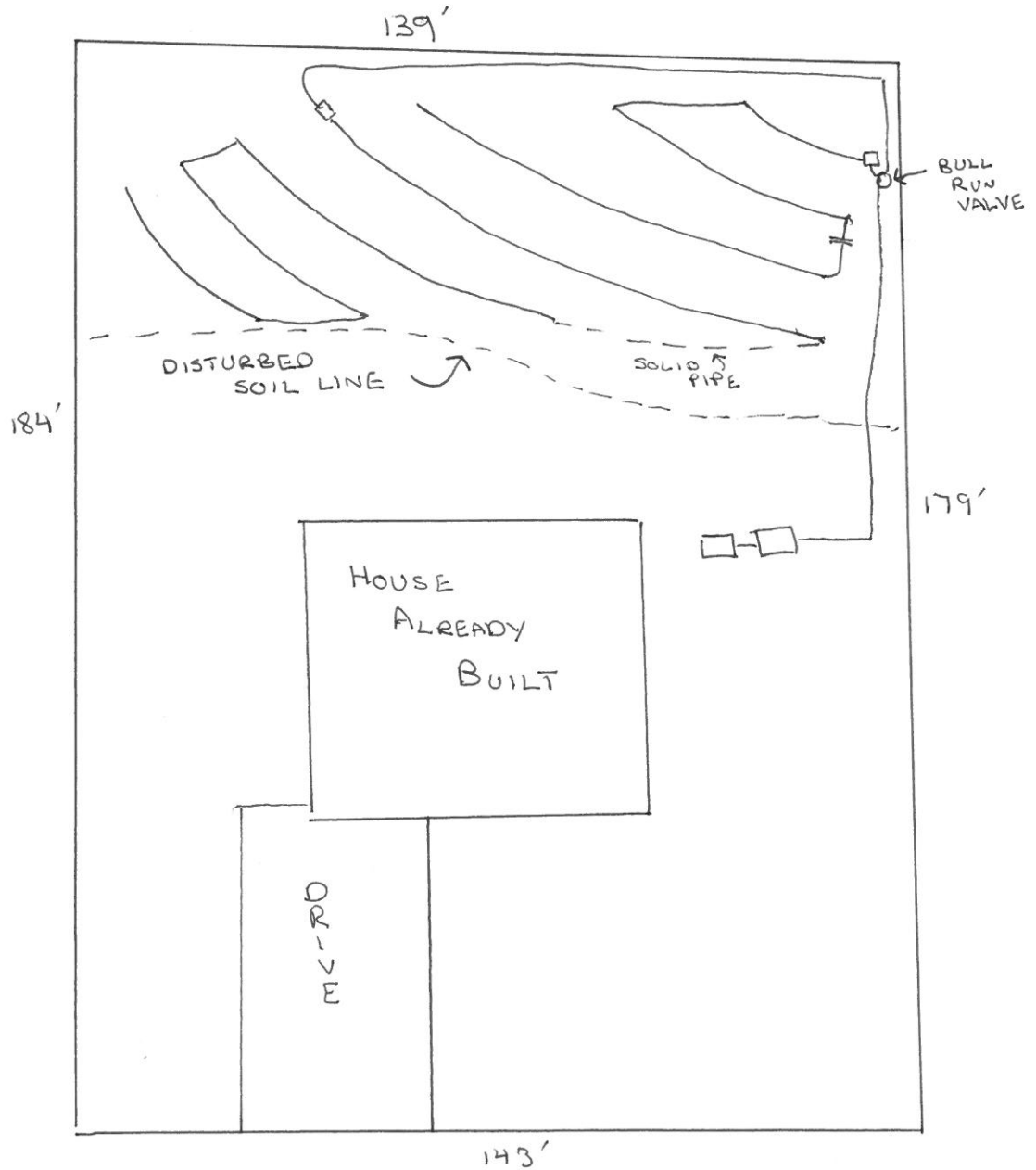

or within 50 feet of any private water supply source or any surface waters classified WS-I, WS-II, WS-III, SA, SB, or B.

- (7) Cleanouts may be used instead of manholes for four-inch and six-inch sewers serving one or two buildings or as otherwise allowed by the North Carolina Plumbing Code. When used, cleanouts are required at least every 50 feet for four-inch sewers and every 100 feet for six-inch sewers and at all junctions and bends which exceed 45 degrees.
- (8) Additional ventilation provisions may be required for collection sewers. Air relief valves shall be provided as needed for force mains.

(p) Alternating dual field nitrification systems may be utilized where soils are limited by high clogging potentials (Soil Groups III and IV) and where the potential for malfunction and need for immediate repair is required. Alternating dual nitrification fields shall be designed with two complete nitrification fields, each sized a minimum of 75 percent of the total area required for a single field and separated by an effluent flow diversion valve. The diversion valve shall be constructed to resist 500 pounds crushing strength, structurally sound, and shall be resistant to corrosion. Valves placed below ground level shall be provided with a valve box and suitable valve stem so that they may be operated from the ground surface.

*History Note: Authority G.S. 130A-335 (e)(f)(1)[2nd];
Eff. July 1, 1982;
Amended Eff. August 1, 1991; January 1, 1990; August 1, 1988; February 1, 1987;
Temporary Amendment Eff. January 1, 1999;
Amended Eff. August 1, 2000.*