

HTE # 06-50015257

NETT COUNTY HEALTH DEPARTMENT  
ENVIRONMENTAL HEALTH SECTION

18712

# OPERATIONS PERMIT

Name: (owner) JCH Contracting + Dev. Group, LLC  New Installation  Septic Tank  Repair

Property Location: SR# 2026 BYRO POND RD  Nitrification Line  Expansion

Subdivision BYRO POND EST Lot # 14 Tax ID # \_\_\_\_\_ Quadrant # \_\_\_\_\_

Contractor: Jones Registration # \_\_\_\_\_

Basement with Plumbing:  Garage:

Water Supply:  Well  Public  Community

Distance From Well: 100 ft.

Following are the specifications for the sewage disposal system on above captioned property.

Type of system:  Conventional  Other 25% Reduction (Quick 4 Chamber)

Size of tank: Septic Tank: 1000 gallons Pump Tank: \_\_\_\_\_ gallons

Subsurface Drainage Field No. of ditches 3 exact length of each ditch 75 ft. width of ditches 3 ft. depth of ditches 18-28 in.

French Drain Required: \_\_\_\_\_ Linear feet

Date: 9-12-06

PERMIT NO. 21796

Inspected by: Jamie Twilinger

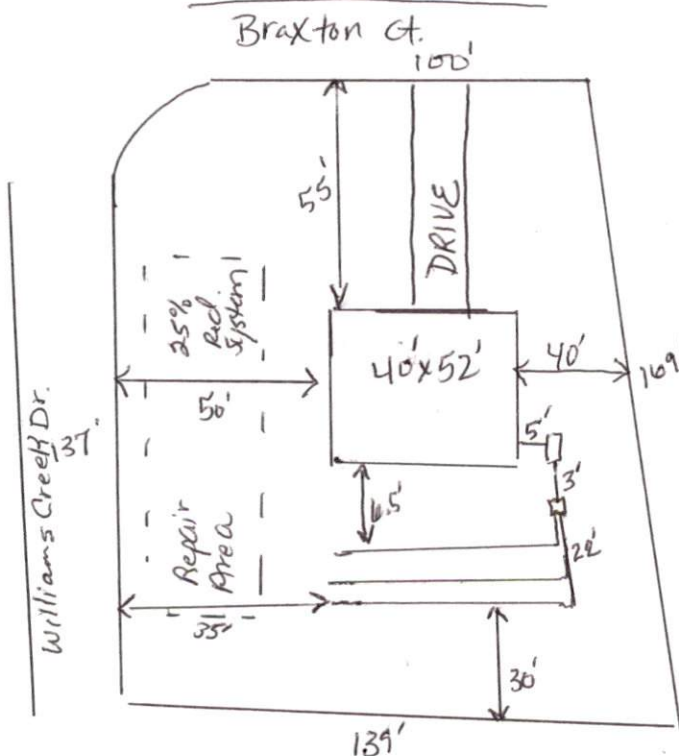

BTS-1000  
STB-103  
7-06