

HTE# 0650015084R

# IMPROVEMENT PERMIT 23082

Be it ordained by the Harnett County Board of Health as follows: Section III, Item B. "No person shall begin construction of any building at which a septic tank system is to be used for disposal of sewage without first obtaining a written permit from the Harnett County Health Department."

Name: (owner) Weaver Development New Installation  Septic Tank  Repair

Property Location: SR# 1115 Buffalo Lake Rd. Nitrification Line  Expansion

Subdivision The Summit Lot # 47

Tax ID# \_\_\_\_\_ Quadrant # \_\_\_\_\_

Number of Bedrooms Proposed: 3(360sqft) Lot Size: .41ac

Basement with Plumbing:  Garage:

Water Supply:  Well  Public  Community

Distance From Well: 100 ft.

Following is the minimum specifications for sewage disposal system on above captioned property. Subject to final approval.

Type of system:  Conventional  Other 25% reduction system

Size of tank: Septic Tank: 1000 gallons Pump Tank: \_\_\_\_\_ gallons

Subsurface Drainage Field No. of ditches 2 exact length of each ditch 75 ft. width of ditches 3 ft. depth of ditches 18-24 in.

French Drain Required: \_\_\_\_\_ Linear feet of 25% Reduction system

Date: 6/30/06

This permit is subject to revocation if site plans or intended use change. PERMIT EXPIRES 5 YEARS FROM ABOVE DATE

Signed: Cynthia Pierce for WJL  
Environmental Health Specialist

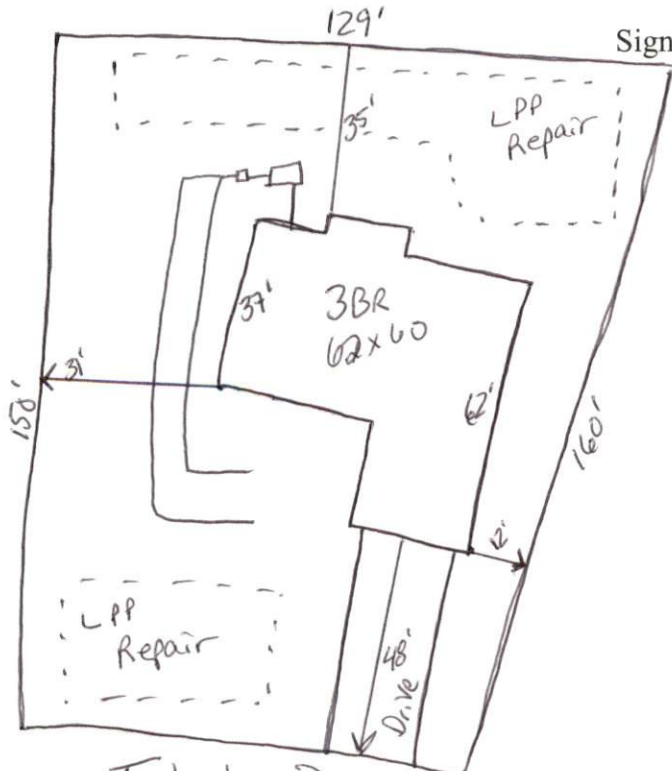

- maintain all setbacks
- stub out plumbing shallow at ground level or higher where shown
- meet on site for final layout - final layout may change.

Timberline Dr.