

HTE# 06-5-15051

IMPROVEMENT PERMIT 22997

Be it ordained by the Harnett County Board of Health as follows: Section III, Item B. "No person shall begin construction of any building at which a septic tank system is to be used for disposal of sewage without first obtaining a written permit from the Harnett County Health Department."

Name: (owner) CUMBERLAND HOMES New Installation Septic Tank Repair
 Property Location: SR# 1108 CAMERON HILL RD Nitrification Line Expansion
 Subdivision YORKSHIRE PLANTATION Lot # 182
 Tax ID# _____ Quadrant # _____
 Number of Bedrooms Proposed: 3 (360 sqd) Lot Size: .95ac

Basement with Plumbing: Garage:
 Water Supply: Well Public Community
 Distance From Well: 100 ft.

Following is the minimum specifications for sewage disposal system on above captioned property. Subject to final approval.

Type of system: Conventional Other PUMP TO 25% REDUCTION SYSTEM
 Size of tank: Septic Tank: 1000 gallons Pump Tank: 1000 gallons

Subsurface Drainage Field No. of ditches 1 exact length 200 ft. width of ditches 3 ft. depth of ditches 12 in.

French Drain Required: _____ Linear feet

Date: 6/29/06
PERMIT EXPIRES 5 YEARS FROM ABOVE DATE

This permit is subject to revocation if site plans or intended use change.

Signed: [Signature] ALS (OLIVER TOLKSDORF)
 Environmental Health Specialist

- * RETENTION POND TO BE MOVED OR FILLED IN PRIOR TO OP BEING ISSUED
- * TANKS CAN BE PLACED ANYWHERE THEY DONT INTERFERE WITH DRAINFIELD
- * CALL WITH ANY QUESTIONS PRIOR TO INSTALLATION
- * HOUSE FOUNDATION ALREADY POURED
- * MINIMUM OF 6" OF COVER NEEDED OVER DRAINFIELD
- * THIS PERMIT TAKES PRECEDENCE OVER ANY OTHER PERMIT FOR THIS LOT

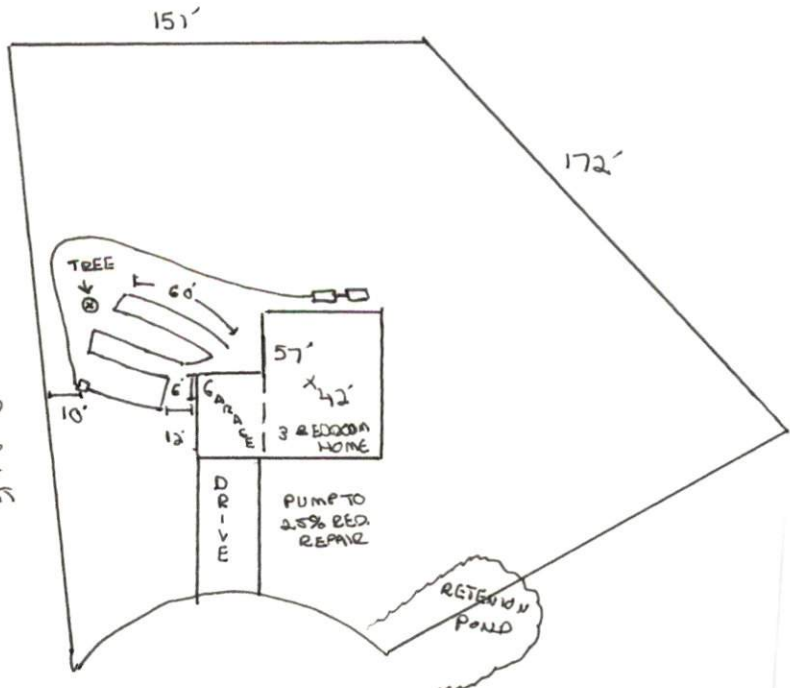

HARNETT COUNTY DEPARTMENT OF PUBLIC HEALTH
AUTHORIZATION TO CONSTRUCT

Authorization is hereby given to construct a wastewater system to the specifications described by Harnett County Department of Public Health, Improvement Permit # 22997. This authorization shall be valid for a period not to exceed five (5) years from the date of issuance. *This authorization will be invalid if ownership, site plans, or intended use change.*

CUMBERLAND HOMES 892-4345
Name Telephone #

PO BOX 727 DUNN NC 28335
Address

1108 CAMERON HILL RD
Property Location SR# Road Name

YORKSHIRE PLANTATION 182 3 (360 sq ft) .95 ac
Subdivision Lot # # Bedrooms Proposed Lot Size

TYPE OF SYSTEM

New Installation Repair Septic Tank Nitrification Lines

Conventional Other PUMP TO 25% REDUCTION SYSTEM

Basement With Plumbing Without Plumbing

Water Supply: Well Public Water Supply Minimum Well Setback: 100 Ft.

Septic Tank 1000 gal Pump Chamber 1000 gal

NITRIFICATION FIELD SPECIFICATIONS

Number of fields 1 # of lines per field 1 Length of lines 200 Ft.

Width of ditches 3 ft. Depth of ditches 12 inches

French Drain: Linear feet required _____ Depth of gravel _____

No wastewater system shall be covered or placed into use by any person until an inspection by the Harnett County Health Department has determined that the system has been installed according to the conditions of the Improvement Permit and that a valid Operations Permit has been issued.

[Signature]
Signature of Authorized Agent for Harnett County

6/29/06
Date