

**SOIL/SITE EVALUATION  
 for ON-SITE WASTEWATER SYSTEM**

Owner:  
 Address:  
 Proposed Facility: **3BR** Design Flow (.1949): **360 gpd**  
 Location of Site: **Lot 162 Woodshire**  
 Water Supply:  Public  Individual  Well  
 Evaluation Method:  Auger Boring  Pit  
 Type of Wastewater:  Sewage  Industrial Process

Applicant: **H+H Const.**  
 Date Evaluated: **9/2-9/7 06**  
 Property Size:  
 Property Recorded:  
 Spring  Other  
 Pit  Cut  
 Mixed

P R O F I L E #	.1940 Landscape Position/ Slope%	Horizon Depth (IN.)	SOIL MORPHOLOGY .1941		OTHER PROFILE FACTORS				Profile Class & LTAR
			.1941 Structure/ Texture	.1941 Consistence Mineralogy	.1942 Soil Wetness/ Color	.1943 Soil Depth (IN.)	.1956 Sapro Class	.1944 Restr Horiz	
7	27	0-20	SL Gr	Fi NSNP					0.5 PS
		20-48	SCL SBK	Fi SSSP	104R 7/2 @ 42"				
8	27	0-18	SL Gr	Fi NSNP					0.5 PS
		18-44	SCL SBK	Fi SSSP					
9	2-37	0-16	SL Gr	Fi NSNP					0.5 PS
		16-42	SCL SBK	Fi SSSP					
10	27	0-8	SL Gr	Fi NSNP					0.5 PS
		8-26	SCL SBK	Fi SSSP	104R @ 22"				
11	27	0-22	SL Gr	Fi NSNP					0.5 PS
		22-36	SCL SBK	Fi SSSP	104R @ 34"				
12	2-37	0-20	SL Gr	Fi NSNP					0.5 PS
		20-40	SCL SBK	Fi SSSP	104R @ 35"				

Description	Initial System	Repair System
Available Space (.1945)	✓	✓
System Type(s)	Chamber 6ft x 6ft 12" cov. w/ 6" cover	
Site LTAR	0.5	0.5

Other Factors (.1946): \_\_\_\_\_  
 Site Classification (.1948): **PS**  
 Evaluated By: **WAC**  
 Others Present:

COMMENTS: \_\_\_\_\_  
 \_\_\_\_\_  
 \_\_\_\_\_

<u>LANDSCAPE POSITIONS</u>	<u>GROUP</u>	<u>TEXTURES</u>	<u>.1955 LTAR</u>	<u>CONSISTENCE MOIST</u>	<u>WET</u>
R-RIDGE	I	S-SAND	1.2 - 0.8	VFR-VERY FRIABLE FR-FRIABLE FI-FIRM VFI-VERY FIRM EFI-EXTREMELY FIRM	NS-NON-STICKY SS-SLIGHTLY STICKY S-STICKY VS-VERY STICKY NP-NON-PLASTIC SP-SLIGHTLY STICKY P-PLASTIC VP-VERY PLASTIC
S-SHOULDER SLOPE		LS-LOAMY SAND			
L-LINEAR SLOPE	II	SL-SANDY LOAM	0.8 - 0.6		
FS-FOOT SLOPE		L-LOAM			
N-NOSE SLOPE	III	SI-SILT-	0.6 - 0.3		
H-HEAD SLOPE		SIL-SILT LOAM			
CC-CONCLAVE SLOPE		CL-CLAY LOAM			
CV-CONVEX SLOPE		SCL-SANDY CLAY LOAM			
T-TERRACE	IV	SIC-SILTY CLAY	0.4 - 0.1		
FP-FLOOD PLAN		C-CLAY			
		SC-SANDY CLAY			

STRUCTURE  
 SG-SINGLE GRAIN  
 M-MASSIVE  
 CR-CRUMB  
 GR-GRANULAR  
 SBK-SUBANGULAR BLOCKY  
 ABK-ANGULAR BLOCKY  
 PL-PLATY  
 PR-PRISMATIC

MINERALOGY  
 SLIGHTLY EXPANSIVE  
 EXPANSIVE

Show profile locations and other site features (dimensions, reference or benchmark, and North).

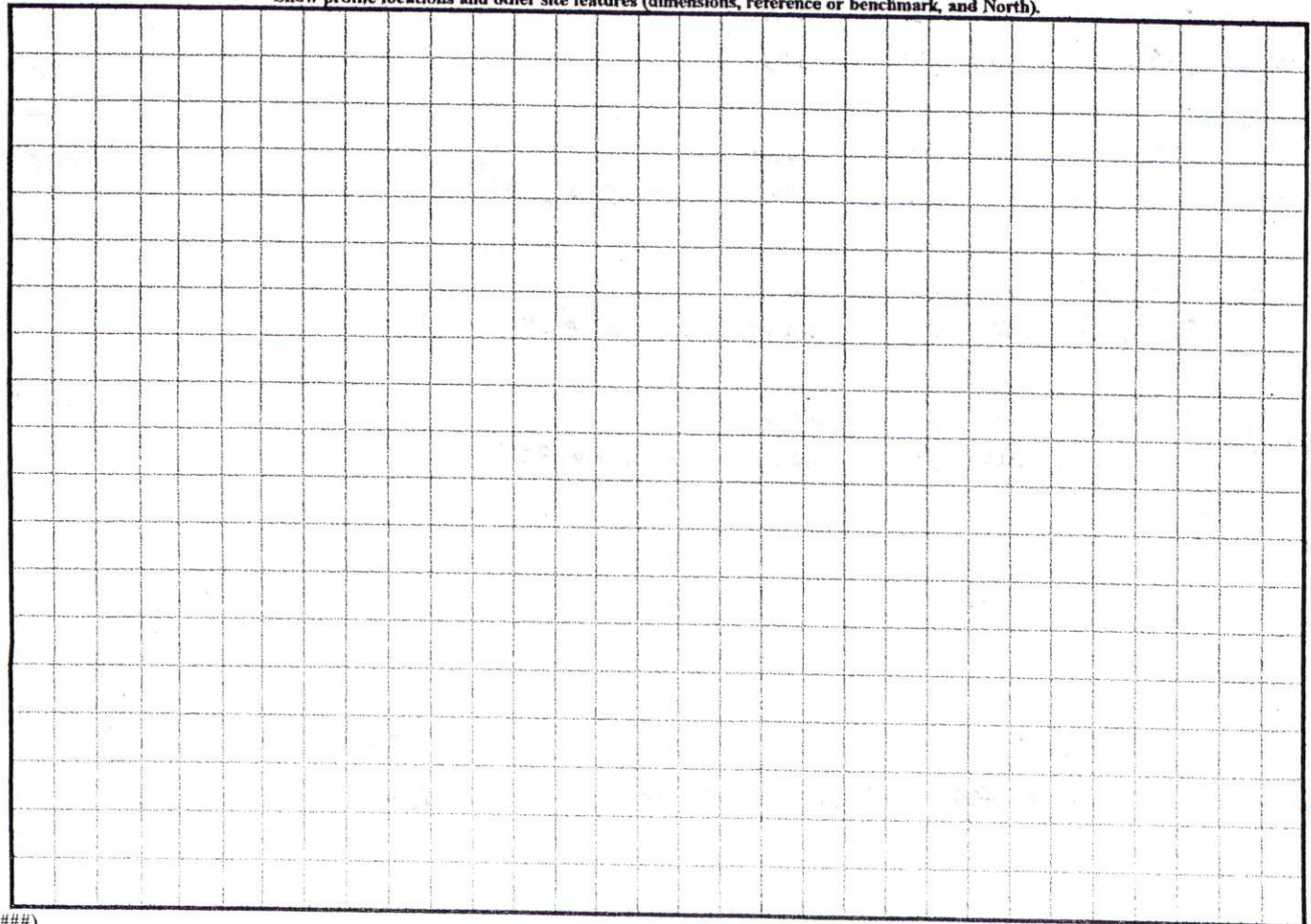



**SOIL/SITE EVALUATION  
 for ON-SITE WASTEWATER SYSTEM**

Owner:  
 Address:  
 Proposed Facility: **3BR**  
 Location of Site: **Lot 10L**  
 Water Supply:  Public  Individual  Well  
 Evaluation Method:  Auger Boring  Pit  
 Type of Wastewater:  Sewage  Industrial Process

Applicant: **H+H**  
 Date Evaluated: **9/2/06**  
 Property Size:  
 Property Recorded:  
 Spring  Other  
 Cut  
 Mixed

P R O F I L E #	.1940 Landscape Position/ Slope%	Horizon Depth (IN.)	SOIL MORPHOLOGY .1941				OTHER PROFILE FACTORS				Profile Class & LTAR
			.1941 Structure/ Texture	.1941 Consistence Mineralogy		.1942 Soil Wetness/ Color	.1943 Soil Depth (IN.)	.1956 Sapro Class	.1944 Restr Horiz		
1	3.5%	0-20	LS	Gr	Fr	NSNP					0.5 PS
		20-28	SL	Gr	Fr	NSNP					
		28-48	<del>SL</del> SCL	SBK	Fi	SSSP					
2	2.7%	0-24	LS	Gr	Fr	NSNP					0.4 PS
		24-48	SL	Gr	Fr	NSNP					
3	3.5%	0-20	LS	Gr	Fr	NSNP					0.5 PS
		20-28	SL	Gr	Fr	NSNP					
		28-32	SCL	SBK	Fi	SSSP					
		32-48	SL	Gr	Fr	NSNP					
4	3.5%	0-18	SL	Gr	Fr	NSNP					0.5 PS
		18-36	SCL	SBK	Fi	SSSP	104R 7/2 @ 32"				
5	3.5%	0-16	SL	Gr	Fr						0.5 PS
		16-24	SCL	SBK	Fi		104R 7/2 @ 26"				
6	3.5%	0-18	SL	Gr	Fr						0.5 PS
		18-40	SCL	SBK	Fi		104R 7/2 @ 26"				

Description	Initial System	Repair System
Available Space (.1945)	✓	✓
System Type(s)		12" conu. w/ 6" cover
Site LTAR	0.5	0.5

Other Factors (.1946):  
 Site Classification (.1948): **PS**  
 Evaluated By: **WHL**  
 Others Present:

Chamber system 6 ft dia Center



COMMENTS: Install swale around lot: Swale must be approved by Health Dept. before Installation can occur. Install swale @ property line to prevent surface water from washing away septic system. 15 ft setback from swale. (15 feet): 520 ft flagged out on-site. Must meet on site before installation. Stub out plumbing shallow or pump may need to be installed.

LANDSCAPE POSITIONS	GROUP	TEXTURES	.1955 LTAR	CONSISTENCE MOIST	WET
R-RIDGE	I	S-SAND	1.2 - 0.8	VFR-VERY FRIABLE	NS-NON-STICKY
S-SHOULDER SLOPE		LS-LOAMY SAND		FR-FRIABLE	
L-LINEAR SLOPE	II	SL-SANDY LOAM	0.8 - 0.6	FI-FIRM	SS-SLIGHTLY STICKY
FS-FOOT SLOPE		L-LOAM		VFI-VERY FIRM	
N-NOSE SLOPE				EFI-EXTREMELY FIRM	
H-HEAD SLOPE	III	SI-SILT-	0.6 - 0.3		NP-NON-PLASTIC
CC-CONCLAVE SLOPE		SIL-SILT LOAM			
CV-CONVEX SLOPE		CL-CLAY LOAM			
T-TERRACE		SCL-SANDY CLAY LOAM			
FP-FLOOD PLAN		SICL-SILTY CLAY LOAM			
	IV	SIC-SILTY CLAY	0.4 - 0.1		VP-VERY PLASTIC
		C-CLAY			
		SC-SANDY CLAY			

Notes

0.85 LTAR  
 Install 12-18"  
 System must have 6" cover  
 if shallower, than 18"  
 15ft setback from swale.  
 (Install 11 lines @ 240 ft.)  
 6 ft. on center Chamber system

STRUCTURE  
 SG-SINGLE GRAIN  
 M-MASSIVE  
 CR-CRUMB  
 GR-GRANULAR  
 SBK-SUBANGULAR BLOCKY  
 ABK-ANGULAR BLOCKY  
 PL-PLATY  
 PR-PRISMATIC

MINERALOGY  
 SLIGHTLY EXPANSIVE  
 EXPANSIVE

\* Approx 520 ft. flagged out  
 \* Serial distribution.

\* Will have to pump to repair  
 12" trench depth.

Show profile locations and other site features (dimensions, reference or benchmark, and North).

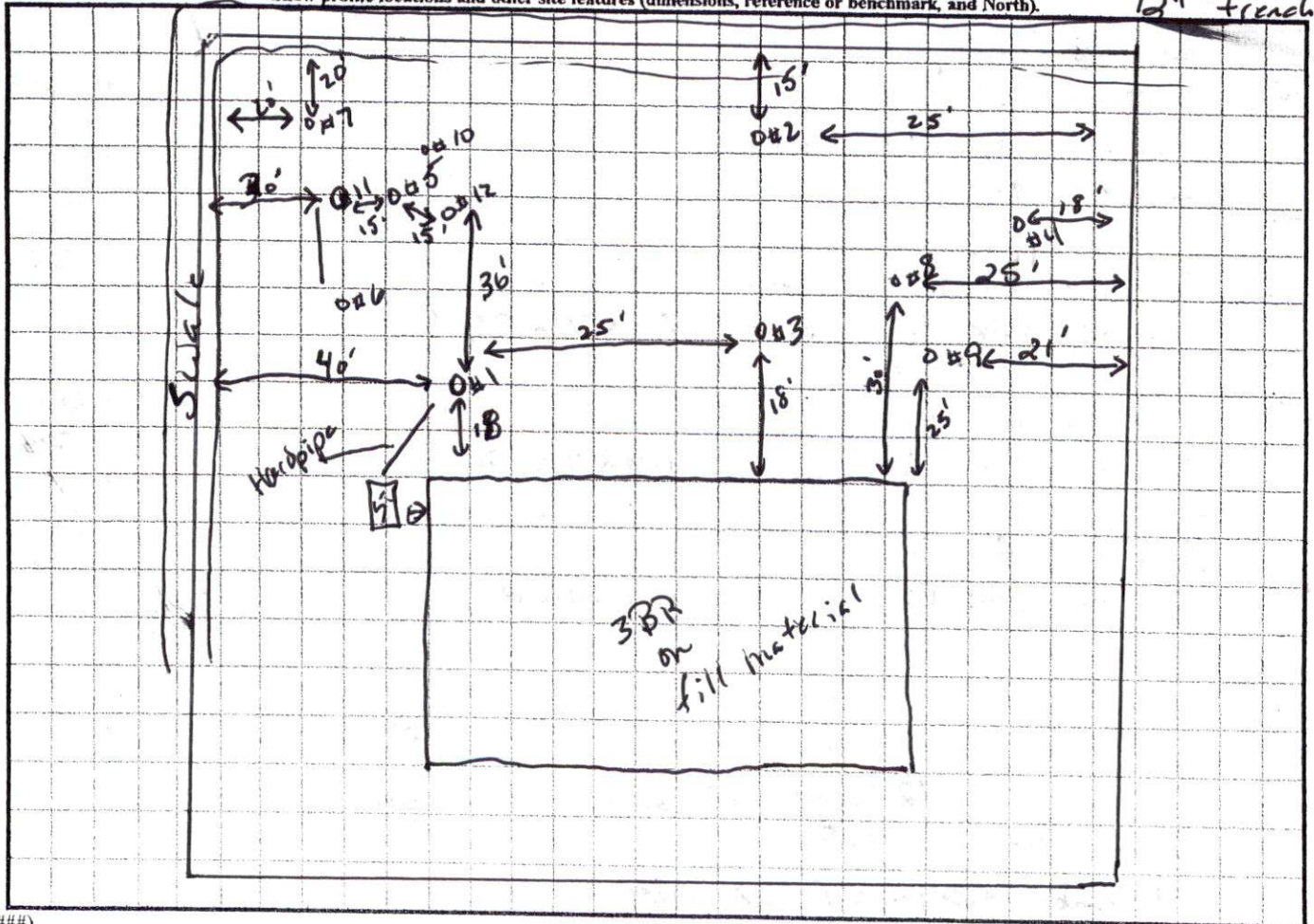

Pit 1 0-26 G S VFR NS/MP .4  
26-42" SBR/SL FR SS/SP 10YR 8/1 @ 29"

Pit 2 0-5 G LS  
5-25 SBR SCL SS NP VFR/FR white X .5  
25-43 SBR LS/PM VFR NS NP

Pit 3 0-11 G/LS VFR NS NP .4  
11-20 SBR/SL F: SS SP  
20-30 M/LS VFR NS NP  
30-52 PM

Washed ~~12~~ 12



1) ~~0-22~~ 22 SL G1 SSSP Fi  
 back 22-32 SCL SBK SP Fi  
 32-48" SCL/SBK SP Fi

28" check 25 & D-4  
 Other notes  
 back.

2) 0-12" SL G1 SSSP Fi  
 12-22 SCL SBK SP Fi  
 22-48" SCL SBK SP Fi  
 Parent material @ 28" Massion check 2" S ~~0-22~~ 0.4  
 28"

3) 0-20 SL G1 SSSP Fi  
 next 20-32 SCL SBK SP Fi  
 to 32-48 SCL/SBK SBK SP Fi/Fi  
 work

2" @ 28" = 0.4

Not enough iron  
 Massion 200-225 x 4  
 974 OC

Still need final  
 draw





### SOIL/SITE EVALUATION for ON-SITE WASTEWATER SYSTEM

Owner:

Applicant:

Address:

Date Evaluated:

Proposed Facility:

Design Flow (.1949):

Property Size:

Location of Site:

Property Recorded:

Water Supply:     Public     Individual     Well     Spring     Other

Evaluation Method:     Auger Boring     Pit     Cut

Type of Wastewater:     Sewage     Industrial Process     Mixed

P R O F I L E #	.1940 Landscape Position/ Slope%	Horizon Depth (IN.)	SOIL MORPHOLOGY .1941		OTHER PROFILE FACTORS				Profile Class & LTAR
			.1941 Structure/ Texture	.1941 Consistence Mineralogy	.1942 Soil Wetness/ Color	.1943 Soil Depth (IN.)	.1956 Sapro Class	.1944 Restr Horiz	
6	2-5%	0-18	SL						0.5 PS
		18-40	SCL			10YR 6/2R			
7	2-5%	0-20	SL						0.5 PS
		20-40	SCV						
55	2-5%	0-8	SL						0.5 PS
		8-24	SCL			11YR 5/2R			
8	8 2%	0-18	SL						0.5 PS
		18-44	SCL						
9	2% G	0-16	SL						0.5 PS
		16-42	SCL			10YR 7/2 R 40"			

Description	Initial System	Repair System
Available Space (.1945)		
System Type(s)		
Site LTAR		

Other Factors (.1946): \_\_\_\_\_

Site Classification (.1948): \_\_\_\_\_

Evaluated By: \_\_\_\_\_

Others Present: \_\_\_\_\_

COMMENTS: \_\_\_\_\_  
 \_\_\_\_\_  
 \_\_\_\_\_

LANDSCAPE POSITIONS	GROUP	TEXTURES	.1955 LTAR	CONSISTENCE MOIST	WET
R-RIDGE	I	S-SAND	1.2 - 0.8	VFR-VERY FRIABLE	NS-NON-STICKY
S-SHOULDER SLOPE		LS-LOAMY SAND			
L-LINEAR SLOPE	II	SL-SANDY LOAM	0.8 - 0.6	FR-FRIABLE	SS-SLIGHTLY STICKY
FS-FOOT SLOPE		L-LOAM		FI-FIRM	S-STICKY
N-NOSE SLOPE				VFI-VERY FIRM	VS-VERY STICKY
H-HEAD SLOPE	III	SI-SILT-	0.6 - 0.3	EFI-EXTREMELY FIRM	NP-NON-PLASTIC
CC-CONCLAVE SLOPE		SIL-SILT LOAM			SP-SLIGHTLY STICKY
CV-CONVEX SLOPE		CL-CLAY LOAM			P-PLASTIC
T-TERRACE		SCL-SANDY CLAY LOAM			VP-VERY PLASTIC
FP-FLOOD PLAN		SICL-SILTY CLAY LOAM			
	IV	SIC-SILTY CLAY	0.4 - 0.1		
		C-CLAY			
		SC-SANDY CLAY			

**STRUCTURE**  
 SG-SINGLE GRAIN  
 M-MASSIVE  
 CR-CRUMB  
 GR-GRANULAR  
 SBK-SUBANGULAR BLOCKY  
 ABK-ANGULAR BLOCKY  
 PL-PLATY  
 PR-PRISMATIC

**MINERALOGY**  
 SLIGHTLY EXPANSIVE  
 EXPANSIVE

*Handwritten notes:*  
 w/ 4 of back  
 60x65

Show profile locations and other site features (dimensions, reference or benchmark, and North).

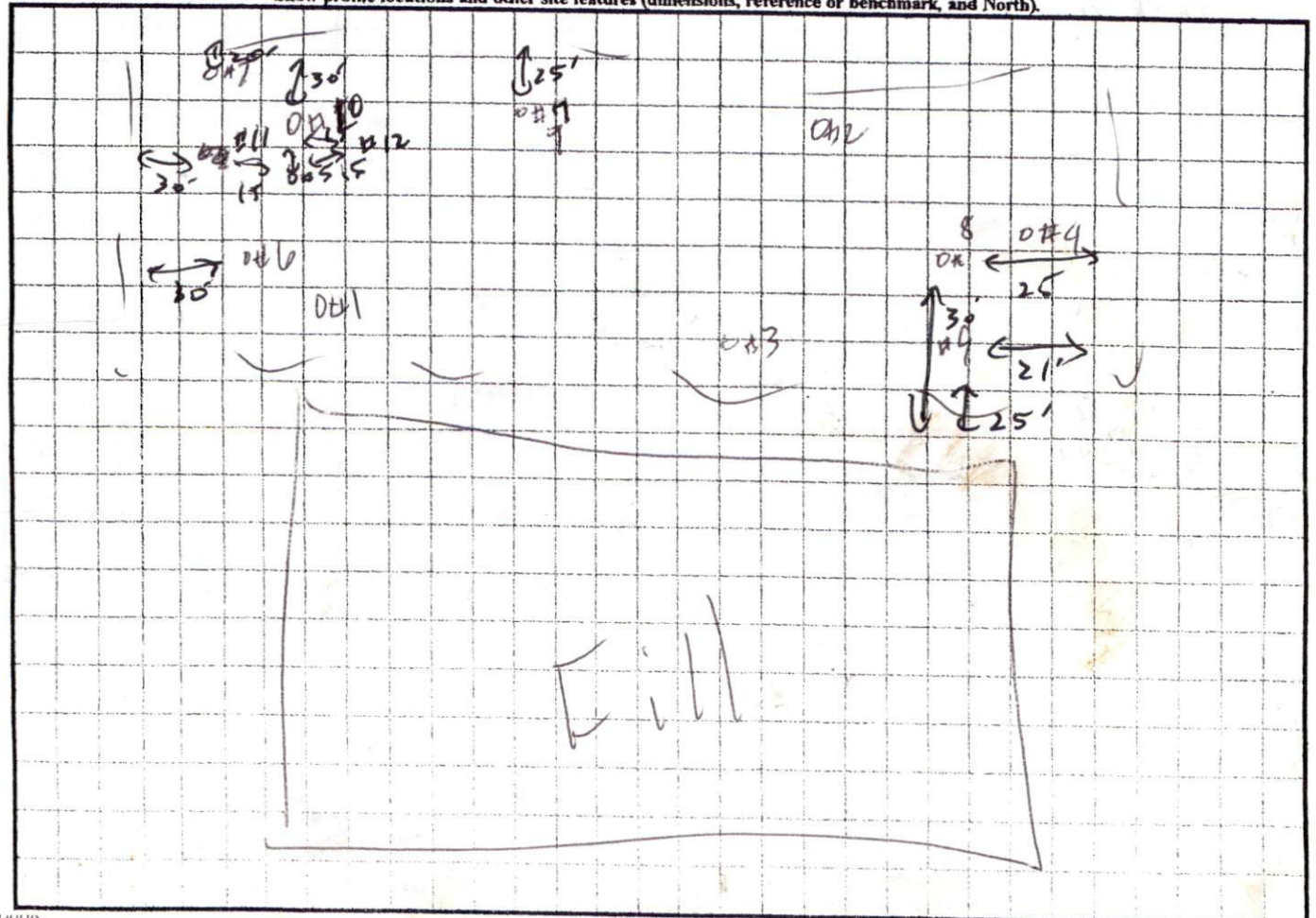



**SOIL/SITE EVALUATION**  
**for ON-SITE WASTEWATER SYSTEM**

Owner:  
 Address:  
 Proposed Facility: **3BR**  
 Location of Site:  
 Water Supply:  Public  Individual  Well  
 Evaluation Method:  Auger Boring  Pit  
 Type of Wastewater:  Sewage  Industrial Process

Applicant:  
 Date Evaluated: **102**  
 Property Size:  
 Property Recorded:  
 Spring  Other  
 Cut  
 Mixed

P R O F I L E #	.1940 Landscape Position/ Slope%	Horizon Depth (IN.)	SOIL MORPHOLOGY .1941				OTHER PROFILE FACTORS				Profile Class & LTAR
			.1941 Structure/ Texture	.1941 Consistence Mineralogy		.1942 Soil Wetness/ Color	.1943 Soil Depth (IN.)	.1956 Sapro Class	.1944 Restr Horiz		
1	3-5%	0-20	LS	Gr	Fr	NSNP				0.52 tar PF	
		20-28	SL	Gr	Fr	NSNP					
		28-48	SCL	SBC	Fr	SSP					
2	2-7%	0-24	LS/SL	Gr	Fr	NSNP				0.6 PS	
		24-48	SL	Gr	Fr	NSNP					
3	3-5%	0-20	LS	Gr	Fr	NSNP				0.5 PS	
		20-28	SL	Gr	Fr	NSNP					
		28-32	SCL	SBC	Fr	SSP					
		32-48	SL	Gr	Fr	NSNP					
4	3-5%	0-18	SL	Gr	Fr	NSNP				0.45 PS	
		18-32	SCL	SBC	Fr	SSP	104R 7/20 "32"				
5	3-5%	0-16	SL	Gr	Fr	NSNP				0.5 soil depth e" 26"	
		16-26	SCL	SBC	Fr	SSP	104R 7/20 "26"				

Description	Initial System	Repair System
Available Space (.1945)		
System Type(s)		
Site LTAR		

Other Factors (.1946):  
 Site Classification (.1948):  
 Evaluated By: **WMC**  
 Others Present:



COMMENTS: \_\_\_\_\_  
 \_\_\_\_\_  
 \_\_\_\_\_

LANDSCAPE POSITIONS	GROUP	TEXTURES	1955 LTAR	CONSISTENCE MOIST	WET
R-RIDGE	I	S-SAND	1.2 - 0.8	VFR-VERY FRIABLE	NS-NON-STICKY
S-SHOULDER SLOPE		LS-LOAMY SAND			
L-LINEAR SLOPE	II	SL-SANDY LOAM	0.8 - 0.6	FI-FIRM	SS-SLIGHTLY STICKY
FS-FOOT SLOPE		L-LOAM			
N-NOSE SLOPE					
H-HEAD SLOPE	III	SI-SILT-	0.6 - 0.3	VFI-VERY FIRM	VS-VERY STICKY
CC-CONCLAVE SLOPE		SIL-SILT LOAM			
CV-CONVEX SLOPE		CL-CLAY LOAM			
T-TERRACE		SCL-SANDY CLAY LOAM			
FP-FLOOD PLAN	IV	SIC-SILTY CLAY	0.4 - 0.1	EFI-EXTREMELY FIRM	NP-NON-PLASTIC
		C-CLAY			
		SC-SANDY CLAY			
		SICL-SILTY CLAY LOAM			SP-SLIGHTLY STICKY
					P-PLASTIC
					VP-VERY PLASTIC

**STRUCTURE**  
 SG-SINGLE GRAIN  
 M-MASSIVE  
 CR-CRUMB  
 GR-GRANULAR  
 SBK-SUBANGULAR BLOCKY  
 ABK-ANGULAR BLOCKY  
 PL-PLATY  
 PR-PRISMATIC

**MINERALOGY**  
 SLIGHTLY EXPANSIVE  
 EXPANSIVE

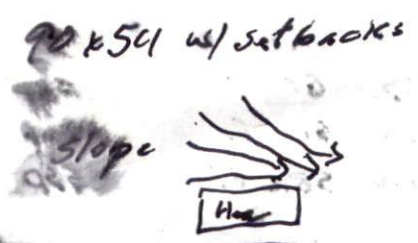

Show profile locations and other site features (dimensions, reference or benchmark, and North).

