

HTE 0650015039

IMPROVEMENT PERMIT

21784

Be it ordained by the Harnett County Board of Health as follows: Section III, Item B. "No Person shall begin construction of any building at which a septic tank system is to be used for disposal of sewage without first obtaining a written permit from the Harnett County Health Department."

Name: (owner) Woodshire Partners
Property Location: SR# 1125
New Installation [checked]
Septic Tank [checked]
Repairs [unchecked]
Nitrification Line [checked]

Subdivision Woodshire Lot # 102

Tax ID # \_\_\_\_\_ Quadrant # \_\_\_\_\_

Number of Bedrooms Proposed: 4BR (480 gal) Lot Size: .53 A

Basement with Plumbing: [unchecked] Garage: [unchecked]

Water Supply: [unchecked] Well [checked] Public [checked] Community [unchecked]

Distance From Well: 50 ft.

Following is the minimum specifications for sewage disposal system on above captioned property. Subject to final approval.

Type of system: [unchecked] Conventional [checked] Other 25% Reduction Required

Size of tank: Septic Tank: 1000 gallons Pump Tank: \_\_\_\_\_ gallons

Subsurface Drainage Field No. of ditches 1 exact length of each ditch 240 ft. width of ditches 3 ft. depth of ditches 18-24 in.

French Drain Required: \_\_\_\_\_ Linear feet

Date: 6/14/06

Signed: [Signature] Environmental Health Specialist

This permit is subject to revocation if site plans or intended use change.

- \* Maintain all setbacks
\* Install stepdowns as needed
\* Install lines on contour
\* Any questions, please call before installing

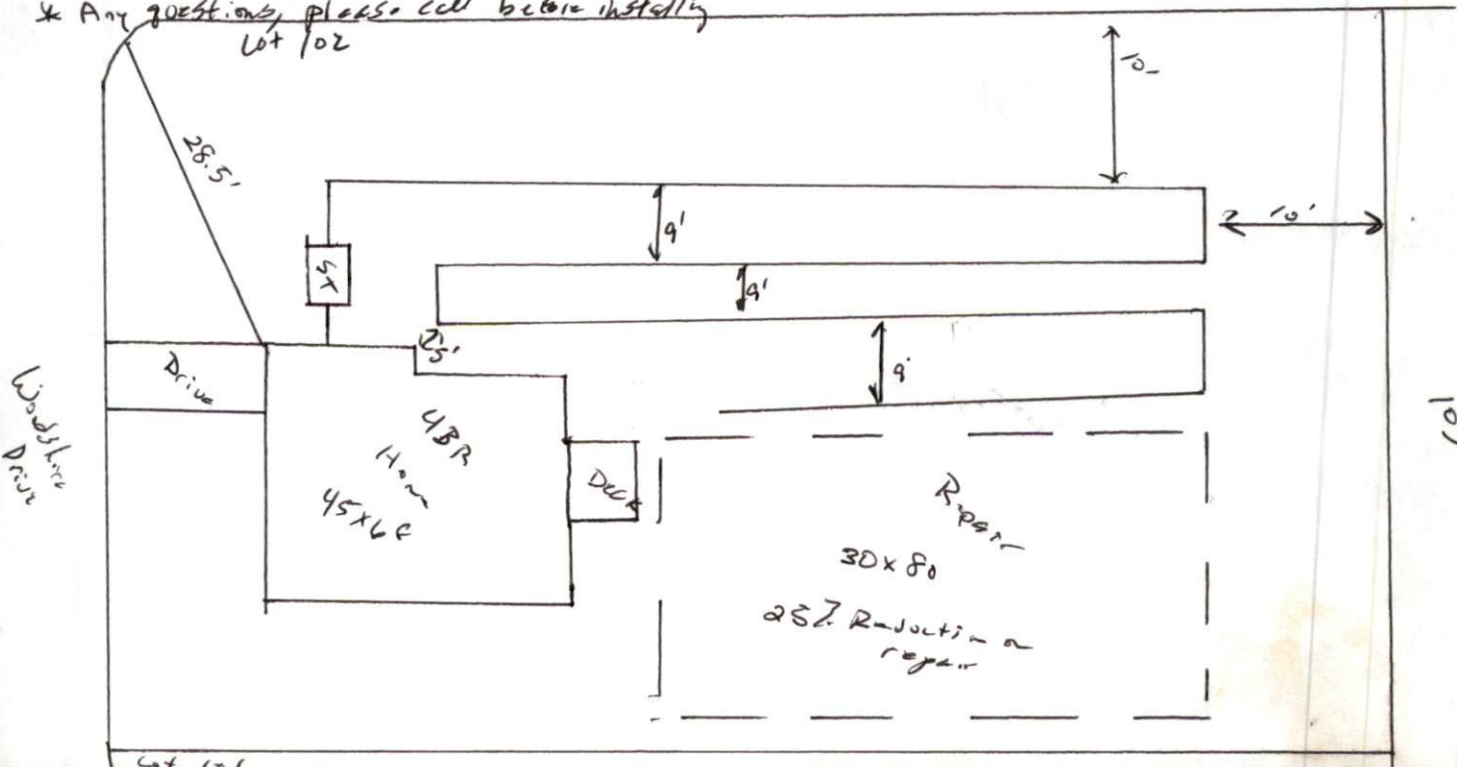

HARNETT COUNTY DEPARTMENT OF PUBLIC HEALTH  
AUTHORIZATION TO CONSTRUCT

Authorization is hereby given to construct a wastewater system to the specifications described by Harnett County Department of Public Health, Improvement Permit # 21784. This authorization shall be valid for a period not to exceed five (5) years from the date of issuance. *This authorization will be invalid if ownership, site plans, or intended use change.*

Woodshire Partners Name (910) 463-5353 Telephone #

1540 Purdue Pk Address

1125 Property Location SR# Lemuel Bluff Road Name

Woodshire Phase 4 102 Subdivision 4 BR (50 sq ft) Lot # # Bedrooms Proposed .53A Lot Size

**TYPE OF SYSTEM**

New Installation  Repair  Septic Tank  Nitrification Lines

Conventional  Other 25% Reduction

Basement  With Plumbing  Without Plumbing

Water Supply:  Well  Public Water Supply Minimum Well Setback: \_\_\_\_\_ Ft.

Septic Tank 1000 gal Pump Chamber \_\_\_\_\_ gal

**NITRIFICATION FIELD SPECIFICATIONS**

Number of fields 1 # of lines per field 1 Length of lines 240 Ft.

Width of ditches 3 ft. Depth of ditches 18-24 inches

French Drain: Linear feet required \_\_\_\_\_ Depth of gravel \_\_\_\_\_

No wastewater system shall be covered or placed into use by any person until an inspection by the Harnett County Health Department has determined that the system has been installed according to the conditions of the Improvement Permit and that a valid Operations Permit has been issued.

[Signature]  
Signature of Authorized Agent for Harnett County

6/14/06  
Date