

HTE # 06-5-14946R-Home ENVIRONMENTAL HEALTH SECTION

06-5-14961 Build

# OPERATIONS PERMIT

Name: (owner) LARRY THOMAS ELLIS  New Installation  Septic Tank  Repair

Property Location: SR# 1412 Christian Light  Nitrification Line  Expansion

Subdivision \_\_\_\_\_ Lot # 1 Tax ID # \_\_\_\_\_ Quadrant # \_\_\_\_\_

Contractor: Tommy Coley Registration # \_\_\_\_\_

Basement with Plumbing:  Garage:

Water Supply:  Well  Public  Community

Distance From Well: 50' ft.

Following are the specifications for the sewage disposal system on above captioned property.

Type of system:  Conventional  Other \_\_\_\_\_

Size of tank: Septic Tank: 1000 gallons Pump Tank: \_\_\_\_\_ gallons

Subsurface Drainage Field No. of ditches 4 exact length of each ditch 90 ft. width of ditches 3 ft. depth of ditches 22-3/8 in.

French Drain Required: - Linear feet Date: 8-15-06

PERMIT NO. 14350 Inspected by: James E. Markant

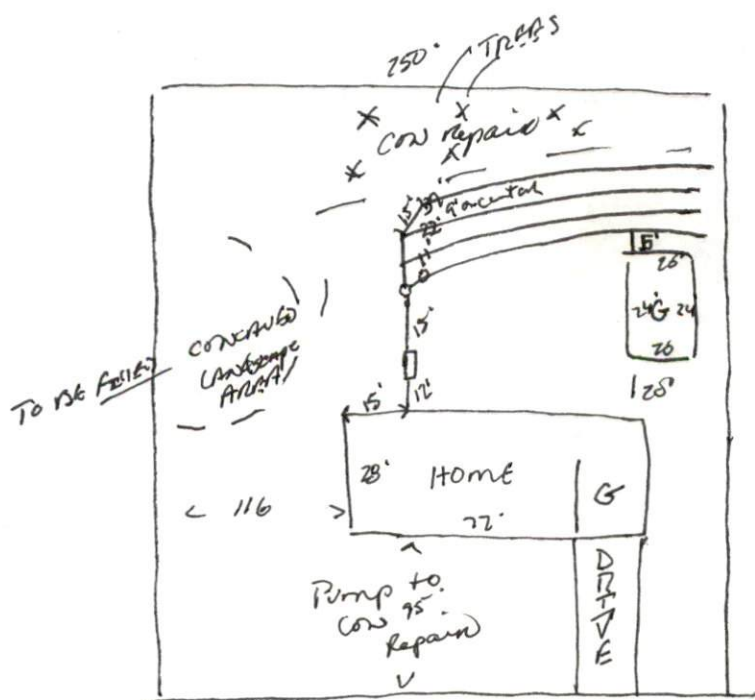

SR 1412 CHRISTIAN LIGHT