

HTE# 06-5-14861

# IMPROVEMENT PERMIT 22592

Be it ordained by the Harnett County Board of Health as follows: Section III, Item B. "No person shall begin construction of any building at which a septic tank system is to be used for disposal of sewage without first obtaining a written permit from the Harnett County Health Department."

Name: (owner) H&H Construction New Installation  Septic Tank  Repair   
 Property Location: SR# 1125 Lemuel Bluebell Nitrification Line  Expansion   
 Subdivision Woodshire - Phase Four Lot # 101  
 Tax ID# \_\_\_\_\_ Quadrant # \_\_\_\_\_  
 Number of Bedrooms Proposed: 3 (360 gpd) Lot Size: .54 Ac

Basement with Plumbing:  Garage:   
 Water Supply:  Well  Public  Community  
 Distance From Well: 50 ft.

**Following is the minimum specifications for sewage disposal system on above captioned property. Subject to final approval.**

Type of system:  Conventional  Other 25% Reduction System

Size of tank: Septic Tank: 1000 gallons Pump Tank: \_\_\_\_\_ gallons

Subsurface Drainage Field No. of ditches 1 exact length of each ditch 120 ft. width of ditches 3 ft. depth of ditches 18-24 in.

French Drain Required: 120 Linear feet

Date: 9/25/2006  
**PERMIT EXPIRES 5 YEARS FROM ABOVE DATE**

**This permit is subject to revocation if site plans or intended use change.**

Signed: Bryan McSwain P.E.  
 Environmental Health Specialist

- \* Maintain setbacks on permit
- \* Contractor to meet on-site prior to installing system
- \* French drain to be run above system to back property line then hard pipe can be used
- \* A well must be constructed to divert surface water away from system

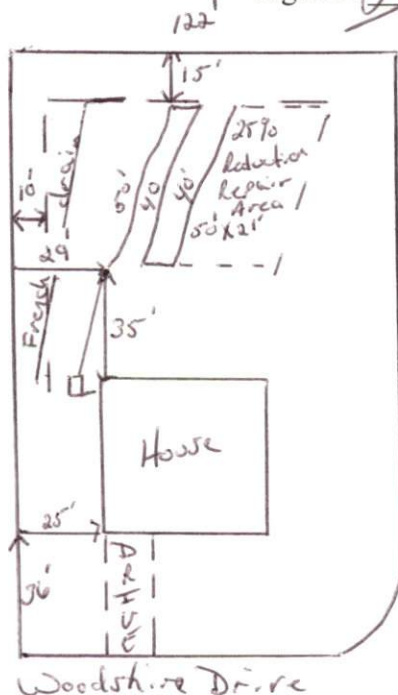

164'  
 1125'  
 5R

HARNETT COUNTY DEPARTMENT OF PUBLIC HEALTH  
AUTHORIZATION TO CONSTRUCT

Authorization is hereby given to construct a wastewater system to the specifications described by Harnett County Department of Public Health, Improvement Permit # 22592. This authorization shall be valid for a period not to exceed five (5) years from the date of issuance. ***This authorization will be invalid if ownership, site plans, or intended use change.***

H+H Construction 486-4864  
Name Telephone #

2919 Breezewood Ave. 400 Fayetteville, N.C. 28303  
Address

1125 Lemuel Black  
Property Location SR# Road Name

Woodshire 101 3 (300 gpd) .54 ac  
Subdivision Lot # # Bedrooms Proposed Lot Size

**TYPE OF SYSTEM**

New Installation  Repair  Septic Tank  Nitrification Lines

Conventional  Other 25% reduction system

Basement  With Plumbing  Without Plumbing

Water Supply:  Well  Public Water Supply Minimum Well Setback: 50 Ft.

Septic Tank 1000 gal Pump Chamber \_\_\_\_\_ gal

**NITRIFICATION FIELD SPECIFICATIONS**

Number of fields 1 # of lines per field 1 Length of lines 120 Ft.

Width of ditches 3 ft. Depth of ditches 18-24 inches

French Drain: Linear feet required 120 Depth of gravel 36-48"

No wastewater system shall be covered or placed into use by any person until an inspection by the Harnett County Health Department has determined that the system has been installed according to the conditions of the Improvement Permit and that a valid Operations Permit has been issued.

Bryan McSwain, R.S.  
Signature of Authorized Agent for Harnett County

9/25/2006  
Date