

HARNETT COUNTY HEALTH DEPARTMENT

HTE 0650014787

IMPROVEMENT PERMIT

21781

Be it ordained by the Harnett County Board of Health as follows: Section III, Item B. "No Person shall begin construction of any building at which a septic tank system is to be used for disposal of sewage without first obtaining a written permit from the Harnett County Health Department."

Name: (owner) Ballard Woods, LLC / Format Inc.  New Installation  Septic Tank  
Property Location: SR# 1437 Ballard Woods  Repairs  Nitrification Line

Subdivision Ballard Woods Ph 3 Lot # 5300 94

Tax ID # \_\_\_\_\_ Quadrant # \_\_\_\_\_

Number of Bedrooms Proposed: 3 (360gpd) Lot Size: .53 ac

Basement with Plumbing:  Garage:   
Water Supply:  Well  Public  Community  
Distance From Well: 100 ft.

Following is the minimum specifications for sewage disposal system on above captioned property. Subject to final approval.

Type of system:  Conventional  Other pump to 25% reduction

Size of tank: Septic Tank: 1000 gallons Pump Tank: 1000 gallons

Subsurface Drainage Field No. of ditches 1 exact length of each ditch 300 ft. width of ditches 3 ft. depth of ditches 12 in.

French Drain Required: \_\_\_\_\_ Linear feet

Date: 5-24-06

This permit is subject to revocation if site plans or intended use change.

Signed: Jamie Threlington RS  
Environmental Health Specialist

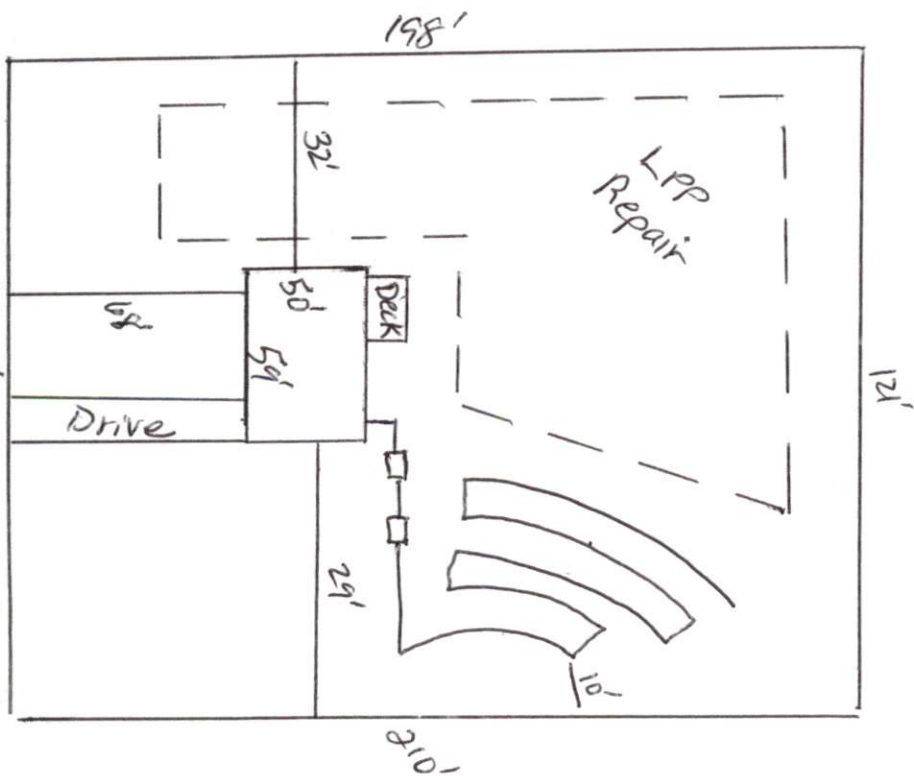

\* maintain all necessary setbacks.  
\* 6" of cover needed over system.

HARNETT COUNTY DEPARTMENT OF PUBLIC HEALTH  
AUTHORIZATION TO CONSTRUCT

Authorization is hereby given to construct a wastewater system to the specifications described by Harnett County Department of Public Health, Improvement Permit # 21781. This authorization shall be valid for a period not to exceed five (5) years from the date of issuance. *This authorization will be invalid if ownership, site plans, or intended use change.*

Format, Inc 919 427-2569  
Name Telephone #

2224 Page Rd Suite 108 Durham NC 27703  
Address

835 Ruth Circle  
Property Location SR# Road Name

Ballard Woods 94 3 (360 gpd) .53 ac  
Subdivision Lot # # Bedrooms Proposed Lot Size

**TYPE OF SYSTEM**

New Installation  Repair  Septic Tank  Nitrification Lines

Conventional  Other pump to 25% reduction

Basement  With Plumbing  Without Plumbing

Water Supply:  Well  Public Water Supply Minimum Well Setback: 100 Ft.

Septic Tank 1000 gal Pump Chamber 1000 gal

**NITRIFICATION FIELD SPECIFICATIONS**

Number of fields 1 # of lines per field 1 Length of lines 300 Ft.

Width of ditches 3 ft. Depth of ditches 12 inches

French Drain: Linear feet required \_\_\_\_\_ Depth of gravel \_\_\_\_\_

No wastewater system shall be covered or placed into use by any person until an inspection by the Harnett County Health Department has determined that the system has been installed according to the conditions of the Improvement Permit and that a valid Operations Permit has been issued.

Jamie Turlington  
Signature of Authorized Agent for Harnett County

5-24-06  
Date