

IMPROVEMENT PERMIT

Be it ordained by the Harnett County Board of Health as follows: Section III, Item B. "No Person shall begin construction of any building at which a septic tank system is to be used for disposal of sewage without first obtaining a written permit from the Harnett County Health Department."

Name: (owner) Comfort Homes

New Installation Septic Tank

Property Location: SR# 1412 Chris Pine Light

Repairs Nitrification Line

Subdivision Forest Trails Lot # 61

Tax ID # _____ Quadrant # _____

Number of Bedrooms Proposed: 3 BR 360 GPD Lot Size: r462

Basement with Plumbing: Garage:

Water Supply: Well Public Community

Distance From Well: 50' ft.

Following is the minimum specifications for sewage disposal system on above captioned property. Subject to final approval.

Type of system: Conventional Other Manatee Pump to 25% Reduction System

Size of tank: Septic Tank: 1000 gallons Pump Tank: 1000 gallons

Subsurface Drainage Field No. of ditches 5 exact length of each ditch 60 ft. width of ditches 3 ft. depth of ditches 20-28 in.

French Drain Required: - Linear feet

Date: 6-14-06

This permit is subject to revocation if site plans or intended use change.

Signed: James E. Markland
Environmental Health Specialist

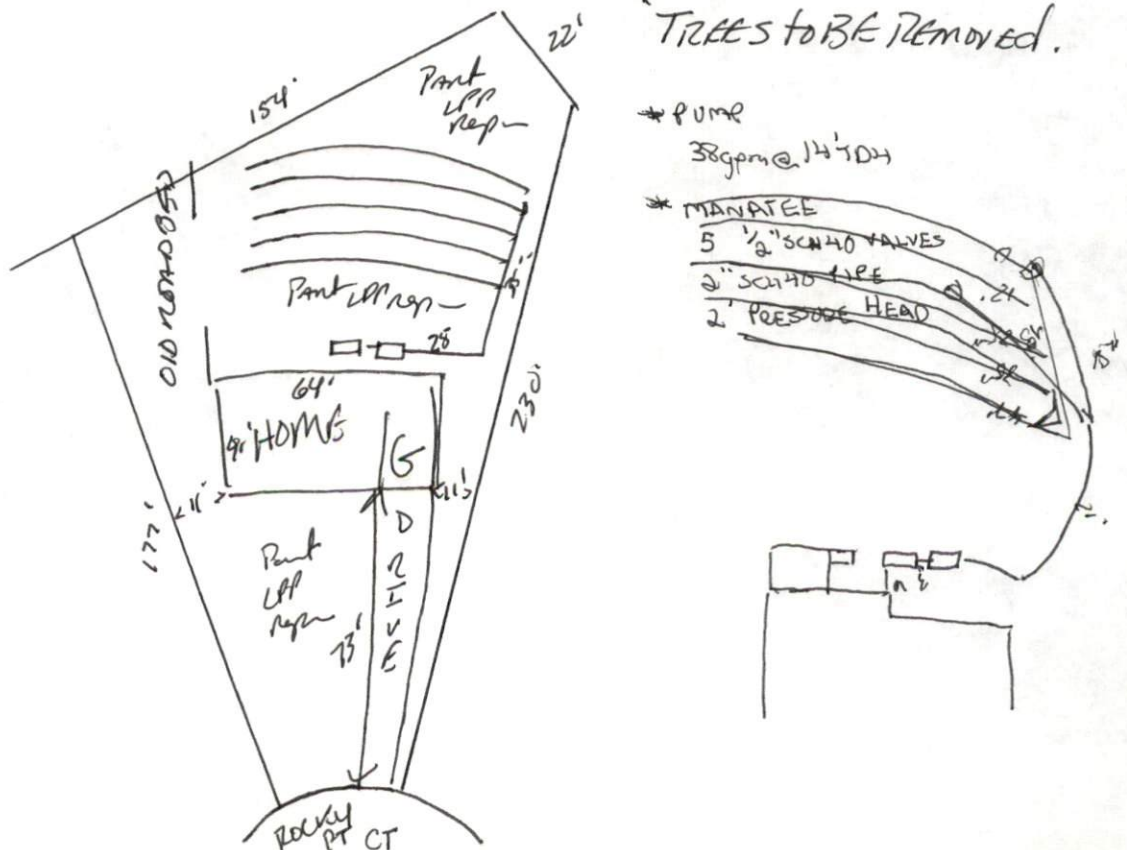

HARNETT COUNTY DEPARTMENT OF PUBLIC HEALTH AUTHORIZATION TO CONSTRUCT

Authorization is hereby given to construct a wastewater system to the specifications described by Harnett County Department of Public Health, Improvement Permit # 14335. This authorization shall be valid for a period not to exceed five (5) years from the date of issuance. ***This authorization will be invalid if ownership, site plans, or intended use change.***

Comfort Homes Name 919-553-3242 Telephone #

P.O. Box 369 Clayton N.C. 27528 Address

1412 Property Location SR# Christian Light Road Name

Forest Trails Subdivision 66 Lot # 3BR 300 GPD # Bedrooms Proposed 462 Lot Size

TYPE OF SYSTEM

New Installation Repair Septic Tank Nitrification Lines

Conventional Other Run to Manette 2590 Reduction System

Basement With Plumbing Without Plumbing

Water Supply: Well Public Water Supply Minimum Well Setback: _____ Ft.

Septic Tank 1000 gal Pump Chamber 1000 gal

NITRIFICATION FIELD SPECIFICATIONS

Number of fields 2 # of lines per field 5 Length of lines 60 Ft.

Width of ditches 3 ft. Depth of ditches 20-218 inches

French Drain: Linear feet required - Depth of gravel -

No wastewater system shall be covered or placed into use by any person until an inspection by the Harnett County Health Department has determined that the system has been installed according to the conditions of the Improvement Permit and that a valid Operations Permit has been issued.

James E. Mankin
Signature of Authorized Agent for Harnett County

6-14-06
Date