

HTE# 00-50014638

IMPROVEMENT PERMIT 23018

Be it ordained by the Harnett County Board of Health as follows: Section III, Item B. "No person shall begin construction of any building at which a septic tank system is to be used for disposal of sewage without first obtaining a written permit from the Harnett County Health Department."

Name: (owner) CAVINUS Land Dev. New Installation Septic Tank Repair

Property Location: SR# 1125 Nitrification Line Expansion

Subdivision Woodshire Lot # 112

Tax ID# _____ Quadrant # _____

Number of Bedrooms Proposed: 4 (50x60) 480 sqft Lot Size: .37 Ac

Basement with Plumbing: Garage:

Water Supply: Well Public Community

Distance From Well: 50 ft.

Following is the minimum specifications for sewage disposal system on above captioned property. Subject to final approval.

Type of system: Conventional Other 25% Reduction SYSTEM

Size of tank: Septic Tank: 1000 gallons Pump Tank: _____ gallons

Subsurface No. of exact length width of depth of
Drainage Field ditches 2 ft. of each ditch 110 ft. ditches 3 ft. ditches 18.24 in.

French Drain Required: _____ Linear feet 125% Reduction system

Date: 5.26.06

This permit is subject to revocation if site plans or intended use change.

PERMIT EXPIRES 5 YEARS FROM ABOVE DATE

Signed: [Signature]
Environmental Health Specialist

*Meet onsite
MAINTAIN All set backs,
STUB out Plumbing shallow
At ground level or higher*

*Road
98*

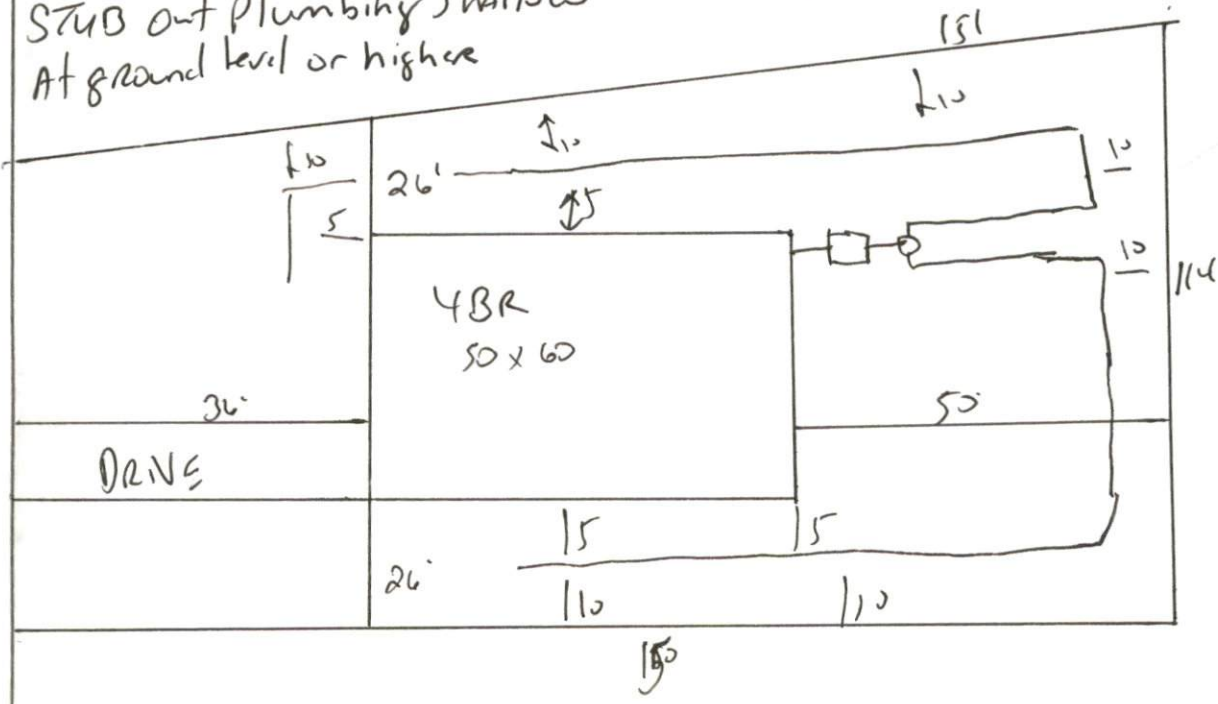

HARNETT COUNTY DEPARTMENT OF PUBLIC HEALTH
AUTHORIZATION TO CONSTRUCT

Authorization is hereby given to construct a wastewater system to the specifications described by Harnett County Department of Public Health, Improvement Permit # 23018. This authorization shall be valid for a period not to exceed five (5) years from the date of issuance. *This authorization will be invalid if ownership, site plans, or intended use change.*

Campus Land
Name _____ Telephone # _____

Address _____

1125
Property Location SR# _____ Road Name _____
Woodshire 112 4(50x60) 430 gpd 37 ac
Subdivision Lot # # Bedrooms Proposed Lot Size

TYPE OF SYSTEM

New Installation [] Repair Septic Tank Nitrification Lines
[] Conventional Other 25% Reduction SYSTEM
[] Basement [] With Plumbing [] Without Plumbing

Water Supply: [] Well Public Water Supply Minimum Well Setback: 50 Ft.
Septic Tank 1000 gal Pump Chamber _____ gal

NITRIFICATION FIELD SPECIFICATIONS

Number of fields 1 # of lines per field 2 Length of lines 110 Ft.
Width of ditches 3 ft. Depth of ditches 18.24 inches OF 25% Reduction SYSTEM
French Drain: Linear feet required _____ Depth of gravel _____

No wastewater system shall be covered or placed into use by any person until an inspection by the Harnett County Health Department has determined that the system has been installed according to the conditions of the Improvement Permit and that a valid Operations Permit has been issued.

Joe West RS _____ 5-26-06
Signature of Authorized Agent for Harnett County Date