

HTE# 0650014629

IMPROVEMENT PERMIT 22938

Be it ordained by the Harnett County Board of Health as follows: Section III, Item B. "No person shall begin construction of any building at which a septic tank system is to be used for disposal of sewage without first obtaining a written permit from the Harnett County Health Department."

Name: (owner) Holt Cont. New Installation Septic Tank Repair
 Property Location: SR# 1125 Nitrification Line Expansion
 Subdivision FOREST DAKES Lot # 97
 Tax ID# _____ Quadrant # _____
 Number of Bedrooms Proposed: 4 (48 x 46) 480 sqd Lot Size: 0.44 AC

Basement with Plumbing: Garage:
 Water Supply: Well Public Community
 Distance From Well: 50 ft.

Following is the minimum specifications for sewage disposal system on above captioned property. Subject to final approval.

Type of system: Conventional Other 25% Reduction SYSTEM

Size of tank: Septic Tank: 1000 gallons Pump Tank: _____ gallons

Subsurface No. of exact length width of depth of
 Drainage Field ditches 1 ft. of each ditch 210 ft. ditches 3 ft. ditches 18-24 in.

French Drain Required: _____ Linear feet 425% Reduction system
 Date: 05-09-06

This permit is subject to revocation if site plans or intended use change. PERMIT EXPIRES 5 YEARS FROM ABOVE DATE

STUB out Plumbing shallow Where shown
 Signed: [Signature] Environmental Health Specialist

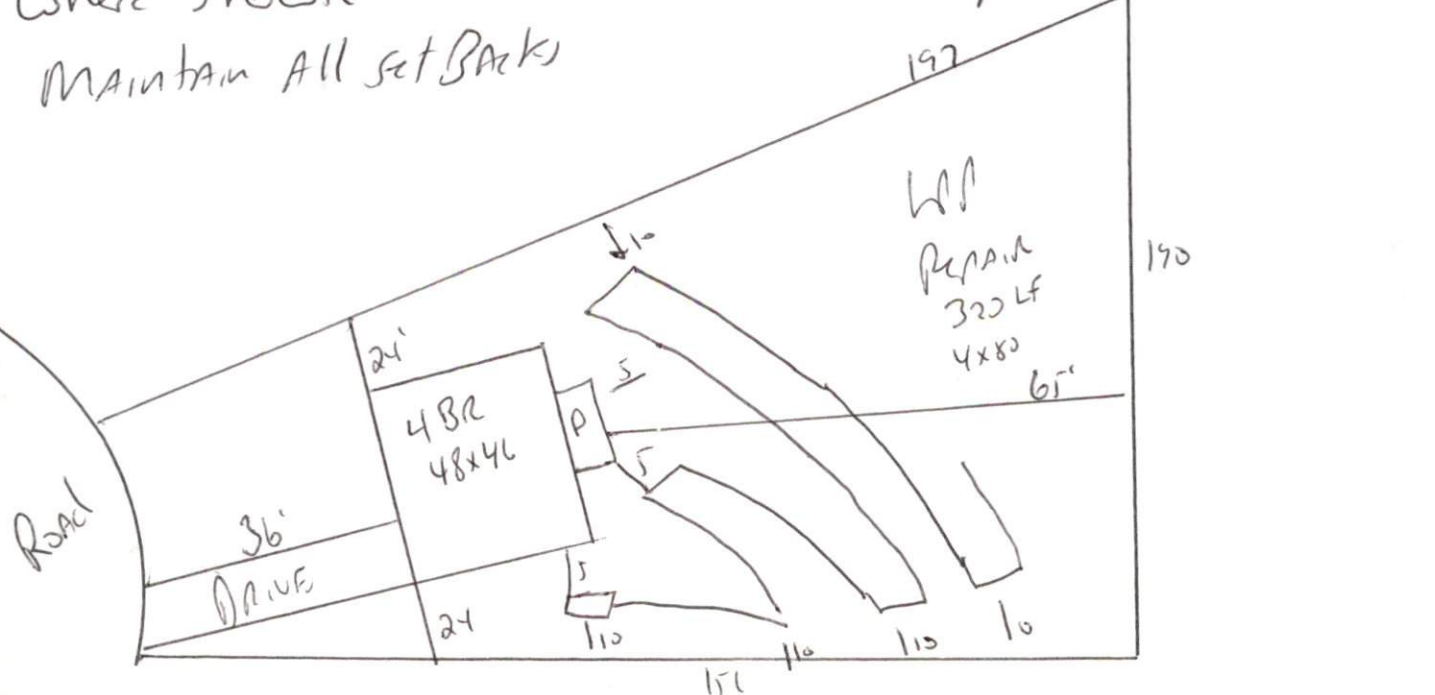

HARNETT COUNTY DEPARTMENT OF PUBLIC HEALTH
A
HORIZATION TO CONSTRUCT

Authorization is hereby given to construct a wastewater system to the specifications described by Harnett County Department of Public Health, Improvement Permit # 22738. This authorization shall be valid for a period not to exceed five (5) years from the date of issuance. *This authorization will be invalid if ownership, site plans, or intended use change.*

HH Const.

Name

Telephone #

Address

1125

Property Location SR#

Road Name

Forest Oaks

97

4(48x46) 4808pd

.44ac

Subdivision

Lot #

Bedrooms Proposed

Lot Size

TYPE OF SYSTEM

New Installation [] Repair Septic Tank Nitrification Lines

[] Conventional Other 25% Reduction SYSTEM

[] Basement [] With Plumbing [] Without Plumbing

Water Supply: [] Well Public Water Supply Minimum Well Setback: 50 Ft.

Septic Tank 1000 gal Pump Chamber _____ gal

NITRIFICATION FIELD SPECIFICATIONS

Number of fields 1 # of lines per field 1 Length of lines 210 Ft.

Width of ditches 3 ft. Depth of ditches 18 1/2 inches

OF 25% Reduction SYSTEM

French Drain: Linear feet required _____ Depth of gravel _____

No wastewater system shall be covered or placed into use by any person until an inspection by the Harnett County Health Department has determined that the system has been installed according to the conditions of the Improvement Permit and that a valid Operations Permit has been issued.

Joe West RS

Signature of Authorized Agent for Harnett County

05-09-06

Date